

REVISIONS

P	LTR	DESCRIPTION	DATE	DWN	APVD
	F	ECR-09-007414	02JUN2009	KG	DW
	F1	ECR-16-015298	07NOV2016	KG	DW
	G	ECR-17-014341	24OCT2017	KG	DW
	G1	ECR-17-017934	12DEC2017	KG	DW

1. USE WITH FERRULE ASSEMBLY KIT P/N 1588908-1 OR P/N 1588700-1.
QUANTITY OF 2 REQUIRED.

2. PROTECTIVE LABEL APPLIED AFTER FINAL CLEAN ROOM TEST TO PREVENT OPTICAL CAVITY CONTAMINATION. REMOVE ONLY WHEN READY TO ASSEMBLE.

3. MULTIMODE IDENTIFIER.

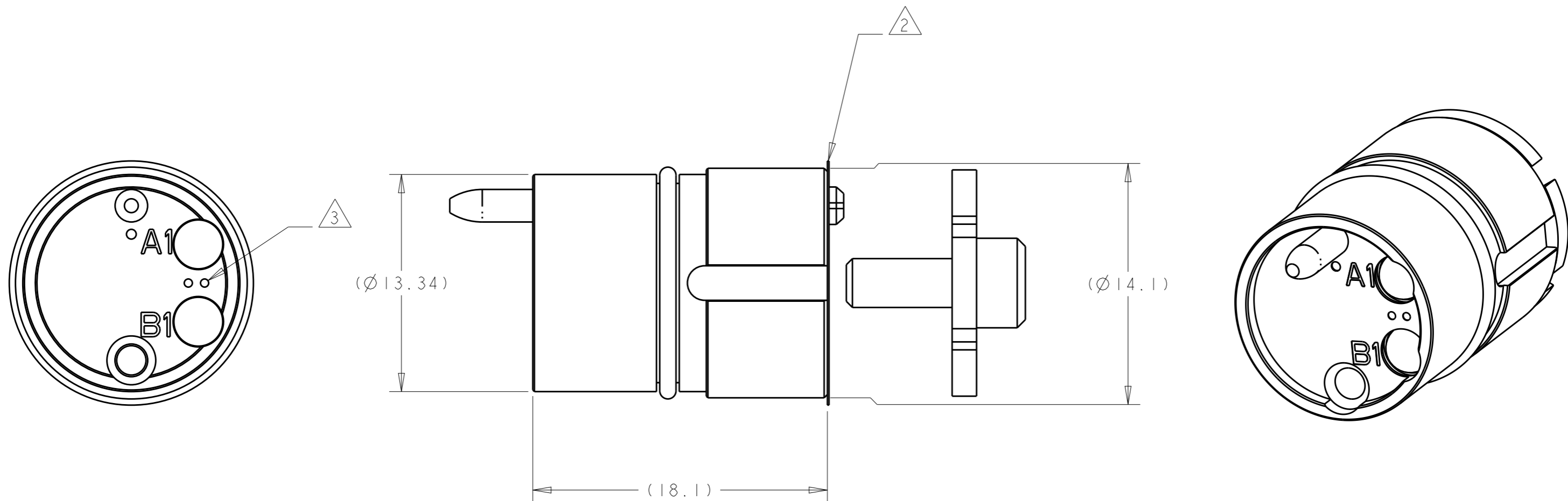

2 CHANNEL, 850/1300nm MM	1515743-1
DESCRIPTION	PART NO.

THIS DRAWING IS A CONTROLLED DOCUMENT.		DWN E. HOPKINS 08OCT2002	TE Connectivity	
DIMENSIONS: mm		CHK D. WERTMAN 08OCT2002		
TOLERANCES UNLESS OTHERWISE SPECIFIED:		APVD D. WERTMAN 08OCT2002	NAME INSERT ASSEMBLY, PRO BEAM JR., 2 CHANNEL, 850/1300nm MM	
0 PLC ±. 1 PLC ±. 2 PLC ±. 3 PLC ±. 4 PLC ±. ANGLES ±2		PRODUCT SPEC -	SIZE A3	
MATERIAL STAINLESS ALLOYS & NBR		FINISH N/A	APPLICATION SPEC -	CAGE CODE 00779
		WEIGHT -	DRAWING NO 1515743	RESTRICTED TO -
CUSTOMER DRAWING			SCALE 4:1	SHEET 1 OF 1
			REV G1	