

**MULTIMODE DUPLEX ADAPTOR – ZIRCONIA SLEEVE
ALIGNEMENT**

 Series
SC

 Packaging
100

 Issue
30-12-2010

 Page
1/1

Original dimensions in mm [inch]

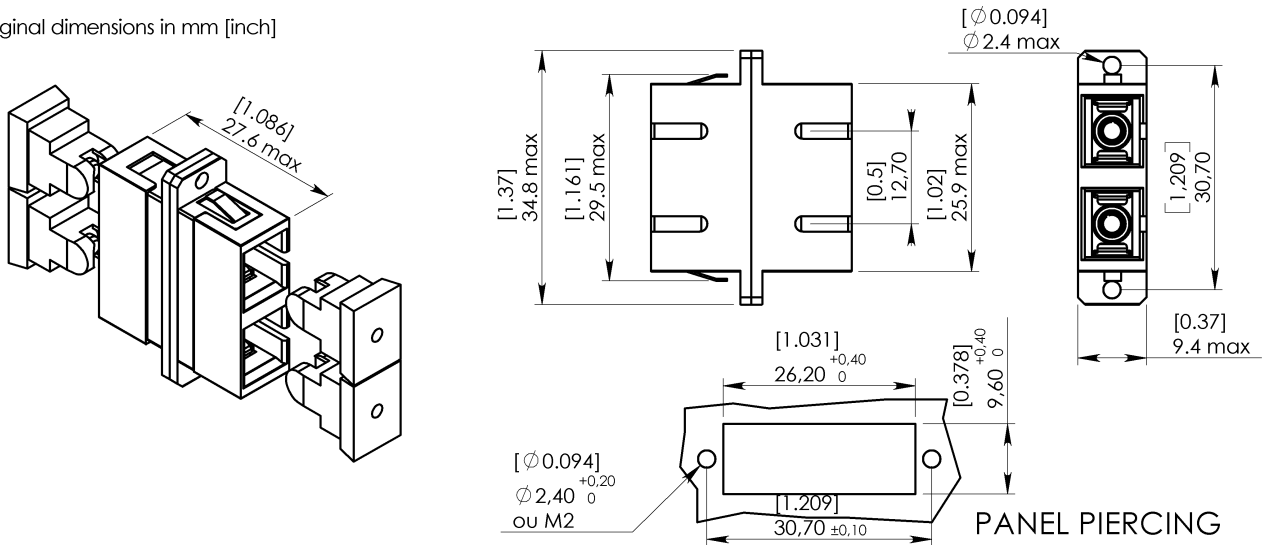
GENERAL

- Type :** IEC 60874-19 SC type. Push pull latching system
Body color : AQUA
- Mounting :** Snap-in (or screw-in) mounting max. panel thickness 1.6 mm
- Alignment sleeve :** Zirconia

CHARACTERISTICS *(Dependant on fiber or cable construction)*

- Material : Plastic moulded** Material in accordance with BELLCORE GR 326 CORE Issue 2, par.3.3.1
Inflammability V1 (UL94)
Stainless steel
- Clip**
- Optical :** Attenuation (according to IEC 61300-3-4:Substitution method, 7 type) at 1310nm :
0.02 dB Max / 0.01 dB Typ
- Mechanical : Durability** Bellcore 326, 500 cycles
Plug Retention > 68 N
- Environmental : Temperature range (storage/operating)** -40°C to +85°C
- Salt spray :** EIA/TIA -455-16A, 35°C, 168 hr.
- Vibration test :** Bellcore 326, 10 to 50 Hz, 2 hrs./axis
- Proof test :** Bellcore 326, Straight pull : 6.8 Kg load at 0°
Side pull : 3.5 Kg load at 90°

CREATION

 PEN/EP EPM 1005
Name: S.P
Date: dec, 30 2010
Appr.: H.D

Issue

Revisions

Name

Appr.

RADIALL[®]

 101, rue P. Hoffmann
93116 ROSNY/BOIS
FRANCE
Tel : (33) 0149353535
Fax : (33) 0148546363