

SEE NOTE 6

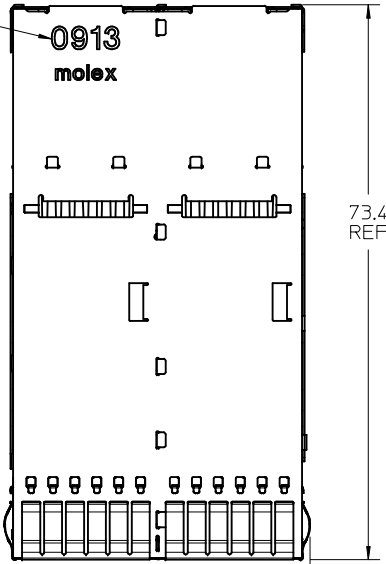

NOTES:

1. MATERIAL:

CAGE: NICKEL SILVER, 0.25 THICK
EMI SPRINGS: PHOS-BRONZE, 0.08 THICK
LIGHT PIPES: POLYCARBONATE, 94V-0 (OPTIONAL)
CONNECTOR HOUSING: HIGH PERFORMANCE THERMOPLASTIC, 94V-0
TERMINALS: HIGH PERFORMANCE COPPER ALLOY, 0.18 THICK

2. FINISH:

EMI SPRINGS: 100µm NICKEL OVERALL
TERMINALS: CONTACT AREA: 0.76µm MIN GOLD OVER
2.5µm MIN NICKEL.
COMPLIANT AREA: 0.76-1.52µm MATTE TIN
OVER 1.27µm MIN NICKEL.

3. ALL SURFACES TO BE CLASS 'C' OR BETTER PER MOLEX COSMETIC SPECIFICATION PS-45499-002.

4. REFER TO PK-76871-9001 FOR ALL PACKAGING SPECIFICATIONS.

5. CONNECTOR INTENDED TO MATE WITH PLUG CABLE SERIES 74757 AND 74758.

6. DATE CODE LOCATION SHOWN, DATE CODE FORMAT: DDD Y
DDD = DAY OF THE YEAR, Y = YEAR.

FRONT PLATE OPTIONS

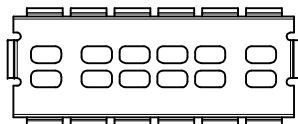

P/N 171722-2101
AIRFLOW ONLY
NO LIGHTPIPE

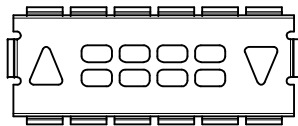

P/N 171722-2102
UP/DOWN LIGHTPIPE INDICATOR

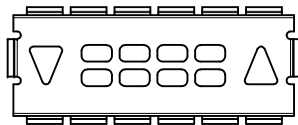

P/N 171722-2103
DOWN/UP LIGHTPIPE INDICATOR

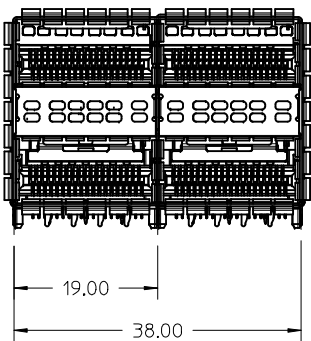

1.1^{+0.5}_{-0.1} (2X)
FROM CAGE BODY

1.1^{+0.5}_{-0.1} (2X)
FROM CAGE BODY

24.90 ± 0.20
CAGE BODY

25.40

12.1
REF

2.1
CAGE PIN LENGTH

2.5
PEG LENGTH

1.2
SIGNAL TAILS

ADD SPRING HEIGHT EC NO: UCP2015-2796 DRWN: JKACHLIC 2015/10/01 CHKD: MBANAKIS 2015/10/02 APPR: MBANAKIS 2015/10/02	QUALITY SYMBOLS	GENERAL TOLERANCES (UNLESS SPECIFIED)		DIMENSION STYLE	SCALE	DESIGN UNITS	THIRD ANGLE PROJECTION
	▽=0	mm	INCH	MM ONLY	2:1	METRIC	
	▽=0	4 PLACES ± ---	± ---	DRAWN BY	DATE	TITLE	
	▽=0	3 PLACES ± ---	± ---	JKACHLIC	2013/07/11	STACKED QSFP+ 2X2 CONN W/METAL EMI GASKET FOR 3X STACKING ONLY	
		2 PLACES ± 0.13	± ---	CHECKED BY	DATE		
		1 PLACE ± 0.25	± ---	APPROVED BY	DATE		
		0 PLACE ± ---	± ---	MBANAKIS	2013/07/15		
		ANGULAR ±1/2°		MATERIAL NO.	DOCUMENT NO.		
		DRAFT WHERE APPLICABLE MUST REMAIN WITHIN DIMENSIONS		SEE OPTIONS	SD-171722-2100		
				SIZE	THIS DRAWING CONTAINS INFORMATION THAT IS PROPRIETARY TO MOLEX INCORPORATED AND SHOULD NOT BE USED WITHOUT WRITTEN PERMISSION		SHEET NO. 1 OF 3

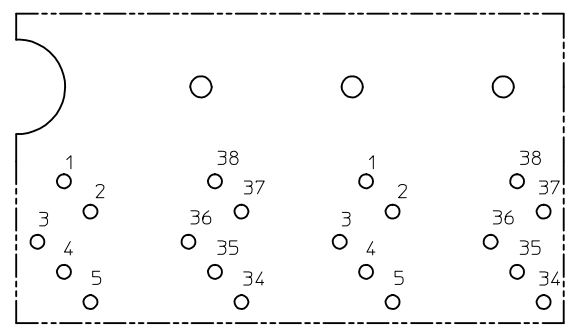

LOWER PORT UPPER PORT

DETAIL 3
PIN ASSIGNMENTS

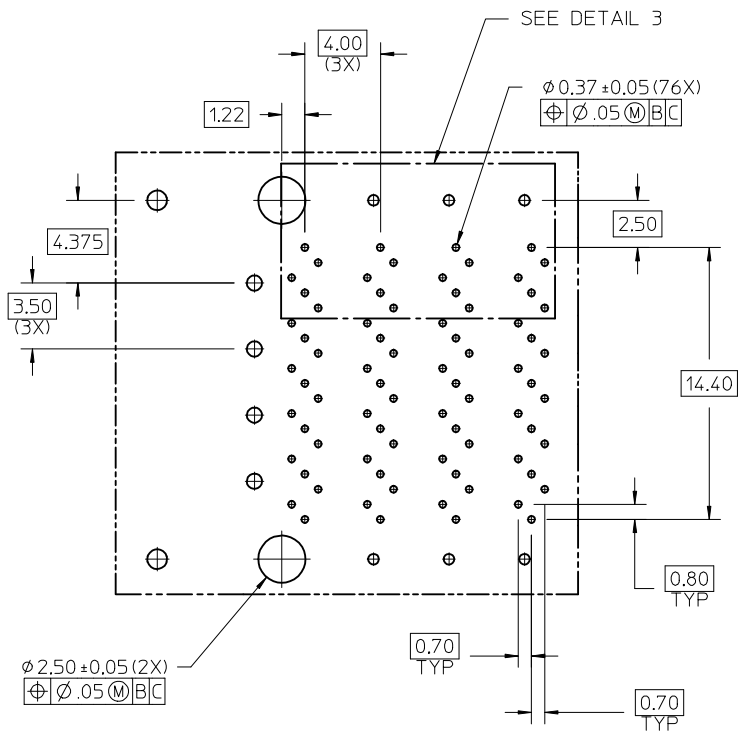
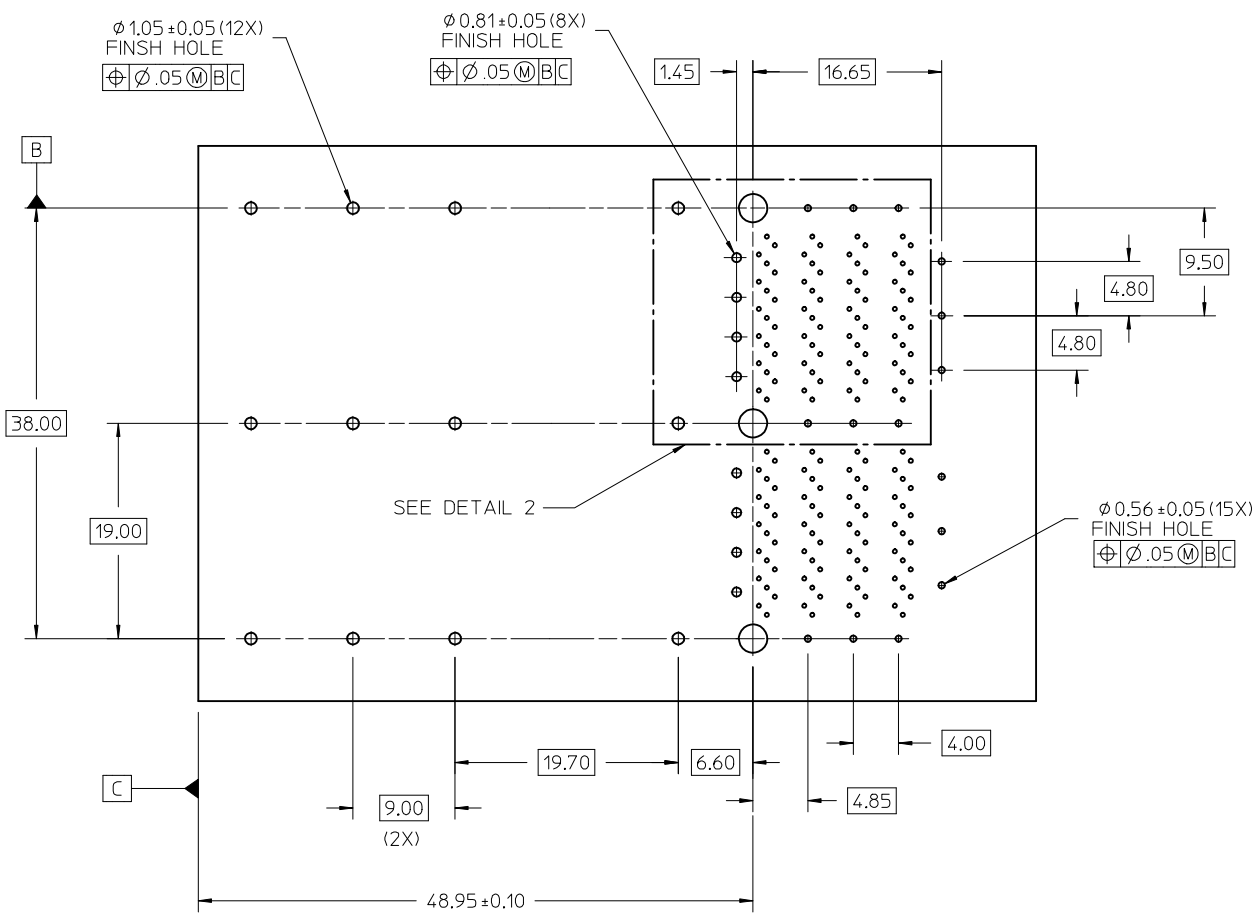

DETAIL 2
SCALE 5:1

SEE SHEET 1 EC NO: UCP2015-2796 DRWN: JKACHLIC 2015/10/01 CHKD: MBANAKIS 2015/10/02 APPR: MBANAKIS 2015/10/02	QUALITY SYMBOLS	GENERAL TOLERANCES (UNLESS SPECIFIED)	DIMENSION STYLE MM ONLY	SCALE 2:1	DESIGN UNITS METRIC	THIRD ANGLE PROJECTION
	▽=0	mm INCH	DRAWN BY DATE JKACHLIC 2013/07/11	TITLE STACKED ZQSFP+ 2X2 CONN W/METAL EMI GASKET FOR 3X STACKING ONLY		
	▽=0	4 PLACES ± --- ± ---	CHECKED BY DATE	APPROVED BY DATE MBANAKIS 2013/07/15		
	▽=0	3 PLACES ± --- ± ---	1 PLACE ± 0.13 ± ---	MATERIAL NO.	DOCUMENT NO. SD-171722-2100	SHEET NO. 2 OF 3
		0 PLACE ± --- ± ---	ANGULAR ±1/2°	SEE SHT 1 THIS DRAWING CONTAINS INFORMATION THAT IS PROPRIETARY TO MOLEX INCORPORATED AND SHOULD NOT BE USED WITHOUT WRITTEN PERMISSION		
		DRAFT WHERE APPLICABLE MUST REMAIN WITHIN DIMENSIONS	SIZE C			

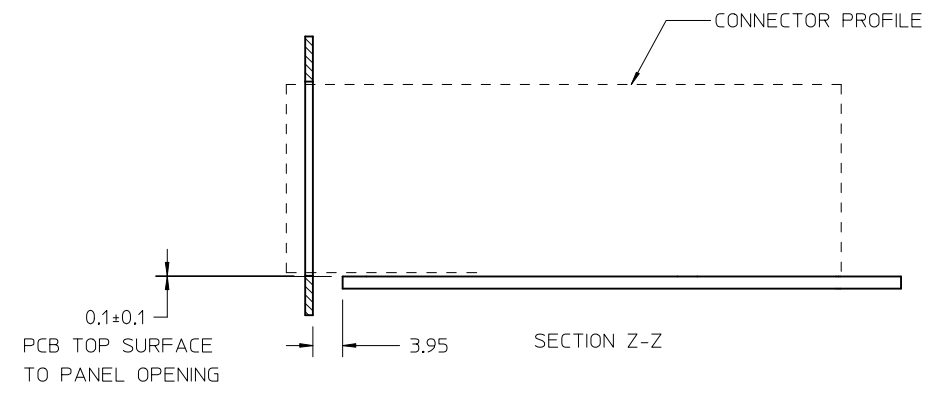
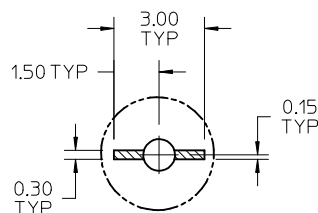
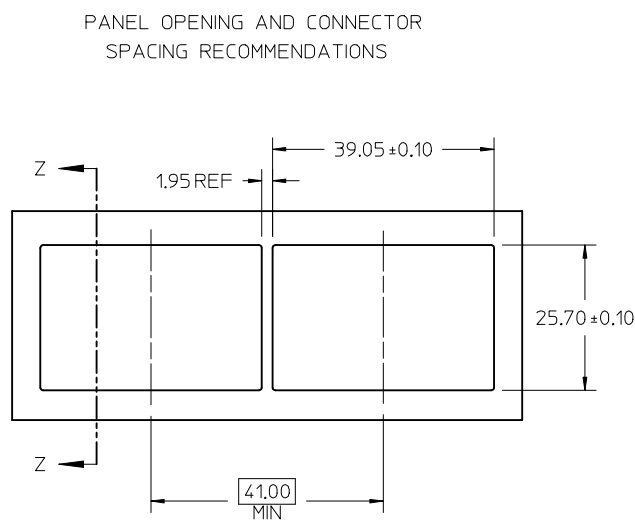
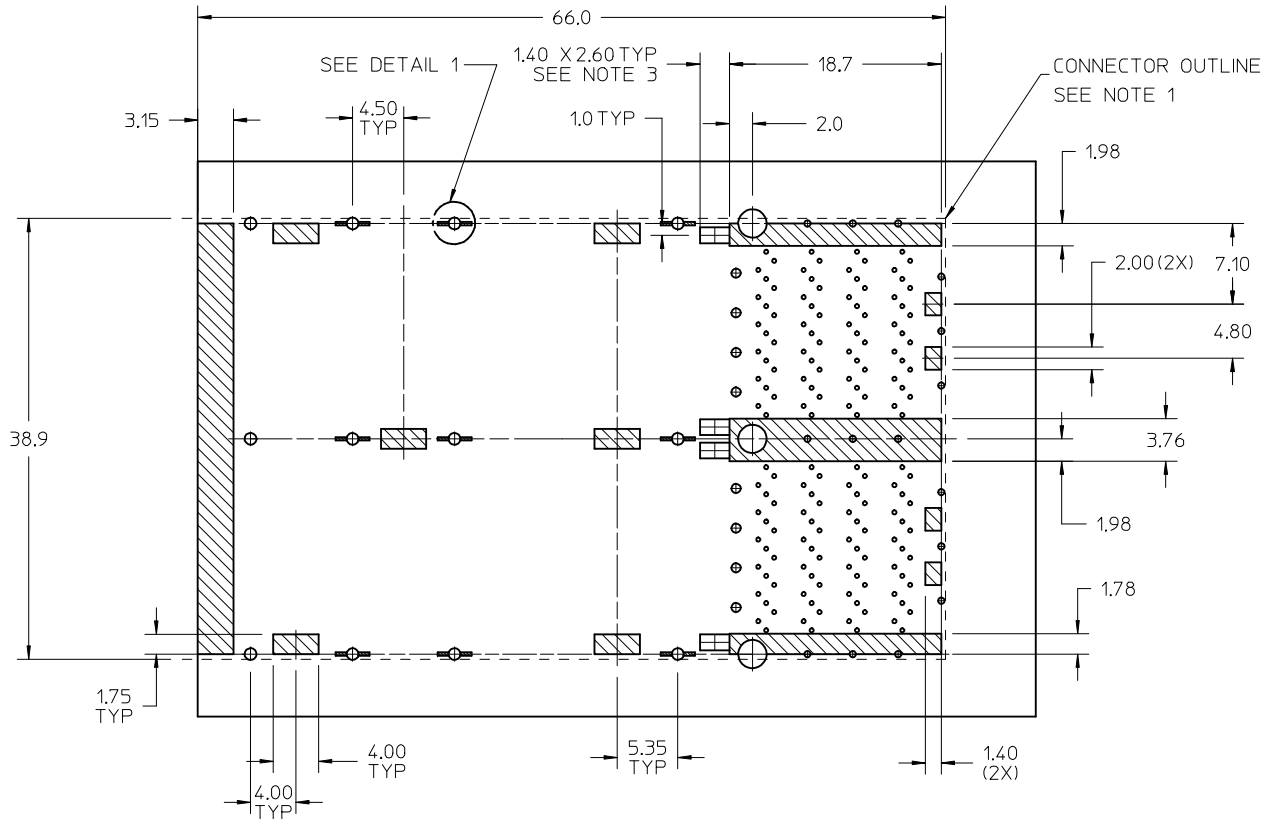

- NOTES:
1. THE ENTIRE AREA UNDER THE CONNECTOR IS A COMPONENT KEEP-OUT ZONE.
 2. CROSS HATCHED AREAS INDICATE PLACES WHERE THE PLASTIC HOUSING AND METAL CAGE MAY BE IN CONTACT WITH THE PCB SURFACE. THESE AREAS ARE THE TRACE KEEP-OUT ZONES.
 3. THESE 2 RECTANGULAR ZONES ARE FOR LED PLACEMENT. LED HEIGHT SHOULD NOT EXCEED 0.8 AND PLACEMENT SHOULD BE CENTERED WITHIN THIS LED KEEP-IN ZONE.
 4. RECOMMENDED LED CHIP PACKAGE SIZE IS 0805.

SEE SHEET 1 EC NO: UCP2015-2796 DRWN: JKACHLIC 2015/10/01 CHKD: APPR: MBANAKIS 2015/10/02	QUALITY SYMBOLS ▽=0 ▽=0 ▽=0	GENERAL TOLERANCES (UNLESS SPECIFIED)		DIMENSION STYLE MM ONLY	SCALE 2:1	DESIGN UNITS METRIC	THIRD ANGLE PROJECTION		
		4 PLACES ± --- ± --- 3 PLACES ± --- ± --- 2 PLACES ± 0.13 ± --- 1 PLACE ± 0.25 ± --- 0 PLACE ± --- ± ---	mm INCH	DRAWN BY JKACHLIC	DATE 2013/07/11	TITLE STACKED ZQSFP+ 2X2 CONN W/METAL EMI GASKET FOR 3X STACKING ONLY			
		ANGULAR ±1/2°		CHECKED BY MBANAKIS	DATE 2013/07/15	molex			
		DRAFT WHERE APPLICABLE MUST REMAIN WITHIN DIMENSIONS		MATERIAL NO. SEE SHT 1	DATE	DOCUMENT NO. SD-171722-2100	SHEET NO. 3 OF 3		