

### Peak Emission Wavelength: 1650nm

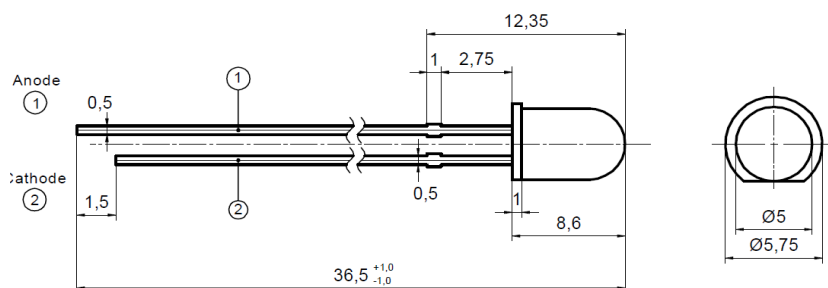

#### Description

- Standard 5mm plastic lens package housed without standoff leads
- Type: MQW
- High power
- High speed infrared

#### Application

- Optical communication
- Safety equipment
- Automation

### Absolute Maximum Ratings (Ta=25°C)



ITEMS	TEST CONDITIONS	SYMBOL	RATINGS	UNIT
Forward DC Current		If	100	mA
Peak Forward Current	(tp ≤ 50us, tp/T=1/2)	Ifp	200	mA
Power Dissipation		Pd	150	mW
Operating Temperature Range		Top	-20 to +80	°C
Storage Temperature Range		Tstg	-55 to +100	°C
Lead Soldering Temperature	t<5s, 3mm from case	Tslg	260	°C

### Electrical & Optical Characteristics (Ta = 25°C)

ITEMS	SYMBOL	CONDITIONS	MIN	TYP	MAX	UNIT
Forward Voltage	If	If=20mA	--	0.7	0.95	V
Forward Voltage	Vf	If=100mA	--	0.8	1	V
Reverse Voltage	Vr	Ir=10uA	5	--	--	V
Radiant Power	Φe	If=20mA	2.2	3.0	--	mW
Radiant Power	Φe	If=100mA	6.8	10	--	mW
Radiant Intensity	Ie	If=20mA	--	10.6	--	mW/sr
Radiant Intensity	Ie	If=100mA	--	50	--	mW/sr
Peak Wavelength	λp	If=20mA	1610	1650	1690	nm
Spectral Bandwidth at 50%	Δλ0.5	If=20mA	--	100	--	nm
Viewing Angle	φ	If=20mA	--	20	--	deg
Switching Time	tr, tf	If=20mA	--	25, 45	--	ns

### Spectral Response

