

NO.	DESCRIPTION OF REVISIONS	BY	CHKD	DATE	COUNT	DESCRIPTION OF REVISIONS	BY	CHKD	DATE
1	RE-F-06821	J.M	H.O	00.04.06	1				

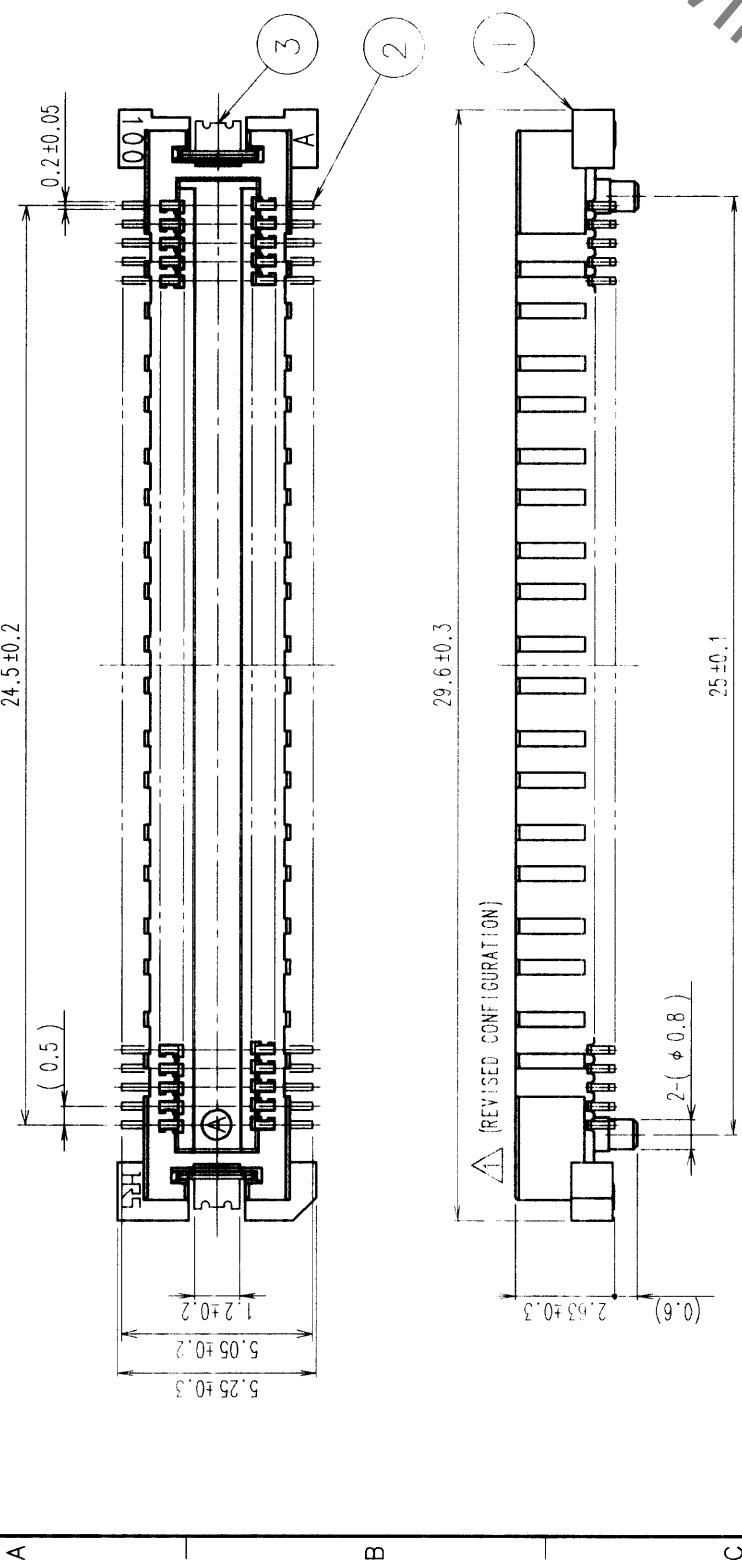

RECOMMENDED LAND PATTERN DIMENSION OF PCB

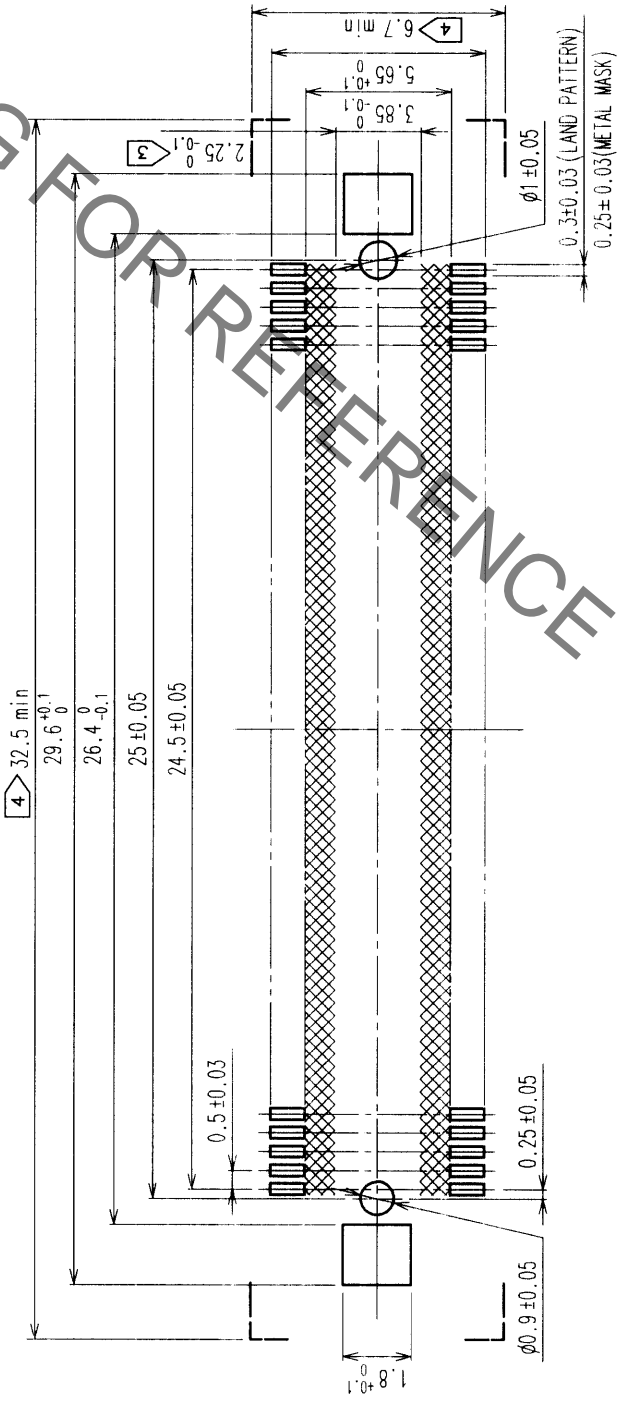

- NOTES
- SMT LEAD-COPLANARITY: 0.1 MAX.
 - THIS PRODUCT HAS NO POLARITY TO PATTERN FOR MOUNTING.
 - MAKE SURE WIDTH OF PATTERN IS WITHIN THAT OF LAND, OR LEAD MAY TOUCH PATTERN. (THIS APPLIES TO HATCHED AREA.)
 - DO NOT MOUNT OTHER DEVICES ONTO [] AREA, OR MATING PAIR CANNOT BE MATED.
 - TO BE EMBOSSED CARRIER TAPED AS SPECIFIED IN SHEET 2.

NO.	COPPER ALLOY	CONTACT AREA: GOLD (0.1μm) OVER NICKEL	BEIGE	UL94V-0	FINISH, REMARKS	NO.	PHOSPHOR BRONZE	TIN PLATED	FINISH, REMARKS
2	COPPER ALLOY	CONTACT AREA: GOLD (0.1μm) OVER NICKEL	BEIGE	UL94V-0	FINISH, REMARKS	3	PHOSPHOR BRONZE	TIN PLATED	FINISH, REMARKS
1	LCP	LEAD: GOLD FLASH OVER NICKEL							
CODE NO. (OLD)		CL		DRAWN		DESIGNED		CHECKED	
				J.MATSUKAWA		J.MATSUKAWA		M.ISHIDA	
				00.01.15		00.01.15		00.01.17	
				00.01.15		00.01.15		00.01.17	
DRAWING NO.		EDC3-152623-02		PART NO.		FX11A-100P-SV0.5(22)			
SCALE		5 : 1		CODE NO.		CL573-0643-1-22			
UNITS		mm		HRS		HIROSE ELECTRIC CO.,LTD.			

TO	
PCK	

HRS DRAWING FOR REFERENCE

COUNT	DESCRIPTION OF REVISIONS	BY	CHKD	DATE	COUNT	DESCRIPTION OF REVISIONS	BY	CHKD	DATE
△					△				
△					△				
△					△				

REELED DIMENSION (FREE)

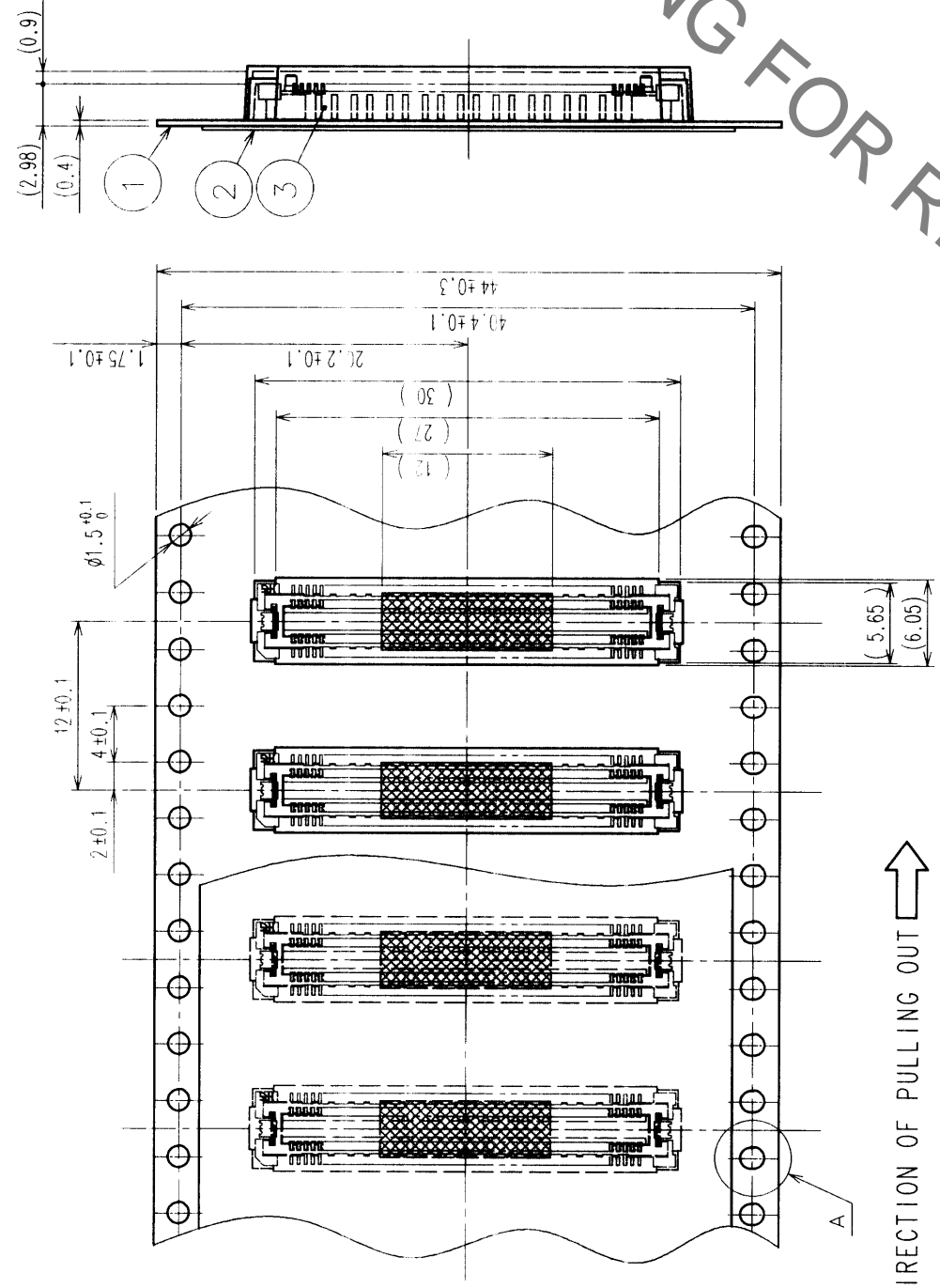
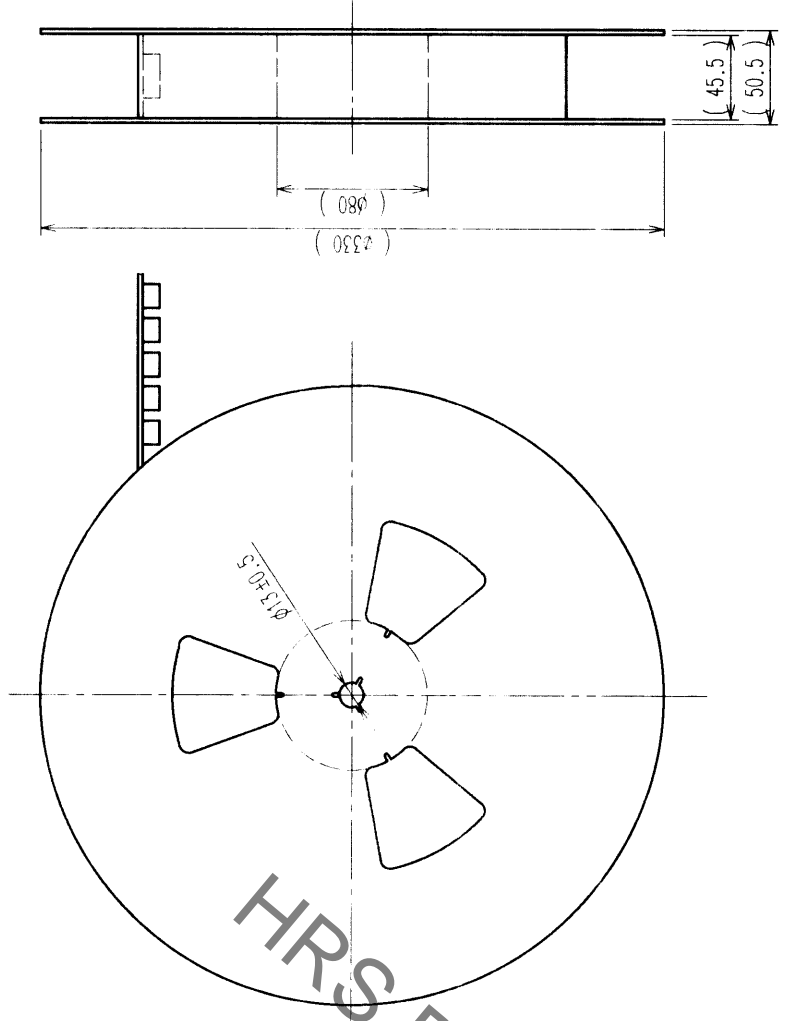

A (5:1)

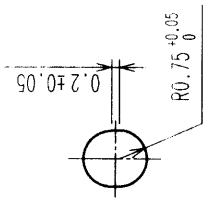

DETAIL FOR VACUUM PICKUP (5:1)

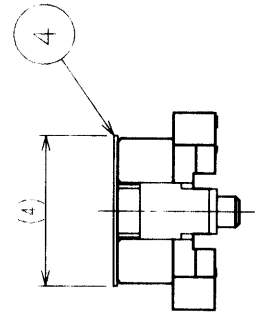

- NOTES
- 1 REEL: 1000 CONNECTORS.
 - 2 MINIMUM 10 COMPARTMENTS FROM BOTH REEL ENDS REMAIN EMPTY.
 - 3 THIS PRODUCT HAS NO POLARITY TO TAPE AND REEL PACKAGING.

NO.	PET	TOP COVER TAPE	NO.	POLYIMIDE	(TAPE FOR VACUUM PICKUP)
2	PS	EMBOSSED CARRIER TAPE	3	(CONNECTOR)	
NO.	MATERIAL	FINISH, REMARKS	NO.	MATERIAL	FINISH, REMARKS
CODE NO. (OLD)	CL		DRAWN	DESIGNED	CHECKED
			J. MATSUKAWA	J. MATSUKAWA	M. ISHIDA
			00.01.15	00.01.15	00.01.17
DRAWING FOR PACKING			PART NO.		
SCALE 2:1			EDC3-152623-02		
UNITS			CODE NO.		
HIROSE ELECTRIC CO., LTD			FX11A-100P-SV0.5(22)		
CL			CL573-0643-1-22		
2			2		

TO	
PCK	

2