

# OPL200

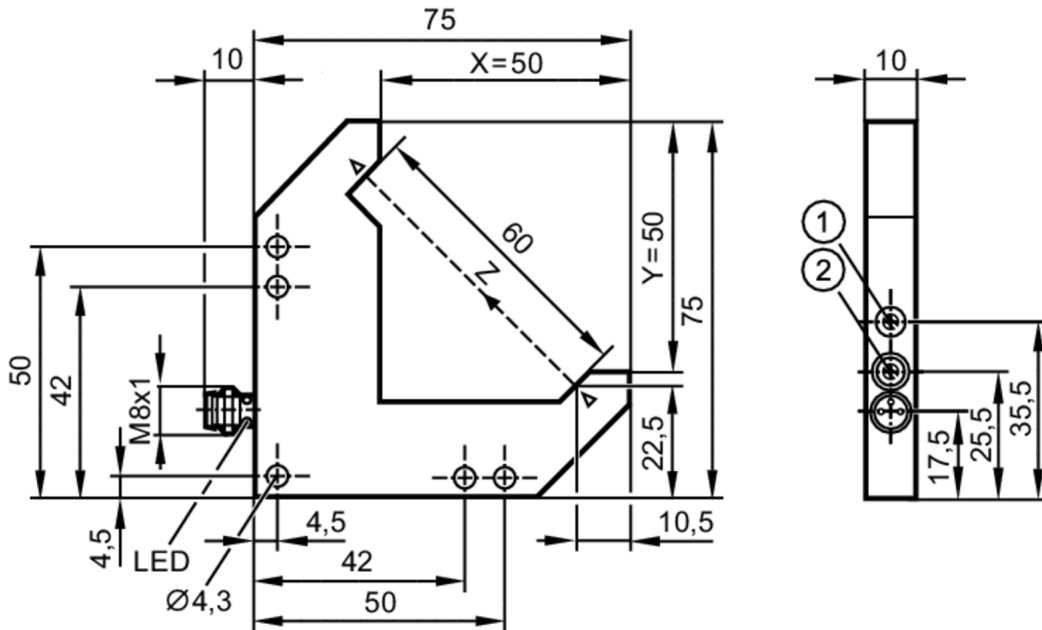

## Photoelectric angle sensor

OPL-FCKG/IO-LINK/AS



- 1 potentiometer sensitivity
- 2 output function switch



### Product characteristics

Type of light red light

### Electrical data

Operating voltage [V]	10...30 DC; (operating voltage "supply class 2" according to cULus)
Current consumption [mA]	< 30
Protection class	III
Reverse polarity protection	yes
Type of light	red light
Wave length [nm]	660

### Outputs

Electrical design	PNP
Output function	light-on/dark-on mode; (selectable)
Max. voltage drop switching output DC [V]	1
Permanent current rating of switching output DC [mA]	100
Switching frequency DC [Hz]	5000
Short-circuit protection	yes
Type of short-circuit protection	pulsed
Overload protection	yes

### Detection zone

Diameter of the smallest detectable object [mm]	0.3
---	-----



## Photoelectric angle sensor

OPL-FCKG/IO-LINK/AS

Interfaces		
Communication interface	IO-Link	
Transmission type	COM2 (38,4 kBaud)	
IO-Link revision	1.1	
SDCI standard	IEC 61131-9	
Profiles	Smart Sensor: Device Identification; Device Diagnosis; Teach Channel; Switching Channel; Process Data Variable	
SIO mode	yes	
Required master port type	A	
Min. process cycle time [ms]	3.2	
Supported DeviceIDs	Type of operation	DeviceID
	Default	978
Operating conditions		
Ambient temperature [°C]	-25...60	
Protection	IP 67	
Tests / approvals		
EMC	EN 60947-5-2	
MTTF [years]	709	
Mechanical data		
Weight [g]	114.5	
Dimensions [mm]	75 x 10 x 75	
Side length X [mm]	50	
Side length Y [mm]	50	
Sensor width Z [mm]	60	
Materials	housing: diecast zinc black anodised; lens: glass	
Displays / operating elements		
Display	switching status	1 x LED, yellow
Remarks		
Remarks	operating voltage "supply class 2" according to cULus	
Pack quantity	1 pcs.	
Electrical connection		
Connector: 1 x M8; coding: A		

# OPL200

## Photoelectric angle sensor

OPL-FCKG/IO-LINK/AS



### Connection



4: OUT / IO-Link