

MODEL NUMBER  
TRM-2090-MO-SMA-02

- NOTES:
- 1.0 ELECTRICAL SPECIFICATIONS:
    - 1.1 FREQUENCY RANGE: DC TO 18.0 GHz
    - 1.2 MAXIMUM INPUT POWER:
      - 2 WATTS AT +25°C
      - 1 WATT AT +125°C
    - 1.3 MAXIMUM VSWR:
      - DC to 4 GHz: 1.05:1
      - 4 to 12 GHz: 1.10:1
      - 12 to 18 GHz: 1.14:1
    - 1.4 IMPEDANCE: 50 OHMS
    - 1.5 TEMPERATURE RANGE: -65°C to +125°C
    - 1.6 WEIGHT: .12 Oz. (3.4 GRAMS) MAX.
  - 2.0 MARKING:
    - 2.1 MARK UNIT AS SHOWN:
      - REF.: INK-02639-27-05

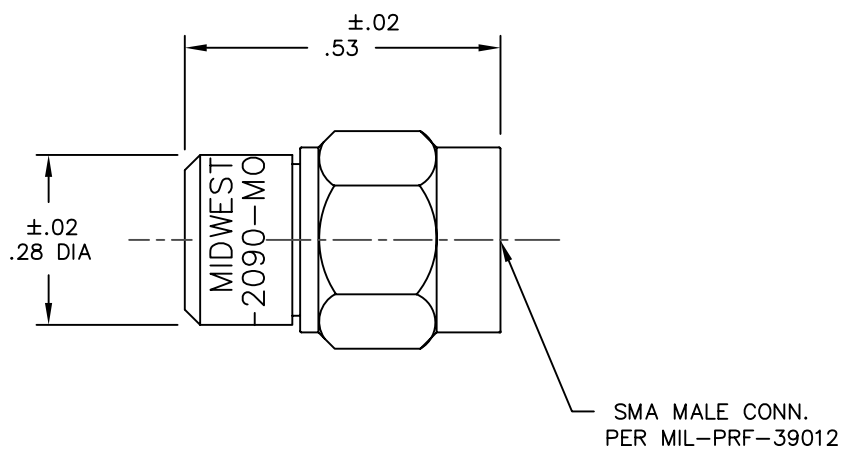

DWG. NO. WAS: 02360-01-00

REV.	DESCRIPTION	DATE
-	RELEASED	7/26/85
A	ECR 3676	6/24/85
B	ECR 5855	2/20/88
C	ECR 6545	8/27/89
D	ECR 6940	11/14/89
E	ECR 7356	4/24/90
E1	REDRAW ON CAD	9/6/91
F	ECN 11825	5/18/92
F1	ADDED TITLEBLOCK	10/28/05

NOTICE: The information contained in this drawing is proprietary and must not be used without the permission of Emerson Network Power.  UNLESS OTHERWISE NOTED DIMENSIONS ARE IN INCHES AND TOLERANCES ARE: 3 PLACE DECIMALS ±.005 2 PLACE DECIMALS ±.02 FRACTIONS ±1/64 PARALLELITY: T.I.R. _____ FLATNESS: T.I.R. _____ CONCENTRICITY: T.I.R. _____ ANGLES AND PERPENDICULARITY: ±1'	CAGE CODE <b>34078</b>	<b>MIDWEST MICROWAVE</b>		
			TITLE TERMINATION OUTLINE	
	DRAWN/DATE A.BEATTY 9/6/91	ENG./DATE G.KOZAK 9/23/91	DRAWING NUMBER TRM-2090-MO-SMA-02-01	REV. F1
	CHECKED/DATE C.RICKARD 9/10/91	APPROVED/DATE	SCALE: 5=1	SHEET 1 of 1