

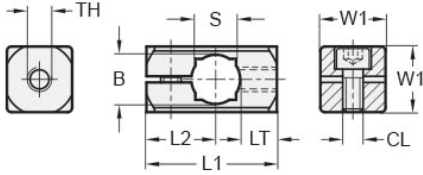

## MT10-CSBC-M6-AN

Ruland Sensor Bracket Clamp Connector, Thru Hole 10mm, Thread M6, L 30mm, Black Anodized Aluminum



### Description

Ruland MT10-CSBC-M6-AN is a sensor bracket clamp connector with a 10mm thru hole diameter, M6 thread, 16mm width/height, and 30mm overall length. It is made with black anodized aluminum and has stainless steel cap screws. These clamp connectors are designed to fit with sensor brackets and mounting brackets with the same threading. Adjustable lever clamp kits with the same thread size can be attached to this clamp connector. The width/height of the bracket clamp must also be equal to the sleeve and stud length of the adjustable lever clamp kit. All bracket clamps from Ruland are RoHS3 and REACH compliant.

### Product Specifications

<b>Thru Hole Diameter B</b>	10 mm	<b>Thru Hole Tolerance</b>	+0.09/-0 mm
<b>Square Thru Hole S</b>	8 mm	<b>Thread (TH)</b>	M6
<b>Thread Depth LT</b>	8 mm	<b>Edge To Center L2</b>	17 mm
<b>Width &amp; Height W1</b>	16 mm	<b>Overall Length L1</b>	30 mm
<b>Clamp Screw CL</b>	M5	<b>Weight (lbs)</b>	0.036200
<b>Material Specification</b>	Anodized Aluminum	<b>Manufacturer</b>	JW Winco/ Otto Ganter
<b>UPC</b>	634529245668	<b>Country of Origin</b>	Germany
<b>Tariff Code</b>	7609.00.0000	<b>UNSPC</b>	31162908