

Series 0900 by PRECI-DIP

Spring Loaded Pin Contact

Surface mount with hollow piston and beryllium copper spring

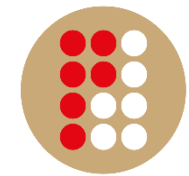

preci-dip

Spring Characteristic

Initial above PCB height : H
Maximum stroke : 1.4 mm

Recommended working range from H1 To H2

F init = 0.25 N @ H init
F1 = 0.3 N @ H1
F nom = 0.6 N @ H nom
F2 = 1.2 N @ H2

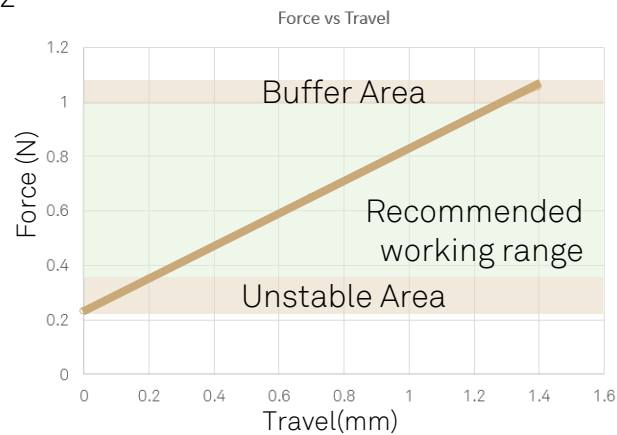

Technical Characteristic

MATERIAL

Piston and Barrel : Brass, 0.5 μ m / 20 μ " Gold plated over Nickel
Spring : Becu, 0.25 μ m / 10 μ " Gold plated over Nickel Flash

ELECTRICAL

Rated current : 2A continuous in static mode
Contact Resistance: 20 mOhm

MECHANICAL

Rigid hollow piston design only use in static applications. ([see brochure](#))
For dynamic applications, use Multi-Finger Clip Design (Series 0900-CLIP)
More than 100.000 cycles on recommended working range

ENVIRONMENTAL

Operating temperature : -55°C to + 125°C

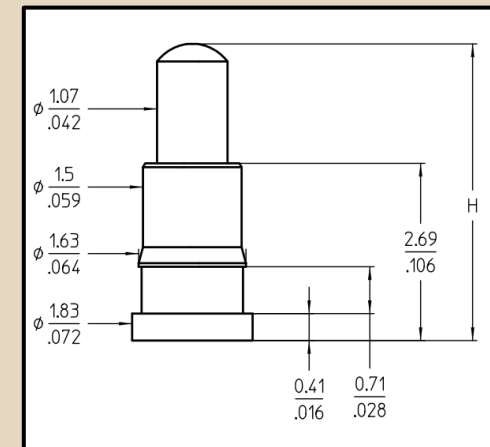

| | |
|-----------------------|----------------------------|
| Standard Tolerances : | |
| Lengths | ± 0.15 mm $\pm .006$ " |
| Diameters: | ± 0.05 $\pm .002$ |
| Angles: | $\pm 2^\circ$ |

Ordering information

| | H (mm / inch) | H1 (mm/inch) | Hnom (mm / inch) | H2 (mm/inch) |
|--------|------------------|-----------------|---------------------|-----------------|
| 0906-1 | 4.5 / .177 | 4.3 / 0.169 | 3.8 / 0.149 | 3.2 / 0.125 |
| 0906-2 | 5.0 / .197 | 4.8 / 0.189 | 4.3 / 0.169 | 3.7 / 0.145 |
| 0906-3 | 5.5 / .217 | 5.3 / 0.208 | 4.8 / 0.189 | 4.2 / 0.165 |
| 0906-4 | 6.0 / .236 | 5.8 / 0.228 | 5.3 / 0.208 | 4.7 / 0.185 |

| | |
|-----------------|-------------|
| Bulk | : 0900-X |
| T & R Packaging | : 0900-X-02 |