

May.1.2023 Copyright 2023 HIROSE ELECTRIC CO., LTD. All Rights Reserved.  
In case of consideration for using Automotive equipment / device which demand high reliability, kindly contact our sales window correspondents.

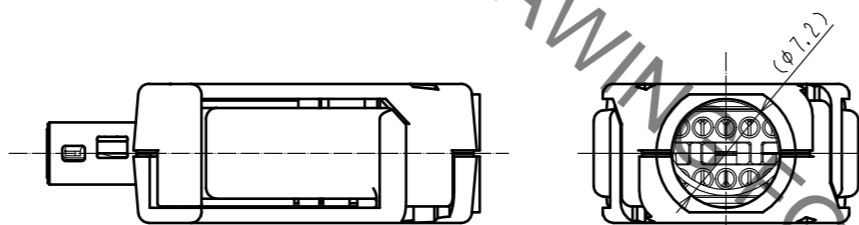

Notes. 1. Recommended cable condition is shown below.  
 ⚠ A list of compatible cables is available on the Hirose website.  
 When using a non-recommended cable, please contact a Hirose sales representative.  
 Refer to the technical specification (ETAD-E3164) for wiring and assembly procedures.

| Items            | Recommended Condition |
|------------------|-----------------------|
| Conductor size   | AWG # 28-22           |
| Insulation O. D. | φ 1.55 mm MAX.        |
| Braid Shield     | Tin plating           |
| Sheath O. D.     | φ 6.3 -7.2 mm         |

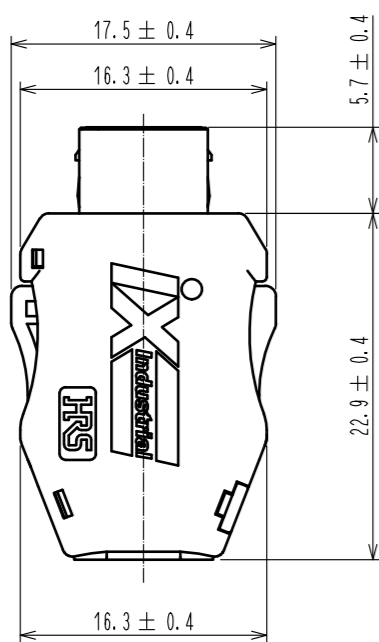
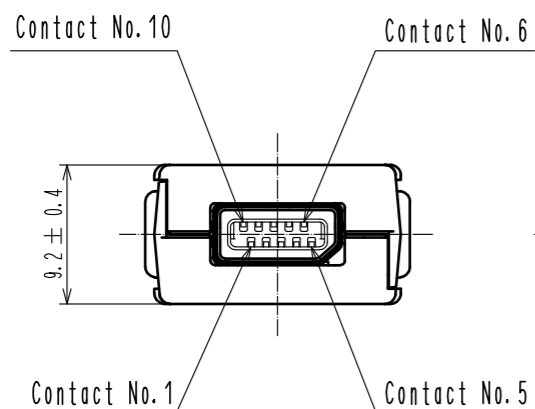
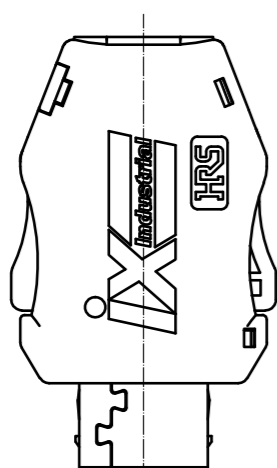
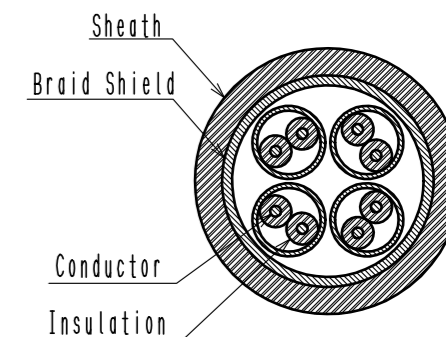

2. This product (Type B) is used for non Ethernet applications like signaling, serial or other industrial bus communication systems. Please use Type A for 10/100 Mbit/s and 1/10 Gbit/s Ethernet communication.

⚠ Mating Key

Type A

Type B

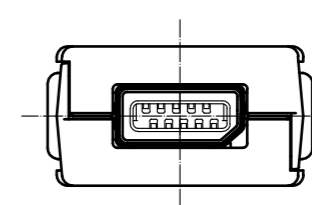
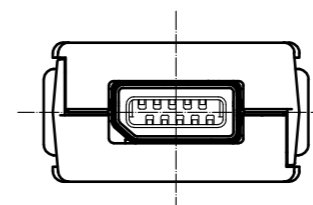

⚠ ③ Excluding the plug unit, this product is packaged separately by the type of parts. The shield shell is packaged prior to bending. (See next page.)

|                                      |                 |                                |            |  |                        |                         |                  |
|--------------------------------------|-----------------|--------------------------------|------------|--|------------------------|-------------------------|------------------|
| 3                                    | Stainless Steel |                                | 7          | PC   | Dark gray, UL94V-0     |                         |                  |
| 2                                    | PA              | Black, UL94V-0                 | 6          | Stainless Steel                            | Nickel 0.2 μm min      |                         |                  |
| 1                                    | Copper Alloy    | Contact area : Gold 0.2 μm min | 5          | Stainless Steel                            | Nickel 1 μm min        |                         |                  |
|                                      |                 | Wiring area : Gold 0.03 μm min | 4          | PA   | Black, UL94V-0         |                         |                  |
| NO.                                  | MATERIAL        | FINISH . REMARKS               | NO.        | MATERIAL                                   | FINISH . REMARKS       |                         |                  |
| UNITS<br>mm                          |                 | SCALE<br>2 : 1                 | COUNT<br>6 | DESCRIPTION OF REVISIONS<br>DIS-E-00006884 | DESIGNED<br>MT. YASUDA | CHECKED<br>KI. KAGOTANI | DATE<br>20210929 |
| <b>HRS</b> HIROSE ELECTRIC CO., LTD. |                 | APPROVED : RI. TAKAYASU        | 20170328   | DRAWING NO.                                | EDC-129507-00-00       |                         |                  |
|                                      |                 | CHECKED : KI. NAGANUMA         | 20170327   | PART NO.                                   | IX40G-B-10S-CV(7.0)    |                         |                  |
|                                      |                 | DESIGNED : TS. SAKAIZAWA       | 20170327   | CODE NO.                                   | CL0251-0032-0-00       |                         |                  |
|                                      |                 | DRAWN : TS. SAKAIZAWA          | 20170327   |  |                        |                         | 1/2              |

May.1.2023 Copyright 2023 HIROSE ELECTRIC CO., LTD. All Rights Reserved.  
In case of consideration for using Automotive equipment / device which demand high reliability, kindly contact our sales window correspondents.

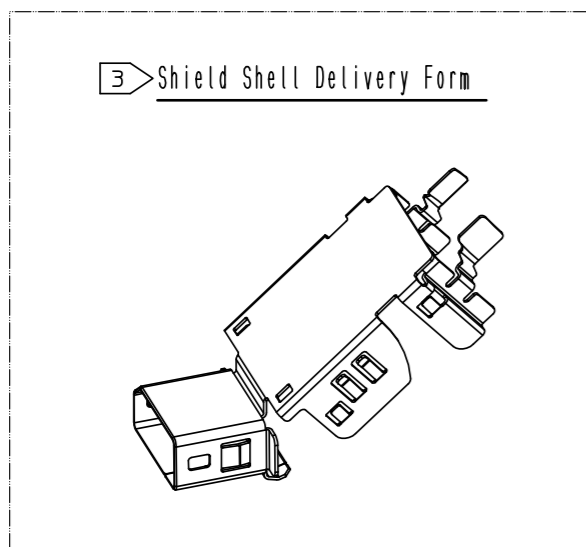

Product Structure

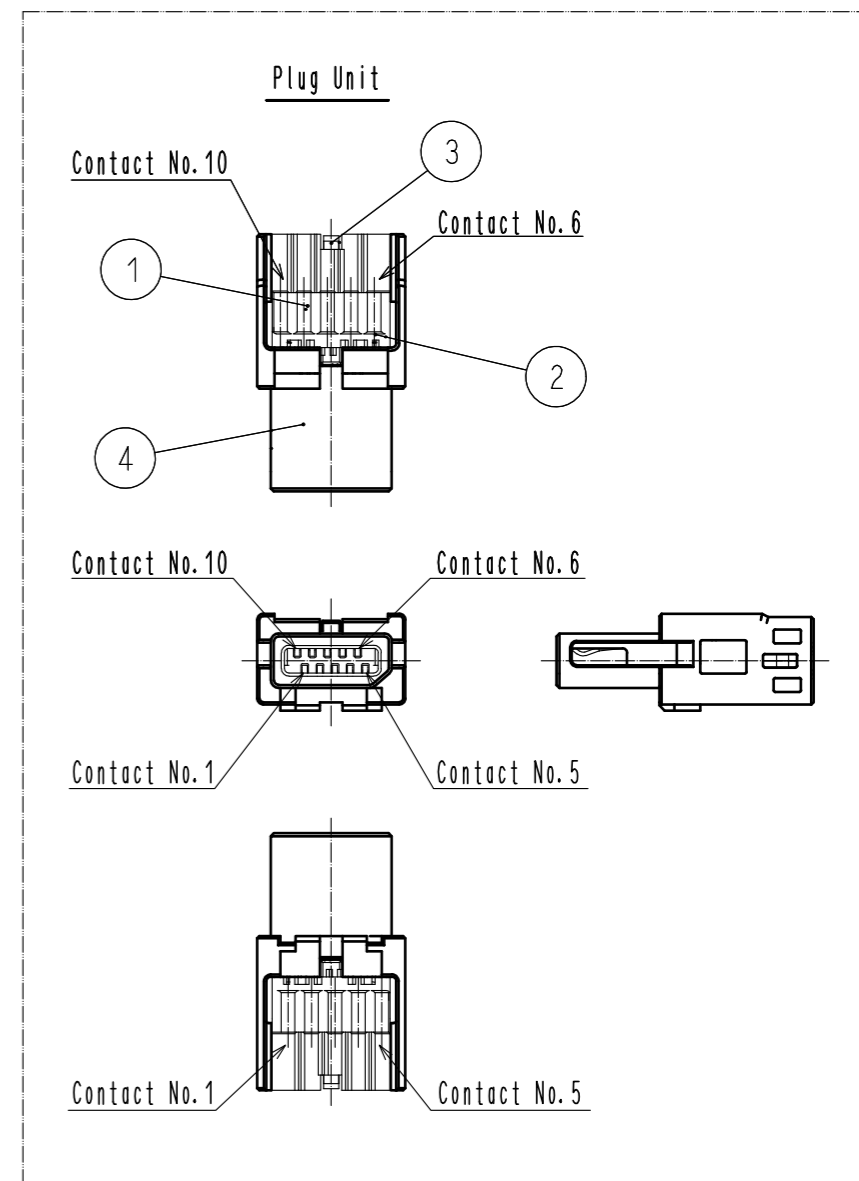
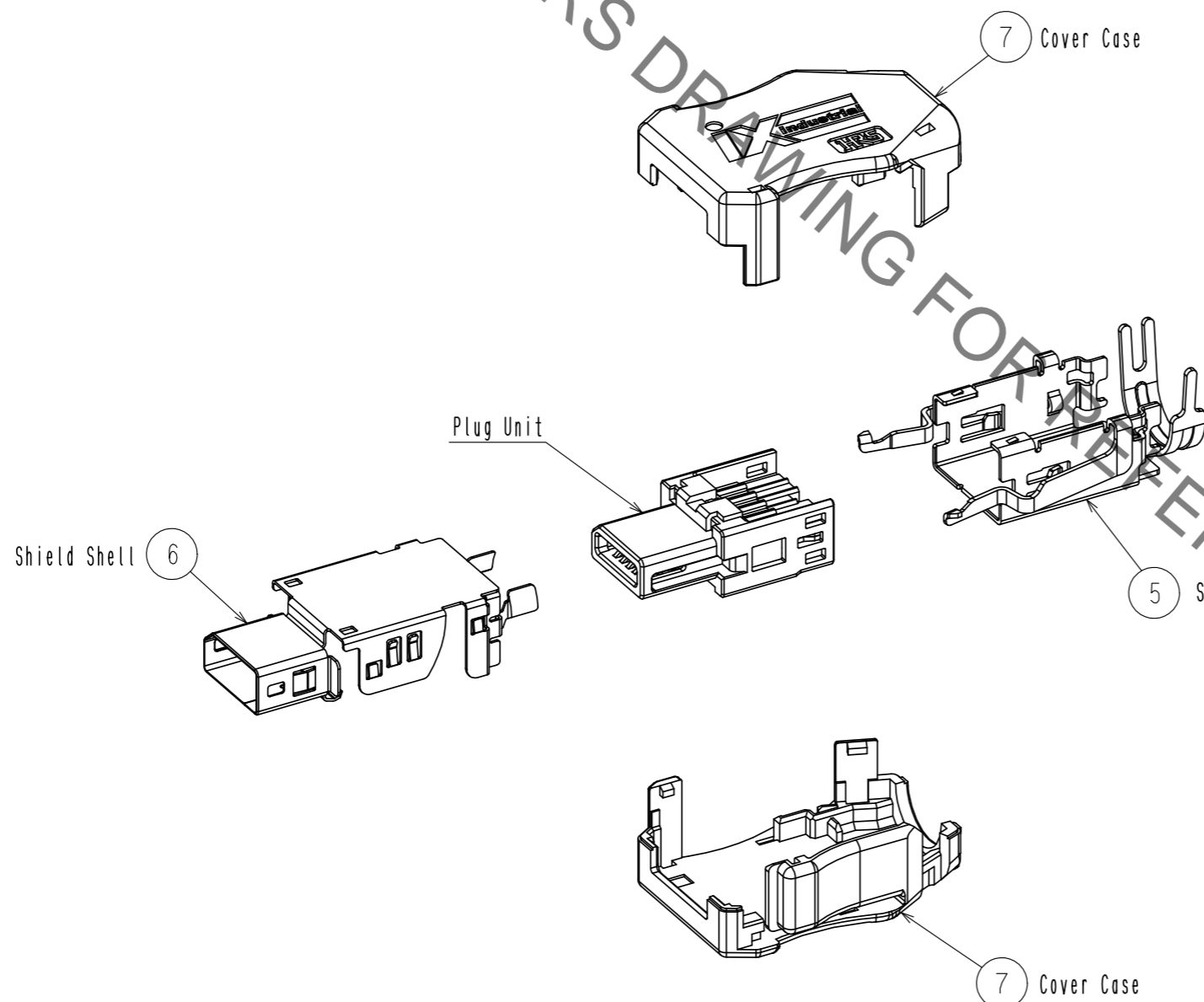

Mated Condition

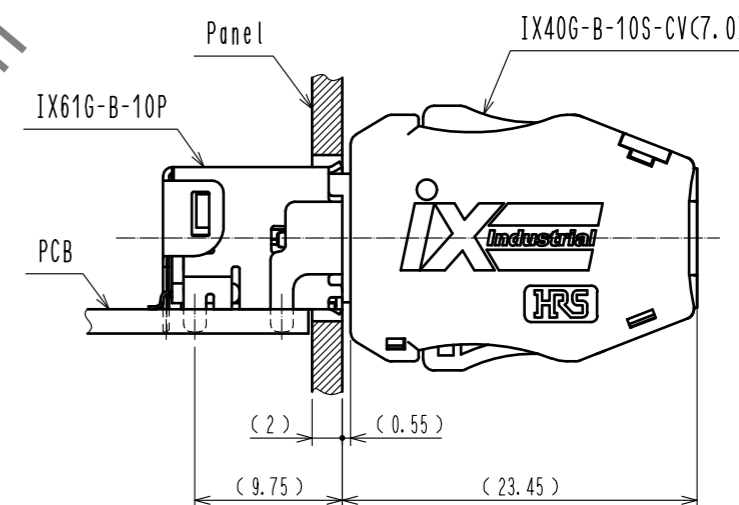

**HRS**

|             |                     |
|-------------|---------------------|
| DRAWING NO. | EDC-129507-00-00    |
| PART NO.    | IX40G-B-10S-CV(7.0) |
| CODE NO.    | CL0251-0032-0-00    |

2/2