

Driver LC 100/24V Ip ADV UNV

Constant voltage advanced series (US applications)

**Product description**

- _ Constant voltage LED driver
- _ Universal input voltage range
- _ Max. output power 96 W
- _ Efficiency > 87 %
- _ Class 2
- _ FCC Part 15
- _ UL Listed Class P
- _ Only for US applications
- _ Nominal lifetime up to 50,000 h (at ta 40 °C)
- _ 5 years guarantee (conditions at www.tridonic.com)

Housing properties

- _ Casing: metal, black
- _ Potted style
- _ Dry and damp location

Properties

- _ Protective features (overtemperature, short-circuit, overload, no-load)
- _ Linear and rugged form factor

Website

<http://www.tridonic.us/28002133>



Spotlights



Downlights



Linear



Area



Floor | Wall



Free-standing



Street



Decorative



High bay

Driver LC 100/24V Ip ADV UNV

Constant voltage advanced series (US applications)

The complete data sheet for this product is available in the Downloads section.

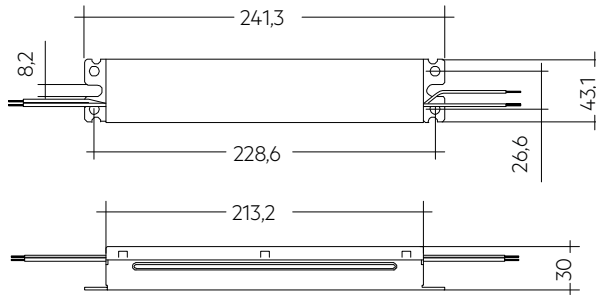

Dimensions in mm

Ordering data

Type	Article number	Packaging, carton	Packaging, pallet	Weight per pc.
LC 100/24V Ip ADV UNV	28002133	10 pc(s).	1,280 pc(s).	0.634 kg

Technical data

Rated supply voltage	120 – 277 V
AC voltage range	108 – 305 V
Rated current (at 120 V, 60 Hz, full load)	0.92 A
Rated current (at 277 V, 60 Hz, full load)	0.41 A
Leakage current (at 120 V, 60 Hz, full load)	< 500 μ A
Leakage current (at 230 V, 50 Hz, full load)	< 500 μ A
Mains frequency	50 / 60 Hz
Efficiency (at 120 V 60 Hz, full load)	> 87 %
Efficiency (at 277 V 60 Hz, full load)	> 88 %
λ (at 120 V, 60 Hz, full load)	0.97
λ (at 277 V, 60 Hz, full load)	0.92C
Output voltage tolerance	22.8 – 24 V
Max. output power	96 W
Output power range	62 – 96 W
Output LF voltage ripple (< 120 Hz)	1.6 %
Starting time (output)	\leq 1 s
Turn off time (output)	\leq 0.1 s
Hold on time at power failure (output)	0 s
Mains burst capability (between L - N)	2 kV
Mains surge capability (between L - N)	4 kV
Ambient temperature t_a	-40 ... +55 °C
Ambient temperature t_a (at lifetime 50,000 h)	40 °C
Storage temperature t_s	-40 ... +85 °C
Lifetime	up to 50,000 h
Guarantee	5 Year(s)
Dimensions L x W x H	241.3 x 43.1 x 30 mm
Hole spacing D	228.6 mm

Approval marks

Standards

UL 8750, FCC PART 15

Specific technical data

Type	Max. casing temperature t_c	Output voltage	Max. input power	Output current range	Max. output voltage (U _{OUT})
LC 100/24V Ip ADV UNV	85 °C	24 V	109 W	2,580 – 4,000 mA	24 V

① At failure mode.