

Recommended P.C. Board Layout

SCALE 4:1

SURFACE MOUNT 02 PASS THRU ENTRY

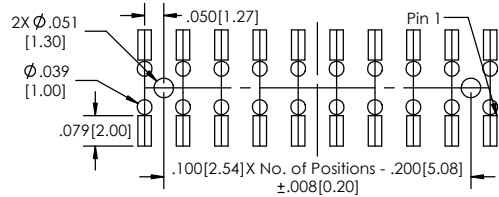

SURFACE MOUNT 02 TOP ENTRY

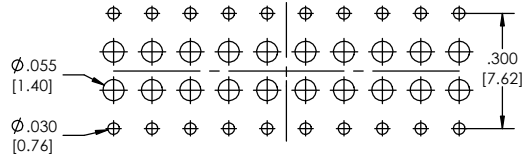
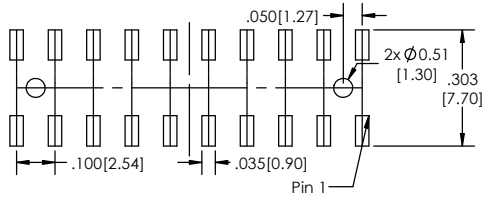

THRU HOLE OPTION 06 ENTRY

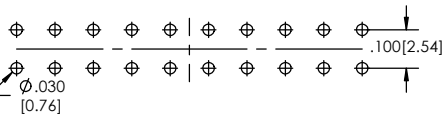

THRU HOLE OPTION 04 ENTRY

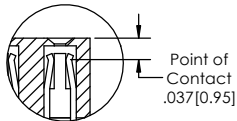

APPLICATION

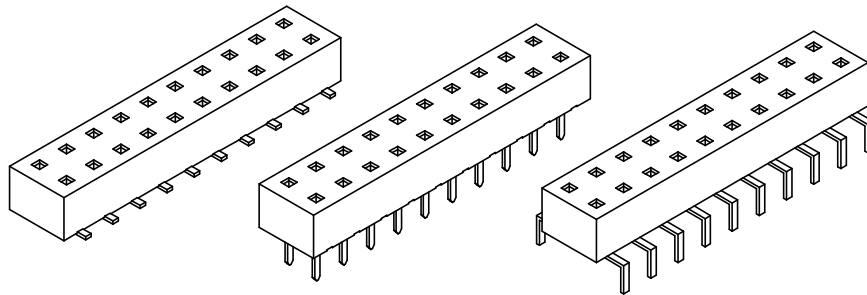
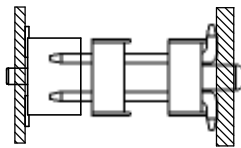

LSMBC-1 [XX] - [X] - [XX] - [XX] - [V] - [XXX] - [XX] - [X] - [XX] - [LF]
(A) (B) (C) (D) (E) (F) (G) (H) (I) (J)

- A. Pins Per Row
 - 1 through 40
- B. Row Specification
 - D= Dual Row
- C. Style
 - 02= Surface mount option
 - 04= Thru hole .100[2.54] option
 - 06= Thru hole .300[7.62] option
- D. Plating Options
 - See Plating Options below
- E. V= Vertical
- F. Polarized Position
 - Leave blank if not needed
 - If required, specify empty pin position
 - e.g. 012 for Pin 12
- G. Packing Information (Only for 02 option)
 - TR= Tube and Reel
 - TB= Tube
- H. Pad
 - P= Plastic
 - K= Kapton
 - O= No Pad
 - If left blank, packaging at MLE's discretion
 - Pad may be metal, mylar or plastic
- I. Alignment Pin (Only for 02 option)
 - Leave blank if not needed
 - AP= With
- J. Lead Free

Plating options	
G	-10µ Gold on Contact Area/ Flash on Tail
T	-Matte Tin all Over
GT	-10µ Gold on Contact Area/ Matte Tin on Tail
H	-30µ Gold on Contact Area/ Matte Tin on Tail
F	-Gold Flash over Entire Pin
FT	- Gold Flash on Contact Area/ Matte Tin on Tail

Specifications:
 Insertion Depth: .070 [1.78] to .135 [3.43]
 .102 [2.59] for bottom entry
 Insertion Force- Per Contact- H Plating:
 2oz [0.56N] avg with .025 [0.64mm] Sq. pin
 Withdrawal Force- Per Contact- H Plating:
 1.6oz [0.44N] avg. with .025 [0.64mm] Sq. pin
 Current Rating: 3.0 Ampere
 Insulation Resistance: 100M Ohms Min.
 Dielectric Withstanding: 600V AC
 Contact Resistance: 20M Ohms Max.
 Operation Temperature: -40°C to +105°C
 Max. Process Temperature
 Peak: 260°C up to 20 secs.
 Process: 230°C up to 30 secs.
 Reflow: 260°C up to 10 secs.

Mates With:
 BSTC TSHCR
 BSTCM TSHCRE
 BSTCR TSHCRSM
 BSTCRSM TSHR
 BSTS TSHRE
 LBSTCM TSHS
 LTSHCR TSHSCM
 LTSHCRE TSHSM
 LTSHR ULTSHSM
 LTSHRE ULTSHC
 LTSHSM ULTSHSCR
 TSHC

Materials:
 Contact Material: Phosphor Bronze
 Insulator Material: Polyester, UL94V-0, LCP+30%G.F., Black
 Plating: Au or Sn over 50µ" (1.27) Ni
 Tails may be clipped to achieve specific dimensions.

Products cut to specific sizes are uncancelable/nonreturnable.
 Parts are subject to change without notice.

SURFACE MOUNT OPTION

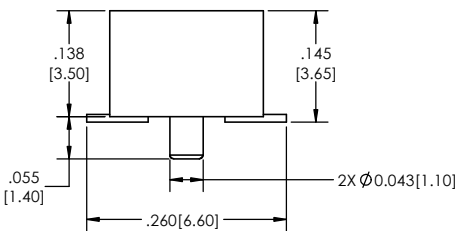

THRU HOLE OPTION 04

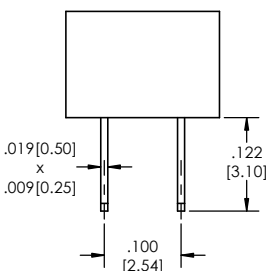

THRU HOLE OPTION 06

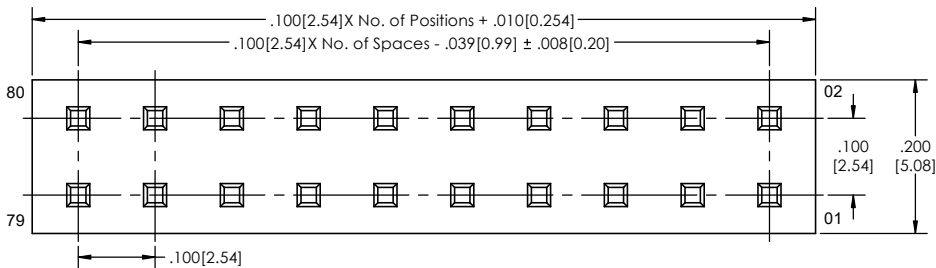
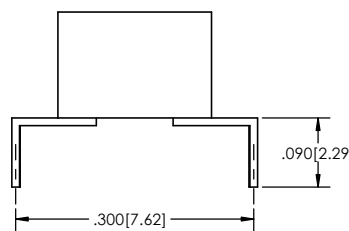

PROPRIETARY AND CONFIDENTIAL
 THE INFORMATION CONTAINED IN THIS DRAWING IS THE SOLE PROPERTY OF Major League Electronics. ANY REPRODUCTION IN PART OR AS A WHOLE WITHOUT THE WRITTEN PERMISSION OF Major League Electronics IS PROHIBITED.

UNLESS OTHERWISE SPECIFIED:		NAME		DATE
DIMENSIONS ARE IN INCHES		DRAWN	EOW	01/19/15
TOLERANCES:		CHECKED	GWE	01/19/15
ONE DECIMALS ±.100		ENG APPR.		
TWO DECIMAL ±.100		MFG APPR.		
THREE DECIMAL ±.005		ADDRESS:		
FOUR DECIMAL ±.002		2533 Centennial Blvd. Jeffersonville, IN 47130 Phone: 812-670-4174 Fax: 812-670-4175 E-Mail: mle@mlelectronics.com		
NEXT ASSY	USED ON	TITLE: LSMBC-1 SERIES		
APPLICATION	DO NOT SCALE DRAWING	SIZE	DWG. NO.	REV
		C		D
		SCALE 8:1		SHEET 1 OF 1

