



Cross-connector, No. of poles: 2, Mounting type: Can be screwed on, Width: 41 mm, Rated cross-section: 50 mm², Colour: natural

Business data

Article number	17012.0
Article name	QS 2/50
GTIN (EAN)	4044211131579
Packaging unit	10
Quantity unit	PC
Weight per piece (not including packaging)	25 g
Weight per piece (including packaging)	25.2 g
Unit of weight	G
Customs number	85389099
Country of origin	DE
Product description	Cross-connector
Colour	Natural

Technical data

Dimensions

Length	20 mm
Width	41 mm
Height	4 mm
Hole diameter	8.6 mm
Hole spacing (mid-point to mid-point)	23 mm
Pitch size	23 mm

Connection data

No. of poles	2
--------------	---

Materials

Material	Copper
Surface	Tin-plated

Further technical data

Mounting type	Screwable
Number of bridged terminals	2

Environmental Product Compliance

REACH Conform	yes
REACH Reference date	2023-01-17
REACH Candidate Substance Note	No
RoHS Conform	yes

Media

Accessories

##INVERSE##CONTA-CONNECT

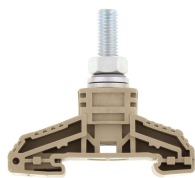

High-power stud terminal, Stud connection, Mounting type: Mounting rail TS 35/7.5, Rated cross-section: 50 mm², Width: 21 mm, Colour: Beige

Article number	Article name	GTIN (EAN)	Packaging unit
<u>17002.2</u>	HSK 50/M8 B BG	4044211131470	10 ST

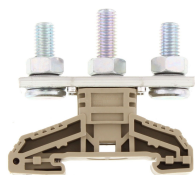

High-power stud terminal, Stud connection, Mounting type: Mounting rail TS 35/7.5, Rated cross-section: 50 mm², Width: 21 mm, Colour: Beige

Article number	Article name	GTIN (EAN)	Packaging unit
<u>17006.2</u>	HSK 50/M8 B/B BG	4044211131517	10 ST