

REVISIONS				
P	LTR	DESCRIPTION	DATE	APVD
B3		REV PER ECR-22-149214	18AUG2022	LP DSC

**AMP**  
WIRE RANGE

2/0 AWG  
SOLID OR STRANDED

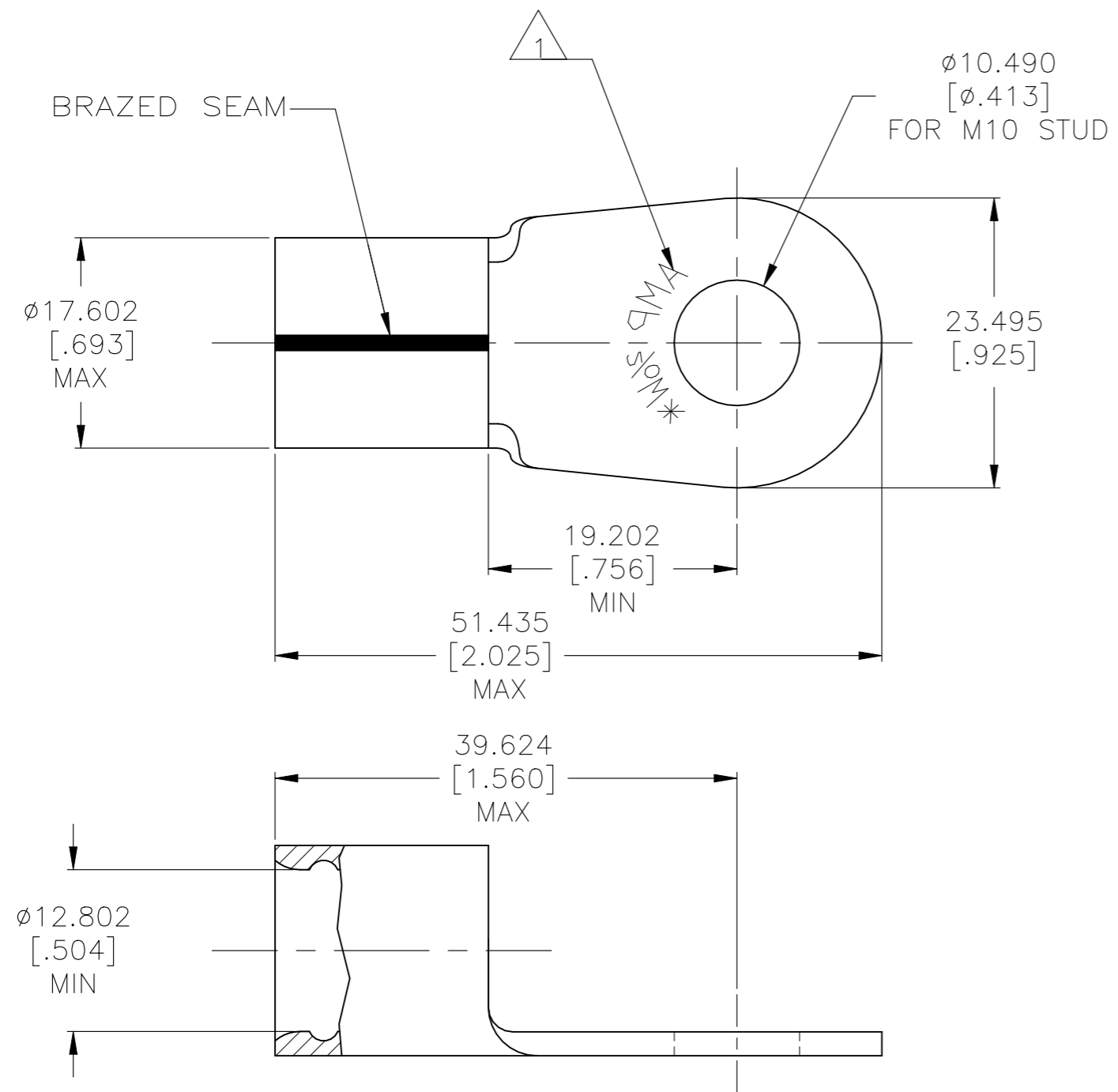

- 1 STAMP "AMP 2/0W\*" , LOCATED APPROX AS SHOWN
- 2 NOTE DELETED
- 3 NOTE DELETED
- 4 MATERIAL:  
COPPER PER ASTM B152, ANNEALED
- 5 FINISH:  
NICKEL PLATE 0.00762[.000300] MIN EXT THK PER SAE AMS-QQ-N-290
- 6 MATERIAL THK: 2.007±0.076[.079±.003]

25	LOOSE PIECE	132104-2
QTY	PACKAGE TYPE	PART NO.

**AMP INCORPORATED**  
**CUSTOMER SERVICE SYSTEMS**

MAX RECOMMENDED OPERATING TEMPERATURE:  
343°C [650°F]

FOR ADDITIONAL PRODUCT INFORMATION OR COPIES OF DRAWINGS AND TECHNICAL DOCUMENTS

PRODUCT INFORMATION CENTER  
1-800-522-6752

VOLTAGE RATING:  
N/A

FOR APPLICATION TOOLING INFORMATION

TOOLING ASSISTANCE CENTER  
1-800-722-1111

WIRE CROSS SECTIONAL AREA RANGE:  
60.6-76.3mm<sup>2</sup>[119,500-150,000]  
SOLID OR STRANDED

FOR ORDER ENTRY

1-800-526-5142

THIS DRAWING IS A CONTROLLED DOCUMENT FOR AMP INCORPORATED. IT IS SUBJECT TO CHANGE AND THE CONTROLLING ENGINEERING ORGANIZATION SHOULD BE CONTACTED FOR THE LATEST REVISION.

THIS DRAWING IS A CONTROLLED DOCUMENT.

DIMENSIONS:  
mm [INCHES]

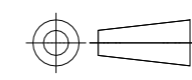

TOLERANCES UNLESS OTHERWISE SPECIFIED:

0 PLC	± -
1 PLC	± -
2 PLC	± -
3 PLC	± 0.127[.005]
4 PLC	± -
ANGLES	± -

MATERIAL  
4

FINISH  
5

DWN JR RUTH 25JAN10

CHK T MICHELUTTI 25JAN10

APVD T MICHELUTTI 25JAN10

PRODUCT SPEC

APPLICATION SPEC

114-2162

WEIGHT -

CUSTOMER DRAWING

**STE** TE Connectivity

NAME  
TERMINAL, RING TONGUE,  
STRATO-THERM, HR, SOLISTRAND,  
WIRE SIZE: 2/0 AWG

SIZE	CAGE CODE	DRAWING NO	RESTRICTED TO
A3	00779	C-132104	-

SCALE 2:1 SHEET 1 OF 1 REV B3