

Adapter M12 connector, 4-pole, for M20 cable entry, for metal enclosure



product brand name	SIRIUS ACT
product designation	Adapter
design of the product	M12 plug (male), 4-pin for M20 cable entry
product type designation	3SU1

General technical data

protection class IP	IP66, IP67, IP69(IP69K)
---------------------	-------------------------

Connections/ Terminals

wire length	0.5 m
-------------	-------

Installation/ mounting/ dimensions

mounting height	28.5 mm
installation depth	13.8 mm

Accessories

material of accessory	Metal
color of accessory	black

Certificates/ approvals

General Product Approval	Declaration of Conformity
--------------------------	---------------------------



[Miscellaneous](#)

[Miscellaneous](#)



Declaration of Conformity	Test Certificates	Marine / Shipping
---------------------------	-------------------	-------------------



[Type Test Certificates/Test Report](#)



Marine / Shipping	other
-------------------	-------



[Confirmation](#)

Further information

Information- and Downloadcenter (Catalogs, Brochures,...)

<https://www.siemens.com/ic10>

Industry Mall (Online ordering system)

<https://mall.industry.siemens.com/mall/en/en/Catalog/product?mlfb=3SU1950-0HC10-0AA0>

Cax online generator

<http://support.automation.siemens.com/WW/CAXorder/default.aspx?lang=en&mlfb=3SU1950-0HC10-0AA0>

Service&Support (Manuals, Certificates, Characteristics, FAQs,...)

<https://support.industry.siemens.com/cs/ww/en/ps/3SU1950-0HC10-0AA0>

Image database (product images, 2D dimension drawings, 3D models, device circuit diagrams, EPLAN macros, ...)

http://www.automation.siemens.com/bilddb/cax_de.aspx?mlfb=3SU1950-0HC10-0AA0&lang=en

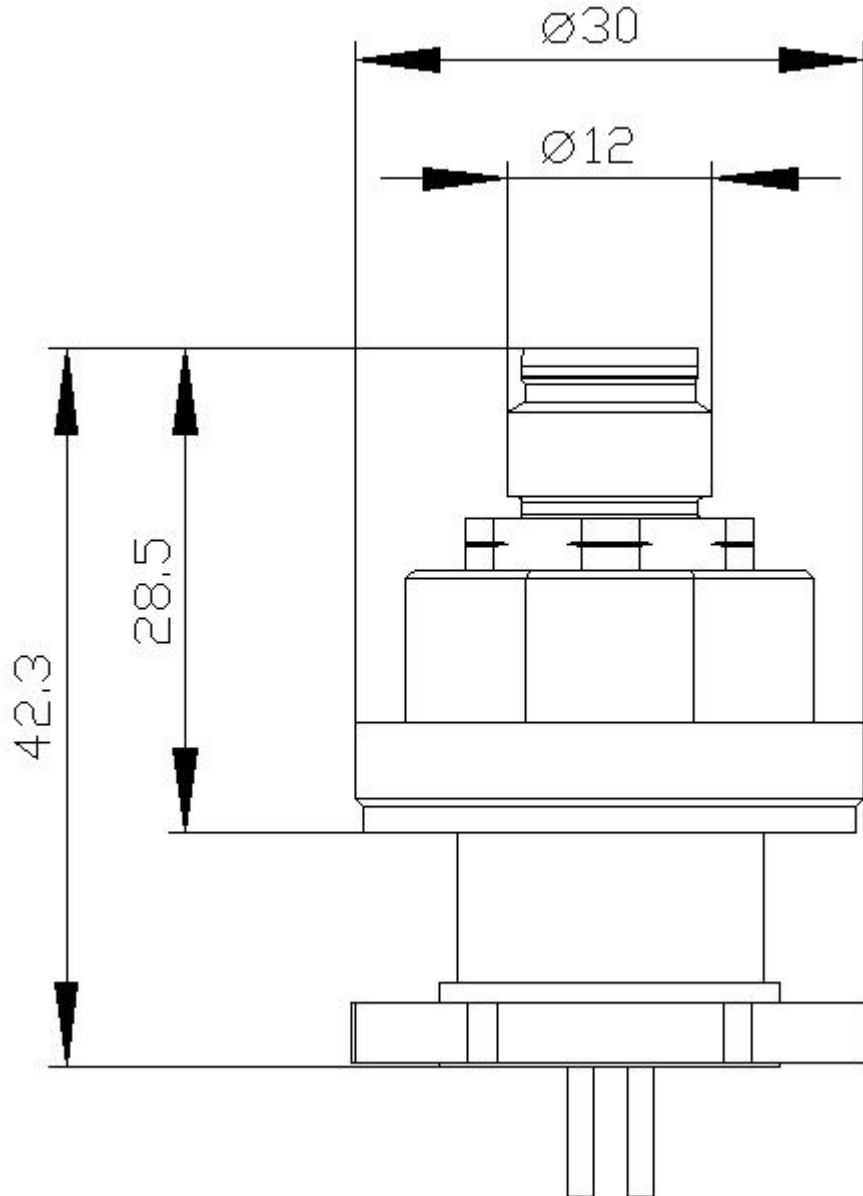

last modified:

10/22/2020 