

THIS COPY IS PROVIDED ON A RESTRICTED BASIS AND IS NOT TO BE USED IN ANY WAY DETRIMENTAL TO THE INTERESTS OF PANDUIT CORP.

NOTES:

1. IDENTIFICATION: VERTICAL, (20) 5-15R
120V / 15A / SINGLE-PHASE POU

<u>PART NO.</u> CMRPSV15SIL	<u>COLOR</u> BLACK
--------------------------------	-----------------------

2. ACCESSORY COMPONENTS:
(4) #10-32 x 1/2" MOUNTING SCREWS
(4) #12-24 x 1/2" MOUNTING SCREWS
(2) #10-32 LOCKING COLLAR SCREWS
(2) L-BRACKETS

3. DIMENSIONS IN PARENTHESES ARE METRIC (mm).

4. SURGE SUPPRESSION UP TO 330V OR 720 JOULES.

5. UL® & c-UL® LISTED 60950.

6. RoHS COMPLIANT.

7. VISIT OUR ON-LINE CATALOG AT WWW.PANDUIT.COM FOR A CURRENT LIST OF PRODUCTS APPLICABLE FOR USE WITH THIS PART.

8. MAXIMUM AVAILABLE INPUT POWER = 1.4 KW

9. INSTALLATION SHALL COMPLY WITH ALL APPLICABLE NATIONAL, STATE, AND LOCAL CODES.

PANDUIT P/N	WEIGHT
CMRPSV15SIL	9 lb (4.1 kg)

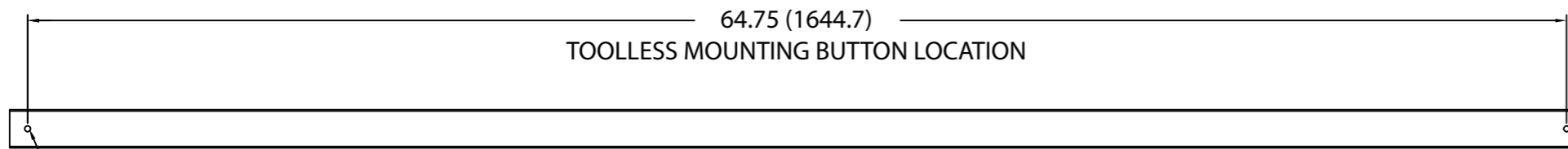

TOOLESS MOUNTING
BUTTON 2X

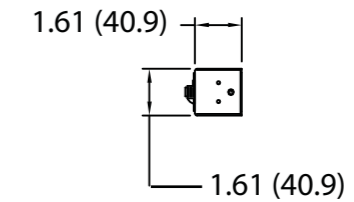
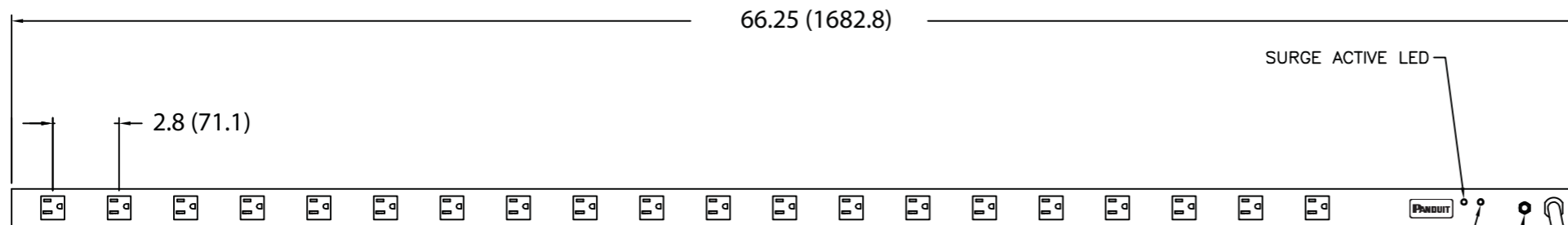

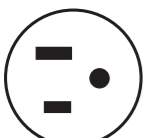

PLUG
15 AMP, 125V, SINGLE-PHASE
STRAIGHT BLADE
NEMA 5-15P

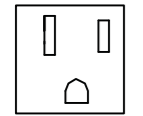

TWENTY (20)
RECEPTACLES
20 AMP, 125V
STRAIGHT BLADE
NEMA 5-15R

REV	DATE	BY	CHK	DESCRIPTION	ECN	R	CUST	SUP	OTH
01A	9-11-12	PIP	MRWA	A. ADDED NOTE #9. B. UPDATED BUTTON MOUNTING NOTE.	09V098YB				
00A	10-26-11	MRWA	KRKE	RELEASED TO PRODUCTION	09V098YB				

MODEL FILENAME	09V098YB/01.PRT
CAD FILENAME/LAYERS	09V098YB_DC/01A.PRT
PANDUIT CORP. TINLEY PARK, ILLINOIS	
VERTICAL, (20) 5-15R POWER OUTLET UNIT CUSTOMER DRAWING	
UNLESS OTHERWISE SPECIFIED, DIMENSIONAL TOLERANCES ARE: INCHES X.X +/- 0.03 [METRIC - MILLIMETER] X.X +/- 0.8 ANGLE X.XX +/- 0.015 X.X +/- 0.4 +/- 1° X.XXX +/- 0.005 X.XX +/- 0.13	
UNLESS OTHERWISE SPECIFIED, ALL DIMENSIONS ARE GIVEN IN INCHES, THIRD ANGLE PROJECTION	SCALE NONE
DRAWN BY MRWA	MAT'L:
DATE 10-26-11	
CHK'D KRKE	DWG NO. 09V098YB
	DWG SIZE B