

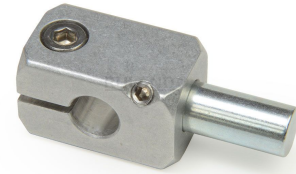

MT10/10-CC90S-A

Ruland T-Connector Mini-Clamp With Stud, Thru Hole 10mm, Stud Diameter 10mm, Stud Length 17mm, Aluminum

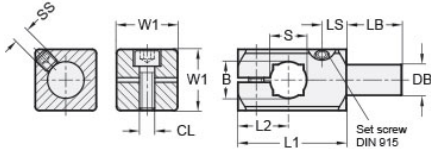

Description

Ruland MT10/10-CC90S-A is a 90 degree connector with stud with a thru hole for 10mm round or 8mm square tube, 10mm stud diameter, 17mm stud length, and 31.5mm body length. It is designed to fit on Ruland tubes and flange bolt bases that begin with MT10. MT10/10-CC90S-A is aluminum and screws are 304 stainless steel for use in most industrial applications. This 90 degree connector clamp with stud is commonly used to support tubes for mounting sensors, screens, reflectors, plexiglass machine guards, and other industrial components. The thru hole allows designers flexibility to reposition the clamp or tube as needed. The stud allows for a more compact installation than other connectors which require the use of a second tube that is significantly longer than the stud. MT10:12-ALK-M5-20 adjustable clamping lever can be used in place of standard clamp hardware for rapid repositioning of the tube or connector without the need for tools. MT10/10-CC90S-A is manufactured by Otto Ganter, inventoried by Ruland, and RoHS3 compliant.

Product Specifications

Thru Hole Diameter B	10 mm	Thru Hole Tolerance	+0.09/-0 mm
Bolt Length LB	17 mm	Bolt Diameter DB	10 mm
Square Thru Hole S	8 mm	Body Length L1	31.5 mm
Edge To Center L2	15.5 mm	Screw To Edge LS	7 mm
Hole Depth T	10 mm	Width & Height W1	20 mm
Clamp Screw CL	M5	Set Screw SS	M5
Weight (lbs)	0.099200	Material Specification	Aluminum
Manufacturer	JW Winco/ Otto Ganter	UPC	634529231838
Country of Origin	Germany	Tariff Code	7609.00.0000
UNSPC	31162908		

Note 1 Performance ratings are for guidance only. The user must determine suitability for a particular application.

Prop 65  **WARNING** This product can expose you to the chemical Nickel (metallic), known to the State of California to cause cancer. For more information go to www.P65Warnings.ca.gov.