

In case of consideration for using Automotive equipment / device which demand high reliability, kindly contact our sales window correspondents.

COUNT	DESCRIPTION OF REVISIONS	BY	CHKD	DATE	COUNT	DESCRIPTION OF REVISIONS	BY	CHKD	DATE
△									
△									
△									

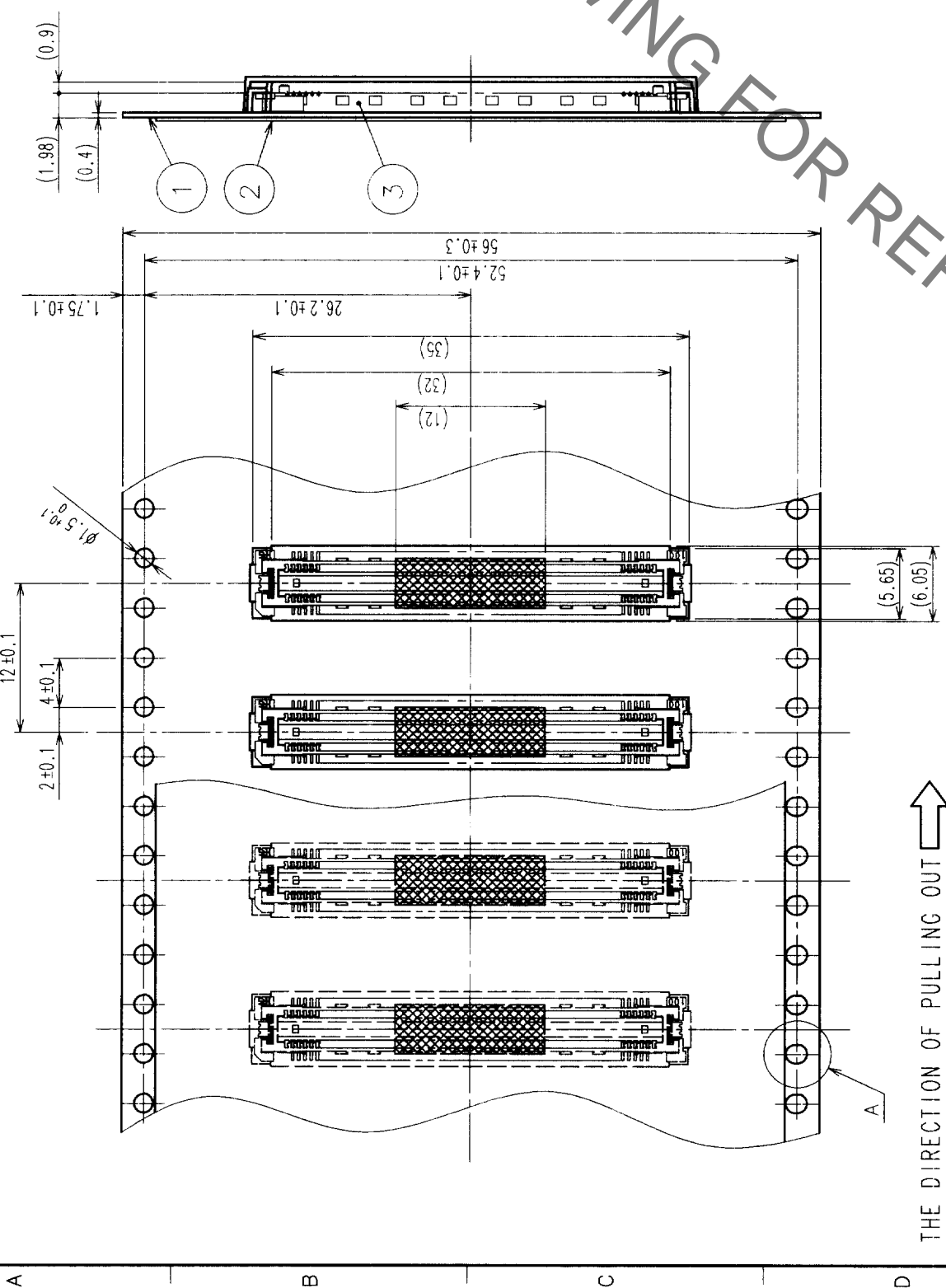

REELED DIMENSION (Free)

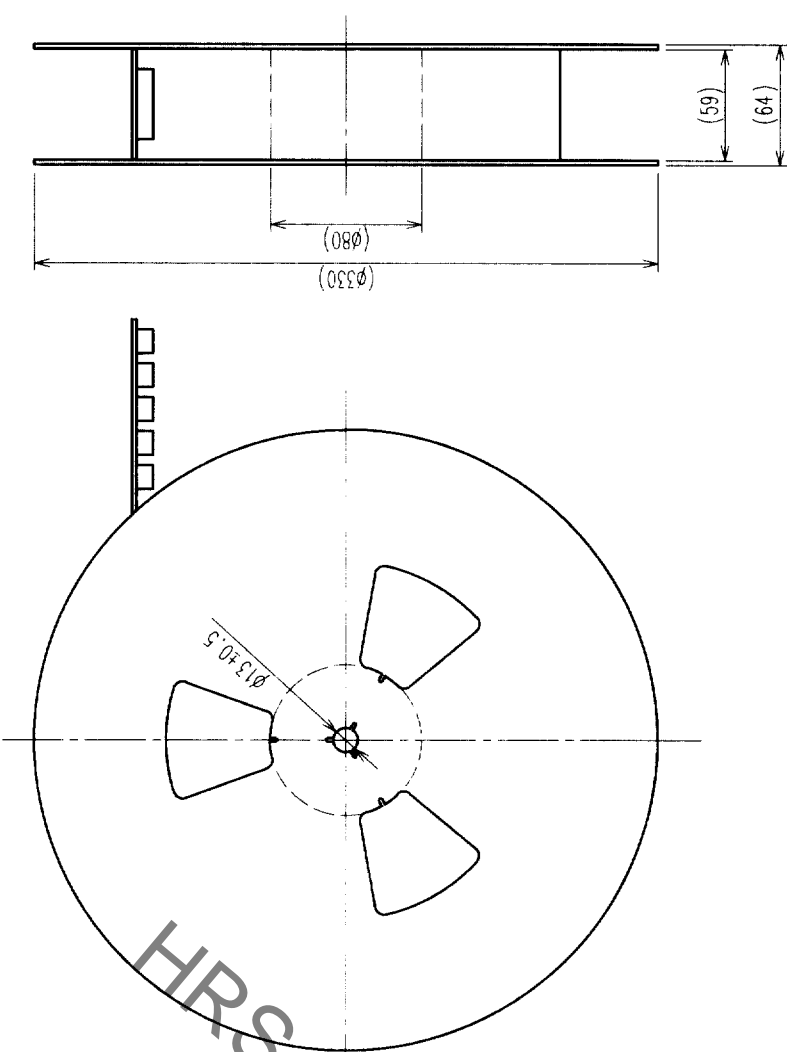

HRS DRAWING FOR REFERENCE

- NOTES
- 1 REEL: 1000 CONNECTORS.
 - 2 MINIMUM 10 COMPARTMENTS FROM BOTH REEL ENDS REMAIN EMPTY.
 - 3 THIS PRODUCT HAS NO POLARITY TO TAPE AND REEL PACKAGING.

A (5:1)

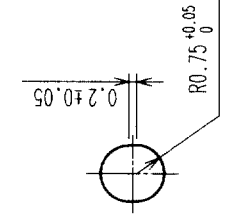

DETAIL FOR VACUUM PICKUP (5:1)

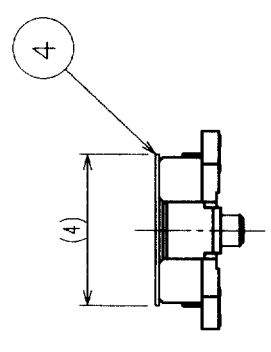

2	PET	TOP COVER TAPE	4	POLYIMIDE	(TAPE FOR VACUUM PICKUP)
1	PS	EMBOSSED CARRIER TAPE	3	(CONNECTOR)	
NO.	MATERIAL	FINISH, REMARKS	NO.	MATERIAL	FINISH, REMARKS
CODE NO. (OLD) CL					
DRAWING FOR PACKING					
DRAWN		DESIGNED		CHECKED	APPROVED
CL		Mitsubishi		M. Shida	T. Yoshimura
99.10.27		99.10.27		99.10.28	99.10.28
DRAWING NO.		PART NO.			
EDC3-152102-02		FX11LA-116P-SV(22)			
SCALE		CODE NO.			
2 : 1		CL573-0044-7-22			
UNITS		HRS			
mm		HIROSE ELECTRIC CO., LTD			

TO	
PCK	