

**MATERIAL**

Thermoplastic elastomer (TPE), black colour.  
Steel internal return spring (RHMA-23).

**COVERING CAPS**

- RHMA-20 / RHMA-23: nickel-plated steel.
- RHMA-25 / RHMA-37: glass-fibre reinforced polyamide based (PA) technopolymer.

**STANDARD EXECUTIONS**

- **RHMA-20:** back mounting, holes for self-tapping screws (DIN 7981) for plate.
- **RHMA-23:** front mounting, holes for M4 countersunk-head screws.
- **RHMA-25:** front mounting, holes for M4 countersunk-head screws.
- **RHMA-37:** front mounting, holes for M5 countersunk-head screws.

**APPLICATIONS**

Suitable to be assembled on instruments, suitcases and similar applications.

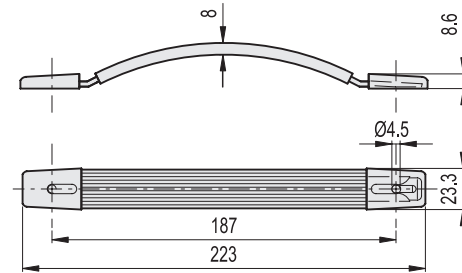

**RHMA-23.205**

METRIC

Code	⚖️
RHMA-23.205.84	65

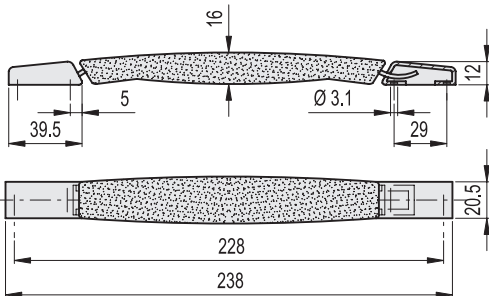

**RHMA-20**

METRIC

Code	⚖️
RHMA-20.228.84	90

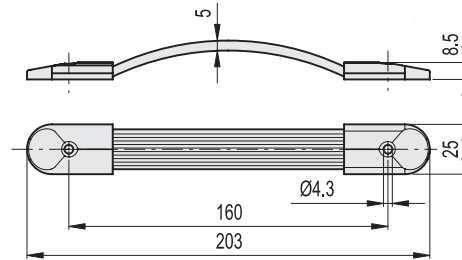

**RHMA-25**

METRIC

Code	⚖️
RHMA-25.160.84	26

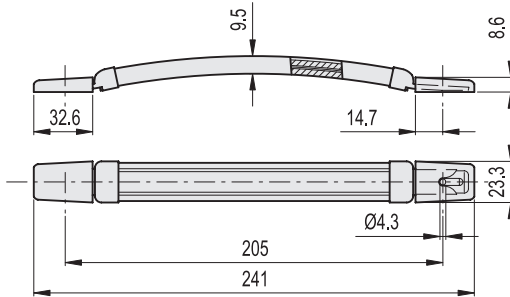

**RHMA-23.187**

METRIC

Code	⚖️
RHMA-23.187.84	60

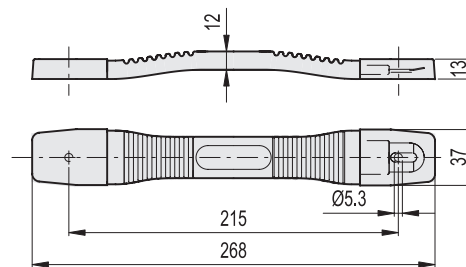

**RHMA-37**

METRIC

Code	⚖️
RHMA-37.215.84	136

