



power contactor, AC-3 9 A, 4 kW / 400 V 2 NO + 2 NC, 230 V AC, 50 Hz 3-pole, Size S0 screw terminal Removable auxiliary switch

product brand name	SIRIUS
product designation	Power contactor
product type designation	3RT2
General technical data	
size of contactor	S0
product extension	
function module for communication	No
auxiliary switch	No
power loss [W] for rated value of the current	
at AC in hot operating state	0.6 W
at AC in hot operating state per pole	0.2 W
without load current share typical	7.6 W
insulation voltage	
of main circuit with degree of pollution 3 rated value	690 V
of auxiliary circuit with degree of pollution 3 rated value	690 V
surge voltage resistance	
of main circuit rated value	6 kV
of auxiliary circuit rated value	6 kV
maximum permissible voltage for safe isolation between coil and main contacts according to EN 60947-1	400 V
shock resistance at rectangular impulse	
at AC	7,5g / 5 ms, 4,7g / 10 ms
shock resistance with sine pulse	
at AC	11,8g / 5 ms, 7,4g / 10 ms
mechanical service life (switching cycles)	
of contactor typical	10 000 000
of the contactor with added electronically optimized auxiliary switch block typical	5 000 000
of the contactor with added auxiliary switch block typical	10 000 000
reference code according to IEC 81346-2	Q
Substance Prohibitance (Date)	10/01/2009
Ambient conditions	
installation altitude at height above sea level maximum	2 000 m
ambient temperature	
during operation	-25 ... +60 °C
during storage	-55 ... +80 °C
relative humidity minimum	10 %
relative humidity at 55 °C according to IEC 60068-2-30 maximum	95 %

Main circuit

number of poles for main current circuit	3
number of NO contacts for main contacts	3
operating voltage	
at AC-3 rated value maximum	690 V
at AC-3e rated value maximum	690 V
operational current	
at AC-1 at 400 V at ambient temperature 40 °C rated value	40 A
at AC-1	
— up to 690 V at ambient temperature 40 °C rated value	40 A
— up to 690 V at ambient temperature 60 °C rated value	35 A
at AC-3	
— at 400 V rated value	9 A
— at 500 V rated value	9 A
— at 690 V rated value	9 A
at AC-3e	
— at 400 V rated value	9 A
— at 500 V rated value	9 A
— at 690 V rated value	9 A
at AC-4 at 400 V rated value	8.5 A
at AC-5a up to 690 V rated value	35.2 A
at AC-5b up to 400 V rated value	7.4 A
at AC-6a	
— up to 230 V for current peak value n=20 rated value	11.4 A
— up to 400 V for current peak value n=20 rated value	11.4 A
— up to 500 V for current peak value n=20 rated value	9.1 A
— up to 690 V for current peak value n=20 rated value	9 A
at AC-6a	
— up to 230 V for current peak value n=30 rated value	7.6 A
— up to 400 V for current peak value n=30 rated value	7.6 A
— up to 500 V for current peak value n=30 rated value	6.1 A
— up to 690 V for current peak value n=30 rated value	6.1 A
minimum cross-section in main circuit at maximum AC-1 rated value	10 mm ²
operational current for approx. 200000 operating cycles at AC-4	
at 400 V rated value	4.1 A
at 690 V rated value	3.3 A
operational current	
● at 1 current path at DC-1	
— at 24 V rated value	35 A
— at 110 V rated value	4.5 A
— at 220 V rated value	1 A
— at 440 V rated value	0.4 A
— at 600 V rated value	0.25 A
● with 2 current paths in series at DC-1	
— at 24 V rated value	35 A
— at 110 V rated value	35 A
— at 220 V rated value	5 A
— at 440 V rated value	1 A
— at 600 V rated value	0.8 A
● with 3 current paths in series at DC-1	

— at 24 V rated value	35 A
— at 110 V rated value	35 A
— at 220 V rated value	35 A
— at 440 V rated value	2.9 A
— at 600 V rated value	1.4 A
• at 1 current path at DC-3 at DC-5	
— at 24 V rated value	20 A
— at 110 V rated value	2.5 A
— at 220 V rated value	1 A
— at 440 V rated value	0.09 A
— at 600 V rated value	0.06 A
• with 2 current paths in series at DC-3 at DC-5	
— at 24 V rated value	35 A
— at 110 V rated value	15 A
— at 220 V rated value	3 A
— at 440 V rated value	0.27 A
— at 600 V rated value	0.16 A
• with 3 current paths in series at DC-3 at DC-5	
— at 24 V rated value	35 A
— at 110 V rated value	35 A
— at 220 V rated value	10 A
— at 440 V rated value	0.6 A
— at 600 V rated value	0.6 A
operating power	
at AC-3	
— at 230 V rated value	2.2 kW
— at 400 V rated value	4 kW
— at 500 V rated value	4 kW
— at 690 V rated value	7.5 kW
at AC-3e	
— at 230 V rated value	2.2 kW
— at 400 V rated value	4 kW
— at 500 V rated value	4 kW
— at 690 V rated value	7.5 kW
operating power for approx. 200000 operating cycles at AC-4	
at 400 V rated value	2 kW
at 690 V rated value	2.5 kW
operating apparent power at AC-6a	
up to 230 V for current peak value n=20 rated value	4.5 kVA
up to 400 V for current peak value n=20 rated value	7.8 kVA
up to 500 V for current peak value n=20 rated value	7.8 kVA
up to 690 V for current peak value n=20 rated value	10.7 kVA
operating apparent power at AC-6a	
up to 230 V for current peak value n=30 rated value	3 kVA
up to 400 V for current peak value n=30 rated value	5.2 kVA
up to 500 V for current peak value n=30 rated value	5.2 kVA
up to 690 V for current peak value n=30 rated value	7.2 kVA
short-time withstand current in cold operating state up to 40 °C	
limited to 1 s switching at zero current maximum	170 A; Use minimum cross-section acc. to AC-1 rated value
limited to 5 s switching at zero current maximum	170 A; Use minimum cross-section acc. to AC-1 rated value
limited to 10 s switching at zero current maximum	122 A; Use minimum cross-section acc. to AC-1 rated value
limited to 30 s switching at zero current maximum	78 A; Use minimum cross-section acc. to AC-1 rated value
limited to 60 s switching at zero current maximum	68 A; Use minimum cross-section acc. to AC-1 rated value
no-load switching frequency	
at AC	5 000 1/h
operating frequency	
at AC-1 maximum	1 000 1/h
at AC-2 maximum	1 000 1/h
at AC-3 maximum	1 000 1/h

at AC-3e maximum	1 000 1/h
at AC-4 maximum	300 1/h
Control circuit/ Control	
type of voltage of the control supply voltage	AC
control supply voltage at AC	
at 50 Hz rated value	230 V
operating range factor control supply voltage rated value of magnet coil at AC	
at 50 Hz	0.8 ... 1.1
apparent pick-up power of magnet coil at AC	
at 50 Hz	65 VA
inductive power factor with closing power of the coil	
at 50 Hz	0.82
apparent holding power of magnet coil at AC	
at 50 Hz	7.6 VA
inductive power factor with the holding power of the coil	
at 50 Hz	0.25
closing delay	
at AC	8 ... 40 ms
opening delay	
at AC	4 ... 16 ms
arcing time	10 ... 10 ms
control version of the switch operating mechanism	Standard A1 - A2
Auxiliary circuit	
number of NC contacts for auxiliary contacts instantaneous contact	2
number of NO contacts for auxiliary contacts instantaneous contact	2
operational current at AC-12 maximum	10 A
operational current at AC-15	
at 230 V rated value	6 A
at 400 V rated value	3 A
at 500 V rated value	2 A
at 690 V rated value	1 A
operational current at DC-12	
at 24 V rated value	10 A
at 48 V rated value	6 A
at 60 V rated value	6 A
at 110 V rated value	3 A
at 125 V rated value	2 A
at 220 V rated value	1 A
at 600 V rated value	0.15 A
operational current at DC-13	
at 24 V rated value	6 A
at 48 V rated value	2 A
at 60 V rated value	2 A
at 110 V rated value	1 A
at 125 V rated value	0.9 A
at 220 V rated value	0.3 A
at 600 V rated value	0.1 A
contact reliability of auxiliary contacts	1 faulty switching per 100 million (17 V, 1 mA)
UL/CSA ratings	
full-load current (FLA) for 3-phase AC motor	
at 480 V rated value	7.6 A
at 600 V rated value	9 A
yielded mechanical performance [hp]	
for single-phase AC motor	
— at 110/120 V rated value	1 hp
— at 230 V rated value	1 hp
for 3-phase AC motor	

— at 200/208 V rated value	2 hp
— at 220/230 V rated value	3 hp
— at 460/480 V rated value	5 hp
— at 575/600 V rated value	7.5 hp
contact rating of auxiliary contacts according to UL	A600 / Q600
Short-circuit protection	
design of the fuse link	
for short-circuit protection of the main circuit	
— with type of coordination 1 required	gG: 63A (690V,100kA), aM: 32A (690V,100kA), BS88: 63A (415V,80kA)
— with type of assignment 2 required	gG: 25A (690V,100kA), aM: 20A (690V,100kA), BS88: 25A (415V,80kA)
for short-circuit protection of the auxiliary switch required	gG: 10 A (500 V, 1 kA)
Installation/ mounting/ dimensions	
mounting position	+/-180° rotation possible on vertical mounting surface; can be tilted forward and backward by +/- 22.5° on vertical mounting surface
fastening method	screw and snap-on mounting onto 35 mm standard mounting rail according to DIN EN 60715
side-by-side mounting	Yes
height	85 mm
width	45 mm
depth	141 mm
required spacing	
with side-by-side mounting	
— forwards	10 mm
— upwards	10 mm
— downwards	10 mm
— at the side	0 mm
for grounded parts	
— forwards	10 mm
— upwards	10 mm
— at the side	6 mm
— downwards	10 mm
for live parts	
— forwards	10 mm
— upwards	10 mm
— downwards	10 mm
— at the side	6 mm
Connections/ Terminals	
type of electrical connection	
for main current circuit	screw-type terminals
for auxiliary and control circuit	screw-type terminals
at contactor for auxiliary contacts	Screw-type terminals
of magnet coil	Screw-type terminals
type of connectable conductor cross-sections	
for main contacts	
— solid	2x (1 ... 2.5 mm ²), 2x (2.5 ... 10 mm ²)
— solid or stranded	2x (1 ... 2.5 mm ²), 2x (2.5 ... 10 mm ²)
— finely stranded with core end processing	2x (1 ... 2.5 mm ²), 2x (2.5 ... 6 mm ²), 1x 10 mm ²
at AWG cables for main contacts	2x (16 ... 12), 2x (14 ... 8)
connectable conductor cross-section for main contacts	
solid	1 ... 10 mm ²
stranded	1 ... 10 mm ²
finely stranded with core end processing	1 ... 10 mm ²
connectable conductor cross-section for auxiliary contacts	
solid or stranded	0.5 ... 2.5 mm ²
finely stranded with core end processing	0.5 ... 2.5 mm ²
type of connectable conductor cross-sections	
for auxiliary contacts	
— solid or stranded	2x (0.5 ... 1.5 mm ²), 2x (0.75 ... 2.5 mm ²)

— finely stranded with core end processing at AWG cables for auxiliary contacts	2x (0.5 ... 1.5 mm ²), 2x (0.75 ... 2.5 mm ²) 2x (20 ... 16), 2x (18 ... 14)
AWG number as coded connectable conductor cross section	
for main contacts	16 ... 8
for auxiliary contacts	20 ... 14

Safety related data

product function	
mirror contact according to IEC 60947-4-1	Yes
positively driven operation according to IEC 60947-5-1	No
B10 value with high demand rate according to SN 31920	450 000
proportion of dangerous failures	
with low demand rate according to SN 31920	40 %
with high demand rate according to SN 31920	73 %
failure rate [FIT] with low demand rate according to SN 31920	100 FIT
T1 value for proof test interval or service life according to IEC 61508	20 y
protection class IP on the front according to IEC 60529	IP20
touch protection on the front according to IEC 60529	finger-safe, for vertical contact from the front
suitability for use	
safety-related switching OFF	Yes

Certificates/ approvals

General Product Approval



[Confirmation](#)



[KC](#)



EMC	Functional Safety/Safety of Machinery	Declaration of Conformity	Test Certificates
-----	---------------------------------------	---------------------------	-------------------



[Type Examination Certificate](#)



[Special Test Certificate](#)

[Type Test Certificates/Test Report](#)

Marine / Shipping



other

[Confirmation](#)



[Confirmation](#)

Further information

Information- and Downloadcenter (Catalogs, Brochures,...)

<https://www.siemens.com/ic10>

Industry Mall (Online ordering system)

<https://mall.industry.siemens.com/mall/en/en/Catalog/product?mlfb=3RT2023-1AP04>

Cax online generator

<http://support.automation.siemens.com/WW/CAXorder/default.aspx?lang=en&mlfb=3RT2023-1AP04>

Service&Support (Manuals, Certificates, Characteristics, FAQs,...)

<https://support.industry.siemens.com/cs/ww/en/ps/3RT2023-1AP04>

Image database (product images, 2D dimension drawings, 3D models, device circuit diagrams, EPLAN macros, ...)

http://www.automation.siemens.com/bilddb/cax_de.aspx?mlfb=3RT2023-1AP04&lang=en

Characteristic: Tripping characteristics, I²t, Let-through current

<https://support.industry.siemens.com/cs/ww/en/ps/3RT2023-1AP04/char>

Further characteristics (e.g. electrical endurance, switching frequency)

<http://www.automation.siemens.com/bilddb/index.aspx?view=Search&mlfb=3RT2023-1AP04&objecttype=14&gridview=view1>

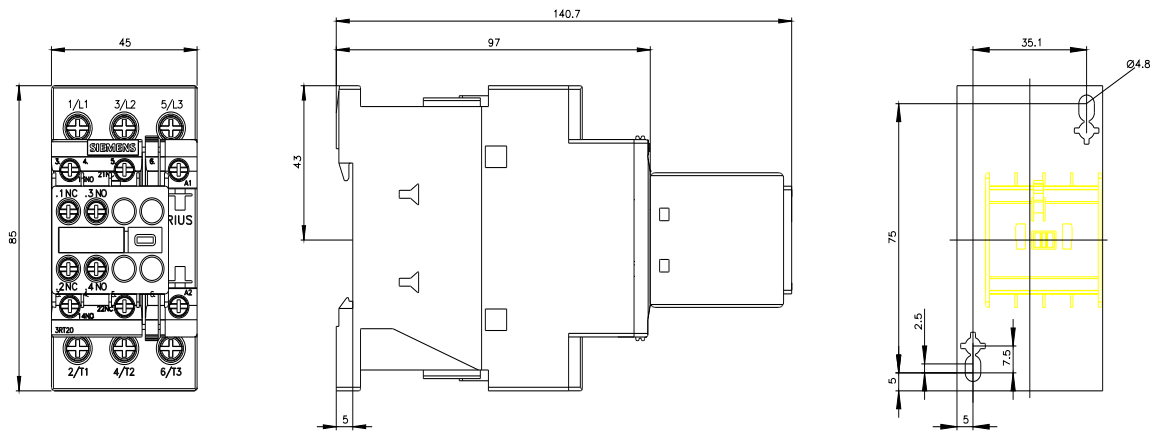

last modified:

6/2/2022 