

Bores for countersunk screws
DIN 7991

Swiveling range

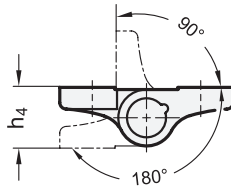

4 Type

A 2x2 bores for countersunk screws

Metric table

Dimensions in: millimeters - inches

2 l_1	3 l_2	d	h_1	h_2	h_3	h_4	l_3	m_1	m_2
60	60	8.3	18.5	7.5	9.5	19	20	36	36
2.36	2.36	0.33	0.73	0.30	0.37	0.75	0.79	1.42	1.42

Specification

- Body
Zinc die-cast **ZD**
Powder coated
Black, RAL 9005, textured finish **●SW**
Silver, RAL 9006, textured finish **●SR**
- Cover cap
Plastic
Technopolymer (Polyacetal POM)
Temperature resistant up to 176 °F (80 °C)
- [Plastic Characteristics](#) → page 2135
- [RoHS compliant](#)

Information

- GN 437.1 hinges fit perfectly into a wide range of application thanks to their timeless design. They are also matched with the GN 437 functional hinge family as complementary hinges.
- see also...**
- [List of Hinge Types](#) → page 1324
 - [Hinges GN 437 \(with Adjustable Friction\)](#) → page 1416
 - [Hinges GN 437.2 \(with Adjustable Lever\)](#) → page 1420
 - [Hinges GN 437.3 \(with Spring-Loaded Return\)](#) → page 1422
 - [Hinges GN 437.4 \(with 4 Indexing Positions\)](#) → page 1418

Accessory

- [Spacer plates GN 2370](#) → page 1380
- [Spacer plates with tapped holes GN 2372](#) → page 1381

How to order	
1	Material
2	Width l_1
3	Length l_2
4	Type
5	Color

GN 437.1-ZD-60-60-A-SR

3.1
3.2
3.3
3.4
3.5
3.6
3.7
3.8
3.9
3.10

