

THIS DRAWING IS UNPUBLISHED. RELEASED FOR PUBLICATION
 © COPYRIGHT - By - ALL RIGHTS RESERVED.

REVISIONS					
P	LTR	DESCRIPTION	ECO	DATE	APVD
E		BASE MATERIAL CHANGE TO PBT	ECN-21-107984	28-JUN-21	XR.L K.T

NOTES:
 1.LOT NO. SYSTEM AS FOLLOWING:

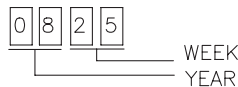

2.GENERAL TOLERANCE AS FOLLOWING:

TOLERANCE	
0~0.99mm	±0.1
1mm~2.99mm	±0.2
3mm MIN.	±0.3

4.FOR THE TIN-PLATING OF THE PINS:
 +0.1mm FOR WIDTH,THICKNESS AND DIAMETER.
 +0.5mm FOR LENGTH.

3.TERMINAL DIMENSION IS NOT INCLUDING SOLDER TIP.

CONNECTION DIAGRAM (BOTTOM VIEW)

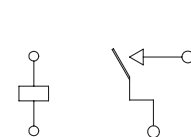

DRILLING DIAGRAM(2/1) (BOTTOM VIEW)

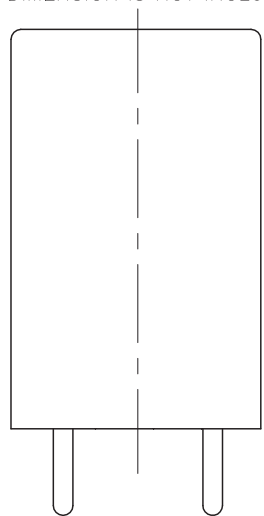
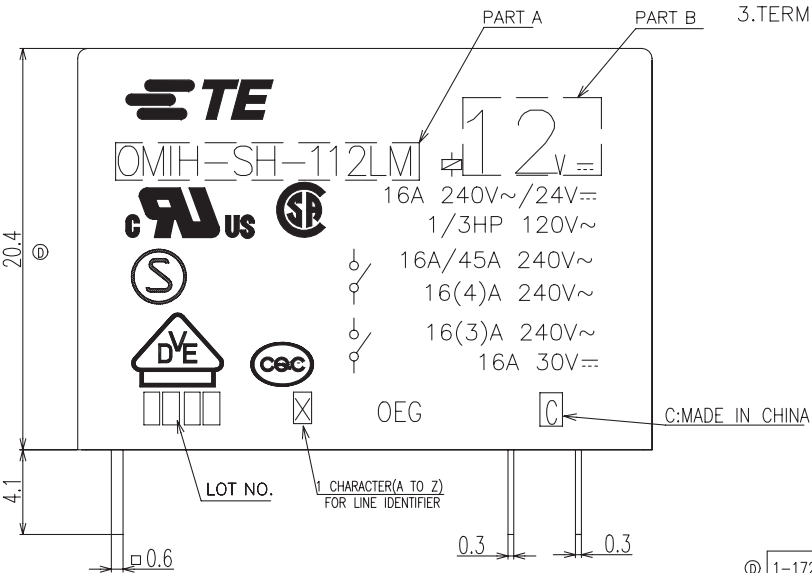
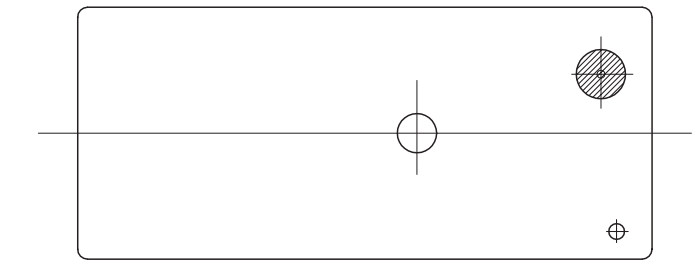
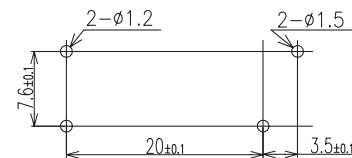

①	1-1721685-5	OMIH-SH-112LM,03060	12	OMIH-SH-112LM	107-84041	3
②	1-1721685-1	OMIH-SH-112LM,03020	12	OMIH-SH-112LM	107-84028	2
	1721685-8	OMIH-SH-112LM,00001	12	OMIH-SH-112LM	107-79006	1
	6-1419121-2	OMIH-SH-112LM	12	OMIH-SH-112LM	107-79006	
TE PART NO	DESCRIPTION	PART B	PART A	PACK. SPEC.	No.	

INCOMBUSTIBILITY	TREATMENT	MATERIAL	DESCRIPTION	ITEM
		UV RESIN	UV SEAL	16
		EPOXY RESIN	SEAL	15
		PBT	CASE	14
		UEW	MAGNETIC WIRE	13
		PBT	BASE	12
		PBT	BOBBIN	11
	SOLDER DIP	CP WIRE	COIL TERMINAL	10
		PPS	CARD	9
		Ag ALLOY	MOVABLE CONTACT	8
		Ag ALLOY	STATIONARY CONTACT	7
		Cu ALLOY	HINGE SPRING	6
	SOLDER DIP	Cu ALLOY	STATIONARY TERMINAL	5
	SOLDER DIP	Cu ALLOY	MOVABLE SPRING	4
		STEEL	CORE	3
		STEEL	ARMATURE	2
		STEEL	YOKE	1

RELAY TYPE

THIS DRAWING IS A CONTROLLED DOCUMENT.		DWN Davey Liu 25JUL2010	TE Connectivity OMIH CUSTOMER DRAWING		
DIMENSIONS: mm		CHK Banghua Yu 26JUL2010			
TOLERANCES UNLESS OTHERWISE SPECIFIED:		APVD Sunny Zhang 27JUL2010	SIZE	CAGE CODE	DRAWING NO
0 PLC ±- 1 PLC ±- 2 PLC ±- 3 PLC ±- 4 PLC ±- ANGLES ±- FINISH		PRODUCT SPEC	WEIGHT	A300779	C=6-1419121-2
MATERIAL		APPLICATION SPEC	SCALE	1:1	SHEET 1 of 1
		WEIGHT	CUSTOMER DRAWING		REV E

