

May.1.2023 Copyright 2023 HIROSE ELECTRIC CO., LTD. All Rights Reserved.
In case of consideration for using Automotive equipment / device which demand high reliability, kindly contact our sales window correspondents.

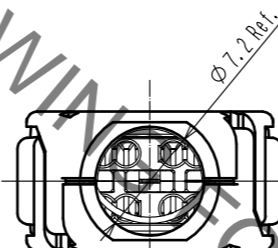
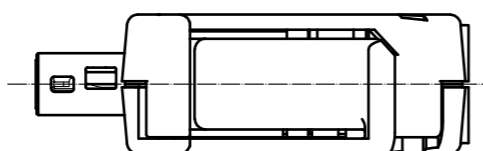
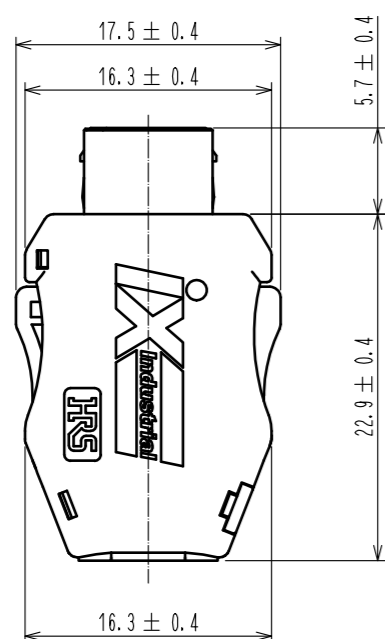
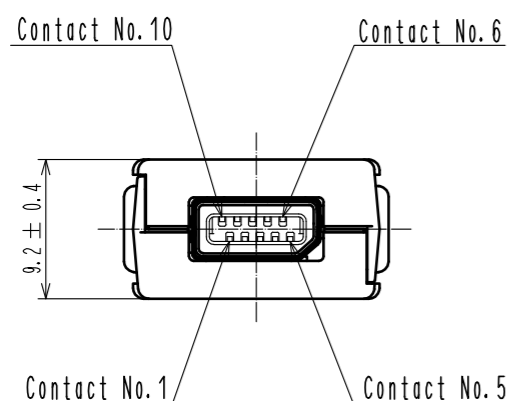
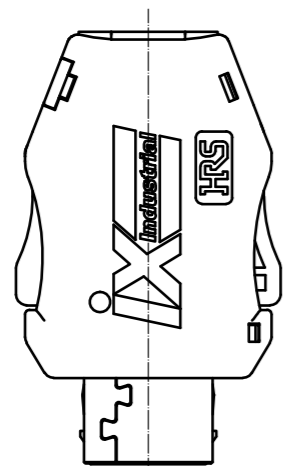

- Notes.
- Recommended cable condition is shown below.
 - A list of compatible cables is available on the Hirose website. When using a non-recommended cable, please contact a Hirose sales representative. Refer to the technical specification (ETAD-E3162) for wiring and assembly procedures. Tool HT803/IXG-8/10S-63-72 is used for cable assembly of IX32G.

Recommended Cable

Items		Recommended Condition
Conductor	Size	AWG22
	Composition	7 stranded
	Material	Annealed copper wire
Insulation O. D.		φ 1.4 to 1.6mm
Braid Shield		Tin plating
Sheath O. D.		φ 6.3 to 7.2mm

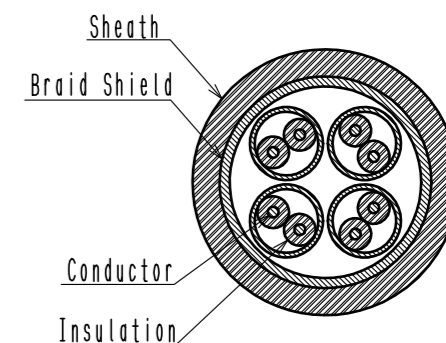

- This product (Type B) is used for non Ethernet applications like signaling, serial or other industrial bus communication systems. Please use Type A for 10/100 Mbit/s and 1/10 Gbit/s Ethernet communication.

Mating Key

Type A

Type B

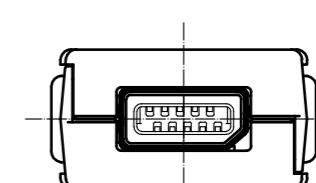
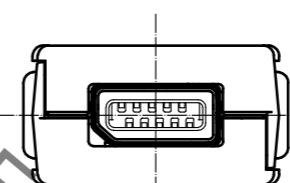

- Excluding the plug unit, this product is packaged separately by the type of parts. The shield shell is packaged prior to bending. (See next page.)

- Cable assembly is possible up to 8pos. Contact No. 3 and 8 do not have a hole to pass the cable through the IDC guide.

4	PA	Black, UL94V-0	8	PC	Dark gray, UL94V-0		
3	Stainless Steel		7	Stainless Steel	Nickel 0.2 μm min		
2	PA	Dark gray, UL94V-0	6	Stainless Steel	Nickel 1 μm min		
1	Copper Alloy	Contact area : Gold 0.2 μm min Wiring area : Gold 0.03 μm min Under plating : Nickel 2 μm min	5	PC	Clear blue, UL94V-0		
NO.	MATERIAL	FINISH . REMARKS	NO.	MATERIAL	FINISH . REMARKS		
UNITS mm		SCALE 2 : 1	COUNT 6	DESCRIPTION OF REVISIONS DIS-E-00006883	DESIGNED MT. YASUDA	CHECKED KI. KAGOTANI	DATE 20211025
HRS HIROSE ELECTRIC CO., LTD.		APPROVED : RI. TAKAYASU 20180730	DRAWING NO. EDC-129830-00-00				
		CHECKED : KI. NAGANUMA 20180727	PART NO. IX32G-B-8S-CV(7.0)				
		DESIGNED : JY. IGA 20180727	CODE NO. CL0251-0043-0-00				
		DRAWN : JY. IGA 20180727					

May.1.2023 Copyright 2023 HIROSE ELECTRIC CO., LTD. All Rights Reserved.
 In case of consideration for using Automotive equipment / device which demand high reliability, kindly contact our sales window correspondents.

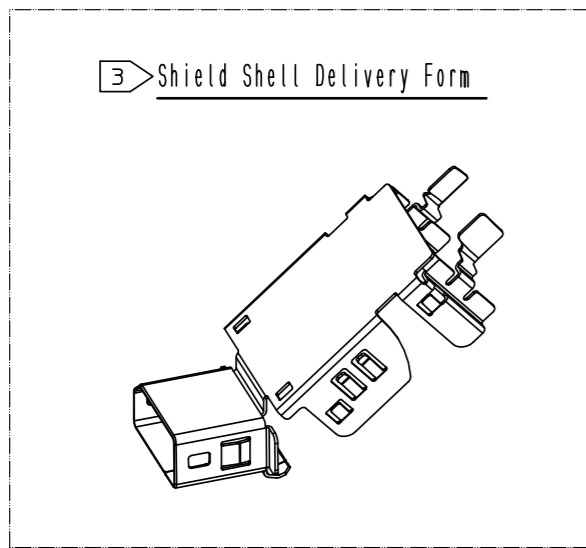

Product Structure

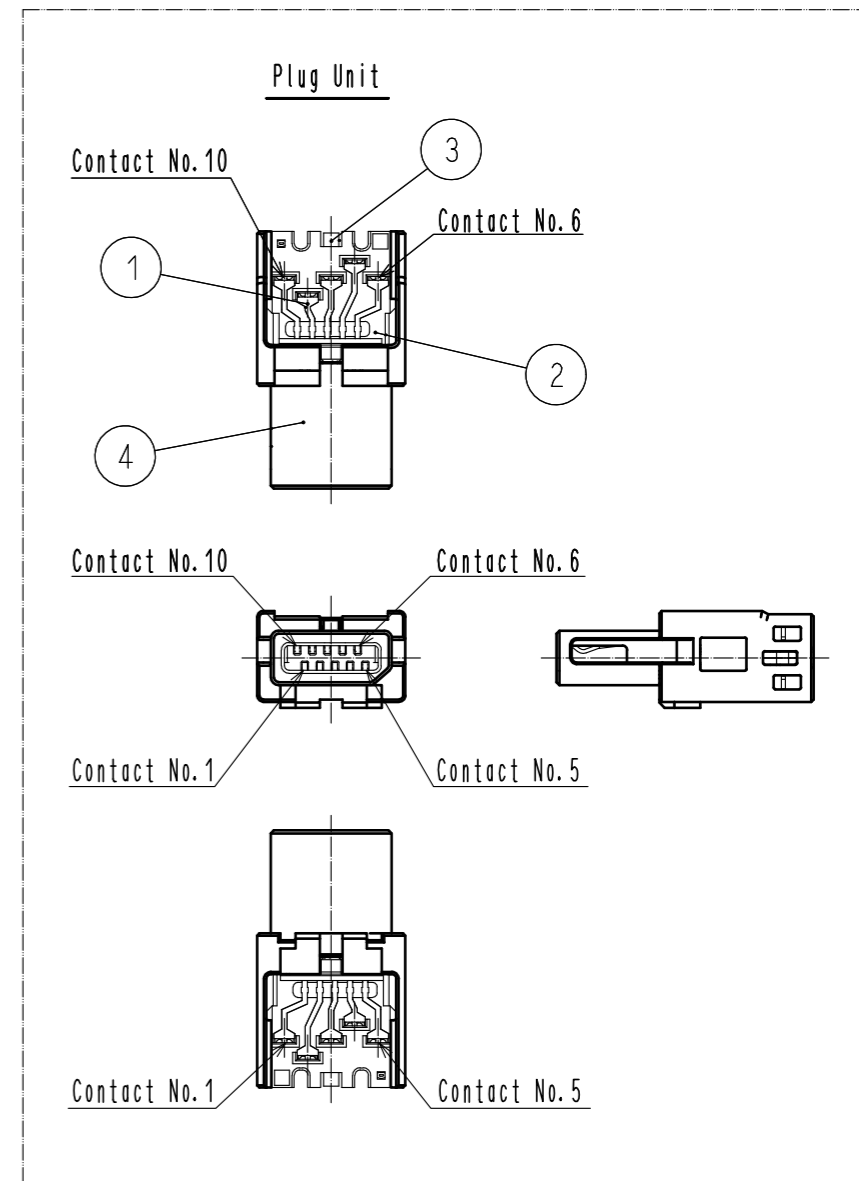
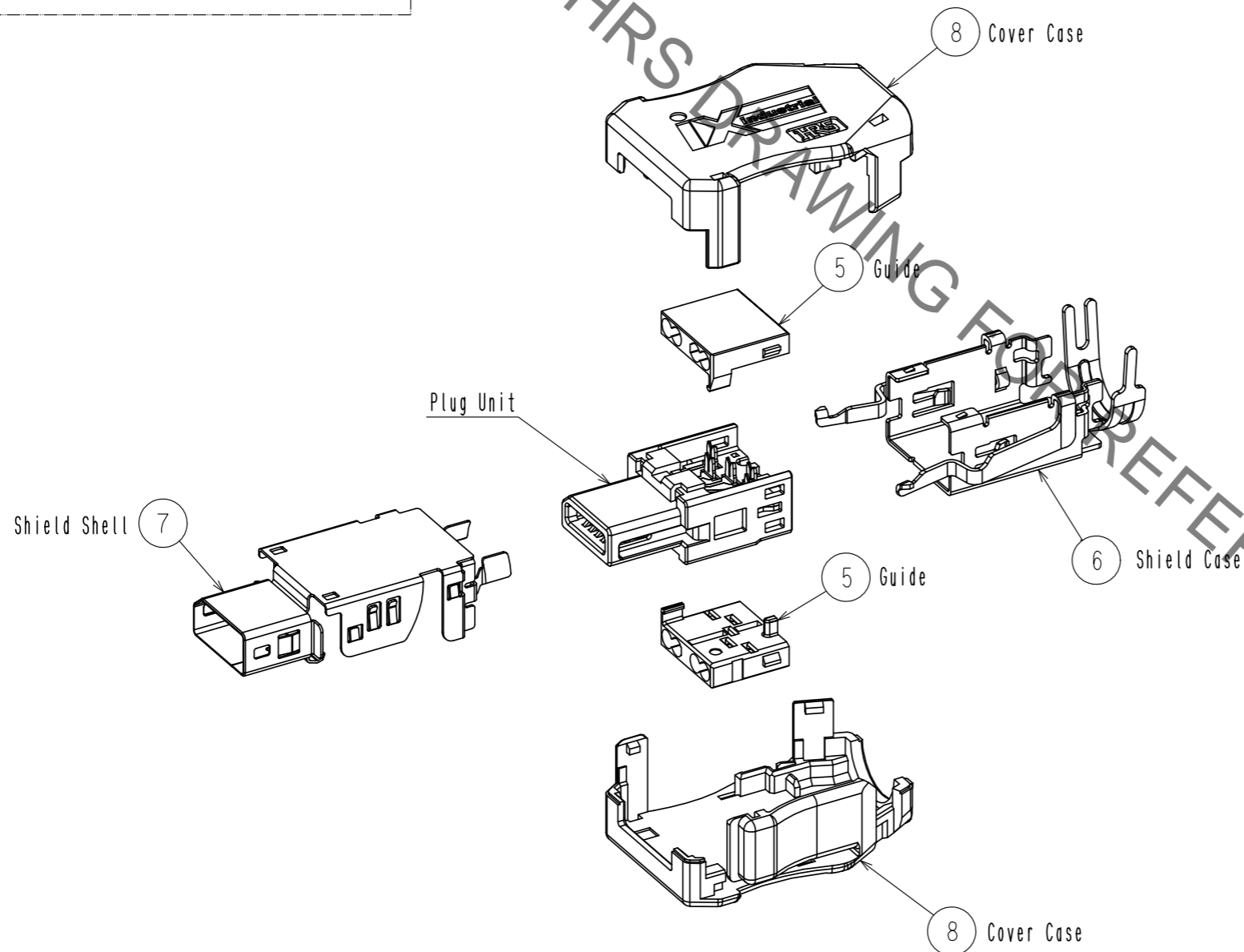

Mated Condition

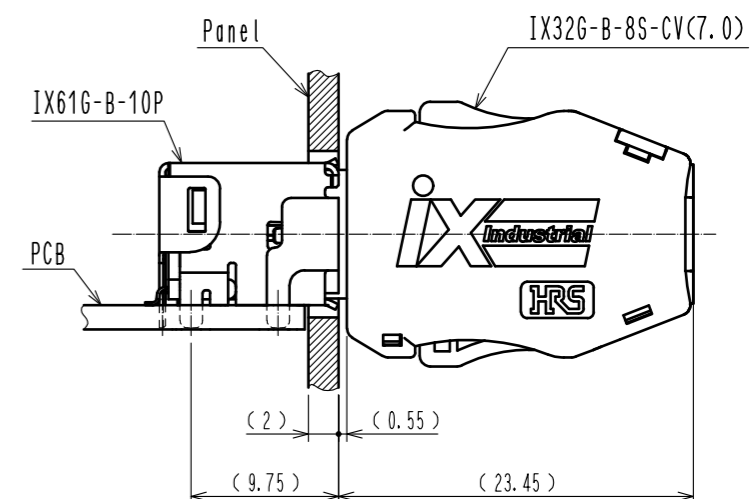

HRS	DRAWING NO.	EDC-129830-00-00
	PART NO.	IX32G-B-8S-CV(7.0)
	CODE NO.	CL0251-0043-0-00
		2/2