

REVISIONS				
P	LTM	DESCRIPTION	DATE	APVD
A		FIRST RELEASE	03JUL2019	SZ SZ
A1		ECO-20-010950	05AUG2020	SZ SZ
A3		ECO-21-002794	01MAR2021	RY SH

NOTES, UNLESS OTHERWISE SPECIFIED

1. MATERIAL:
 HOUSING - THERMOPLASTIC, GLASS PREINFORCED, COLOR, BLACK, UL 94V-0
 CONTACTS - COPPER ALLOY.

2. FINISH:
 MATING AREA - 30u" GOLD OVERALL NICKEL.
 SOLDER TAIL - MATTE TIN OVERALL NICKEL.

3. MARK P/N AND DATA CODE IN APPROX. AREA AS SHOWN.

4. NO TOOLING

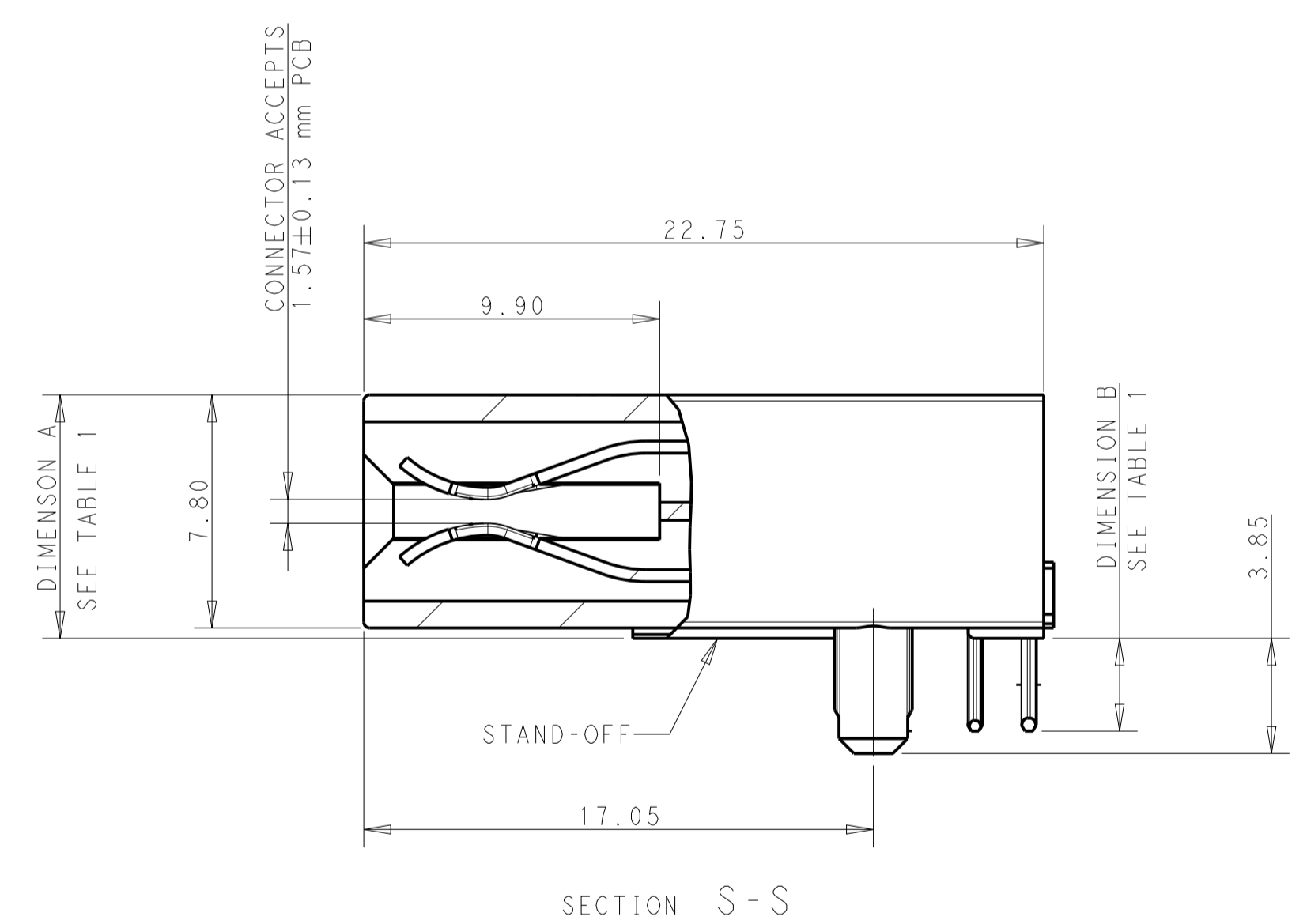
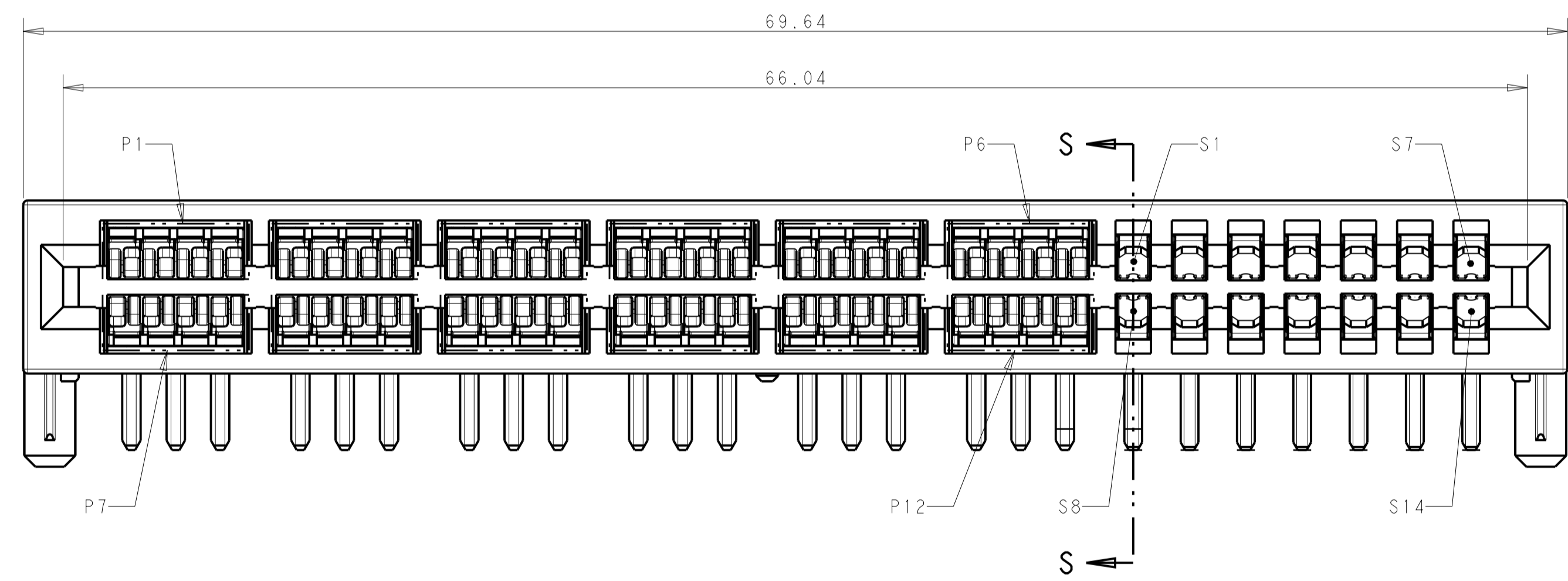
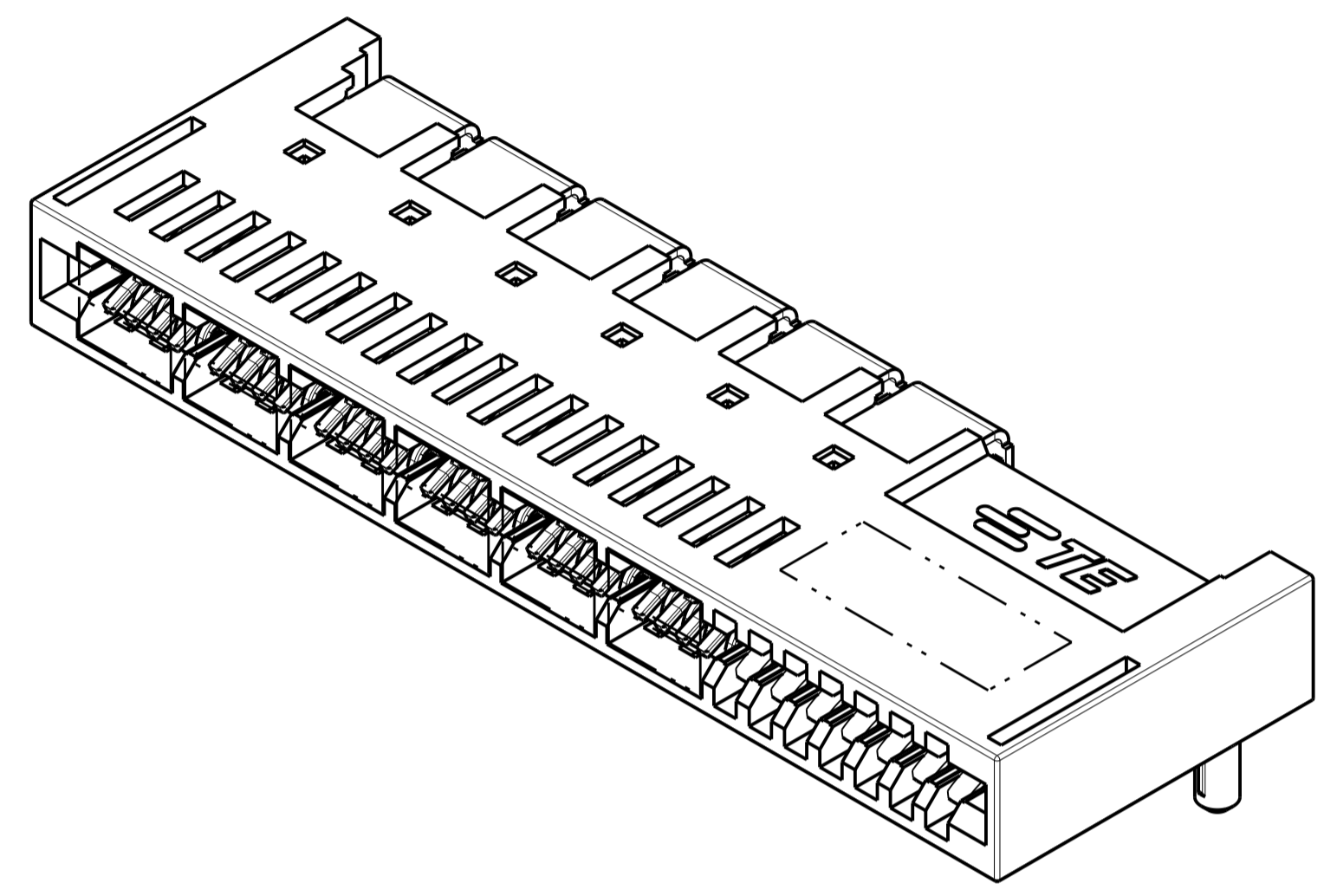
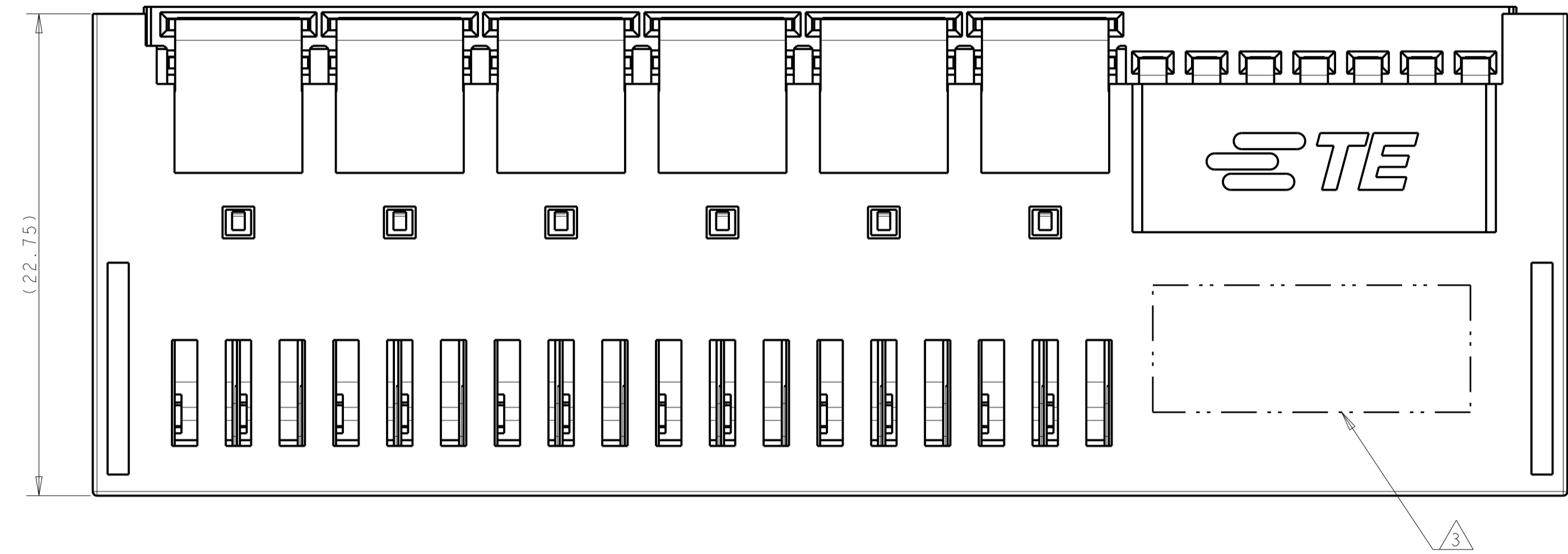
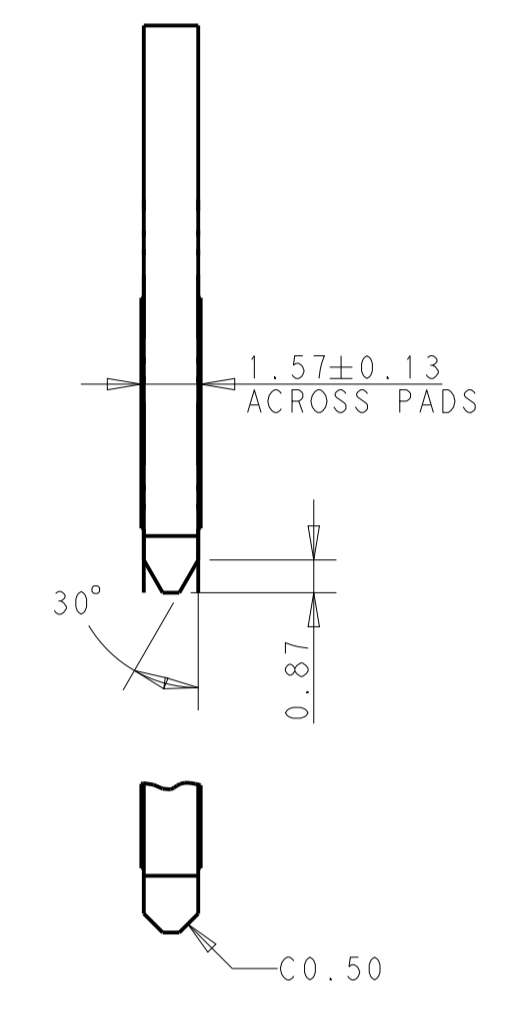
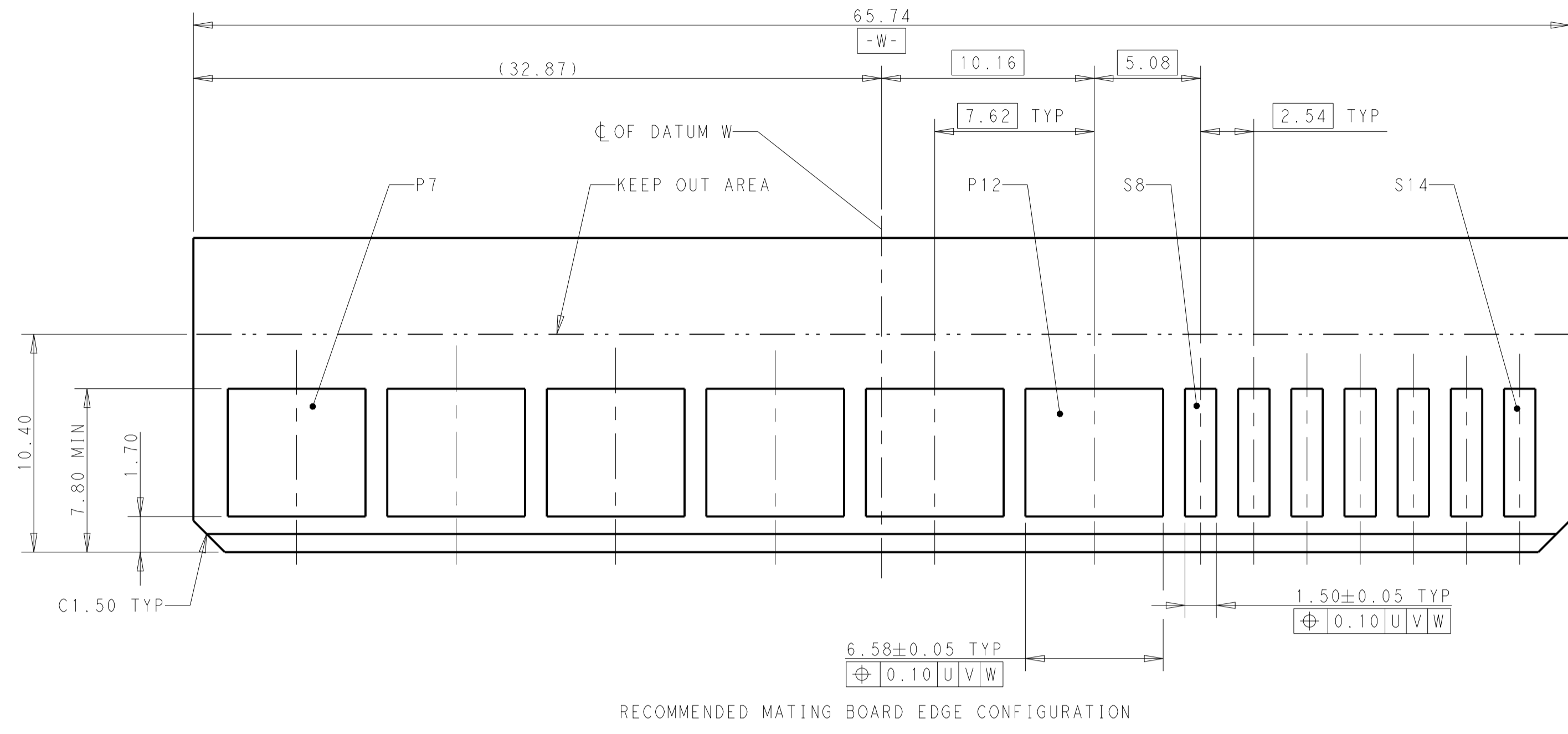

TABLE 1

2.90 ^{+0.35} _{-0.15}	8.35±0.25	2343428-2
3.10 ^{+0.35} _{-0.15}	8.15±0.25	2343428-1
DIMENSION B	DIMENSION A	PART NUMBER

THIS DRAWING IS A CONTROLLED DOCUMENT.		OWN: RICHARD YU	DATE: 01MAR2021	TE Connectivity	
DIMENSIONS: mm		CHK: SEAN HAN	DATE: 01MAR2021	NAME: HDCE PLUS, RIGHT ANGLE	
TOLERANCES UNLESS OTHERWISE SPECIFIED:		APVD: SEAN HAN	DATE: 01MAR2021	PRODUCT SPEC: 2X6 POWER, 2X7 SIGNAL	
0 PLC ±0.25		PRODUCT SPEC: APPLICATION SPEC	DATE: 01MAR2021	SIZE: A1	
1 PLC ±0.50		APPLICATION SPEC: CUSTOMER DRAWING	DATE: 01MAR2021	CAGE CODE: 2343428	
2 PLC ±0.25		WEIGHT: -	DATE: 01MAR2021	RESTRICTED TO: -	
3 PLC ±0.25		SCALE: 5:1	DATE: 01MAR2021	SHEET 1 OF 2	
4 PLC ±0.25		SCALE: 5:1	DATE: 01MAR2021	REV: A3	
ANGLES ±0.25		SCALE: 5:1	DATE: 01MAR2021	REV: A3	
FINISH: -		SCALE: 5:1	DATE: 01MAR2021	REV: A3	

REVISIONS				
P.	LTN.	DESCRIPTION	DATE	APVD.
-	-	SEE SHEET 1	-	-



A1 ALTERNATIVE CHAMFER FOR MATING BOARD EDGE

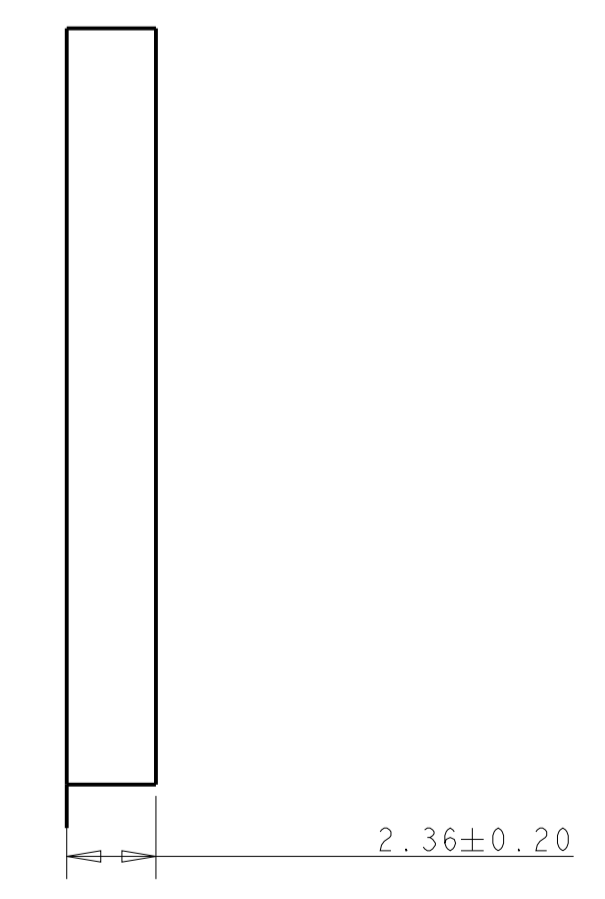
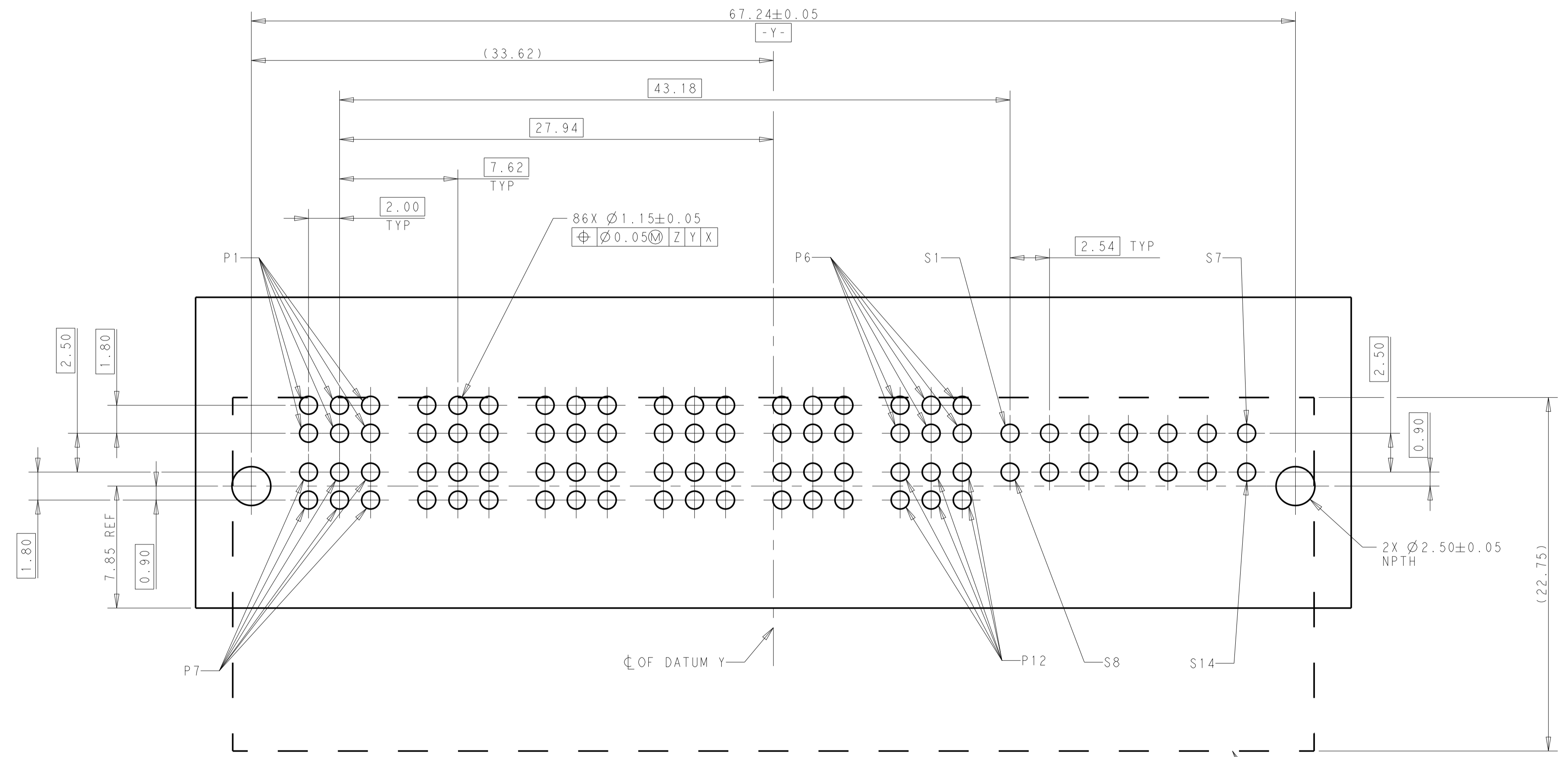
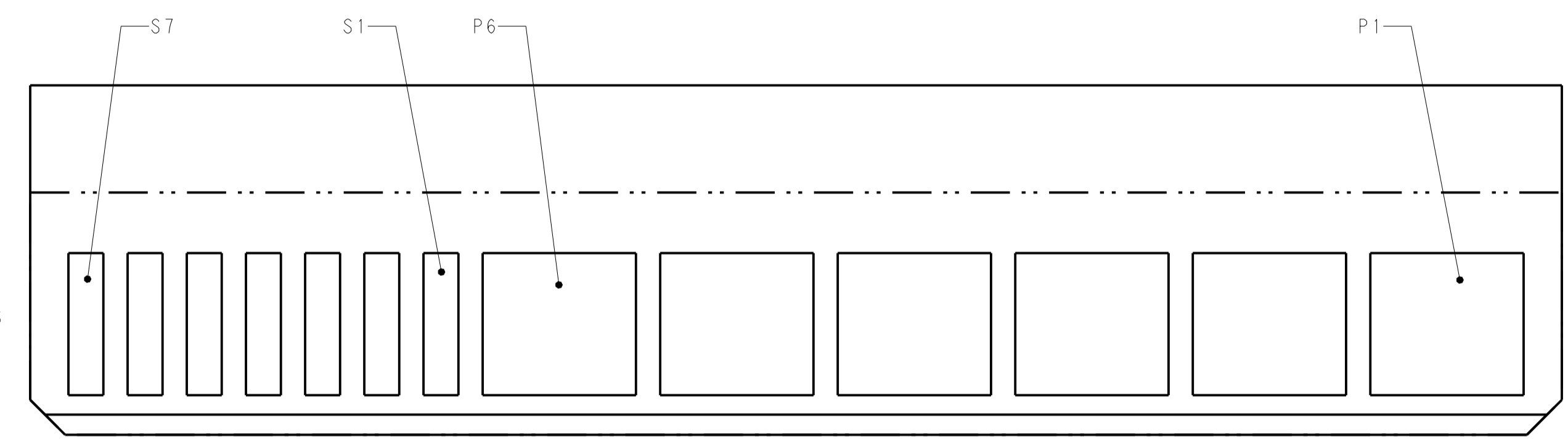

- NOTES FOR MOUNTING BOARD, UNLESS OTHERWISE SPECIFIED:
1. PLATED THROUGH HOLE, FINISHED HOLE SIZE: 1.15mm. DRILL HOLE SIZE: 1.25±0.025mm.
 2. COPPER PLATING THICKNESS: 0.025~0.05mm.
 3. SURFACE FINISH: OSP OR IMMERSION TIN PLATING IS RECOMMENDED.

RECOMMENDED MOUNTING BOARD CONFIGURATION LAYOUT VIEW FROM COMPONENT SIDE

OUTLINE OF CONNECTOR

THIS DRAWING IS A CONTROLLED DOCUMENT.		DWN: RICHARD YU	01MAR2021	 TE Connectivity
DIMENSIONS: mm		CHK: SEAN HAN	01MAR2021	
TOLERANCES UNLESS OTHERWISE SPECIFIED:		NAME: HDCE PLUS, RIGHT ANGLE		RESTRICTED TO
0 PLC ± 1 PLC ±0.20 2 PLC ±0.10 3 PLC ± 4 PLC ±		PRODUCT SPEC: 2X6 POWER, 2X7 SIGNAL		
MATERIAL:		APPLICATION SPEC:		SIZE: A1
FINISH:		WEIGHT:		CAGE CODE: 2343428
		CUSTOMER DRAWING		SCALE: 5:1 SHEET: 2 OF 2 REV: A3