

# P1AD-24MM

2.4mm Male to 2.4mm Male Straight Adapter. Operating to 50 GHz with max VSWR 1.30.

## Product Features

P1AD-24MM is a 50 GHz RF adapter, 2.4mm male to 2.4mm male.

Frequency is DC to 50 GHz with a max VSWR 1.30.



Electrical Specification:  $T_{\text{Ambient}} = 25^{\circ}\text{C}$

Parameter	Frequency Range	Units	Min	Typical	Max	Notes
Frequency Range		GHz	DC		50.0	
Impedance				50.0		
VSWR		1:			1.3	

Mechanical And Environmental Specifications:

Parameter	Description	Notes
Connector 1	2.4mm Male	
Connector 2	2.4mm Male	
RoHS Compliance	Yes	

Drawing

# P1AD-24MM

2.4mm Male to 2.4mm Male Straight Adapter. Operating to 50 GHz with max VSWR 1.30.

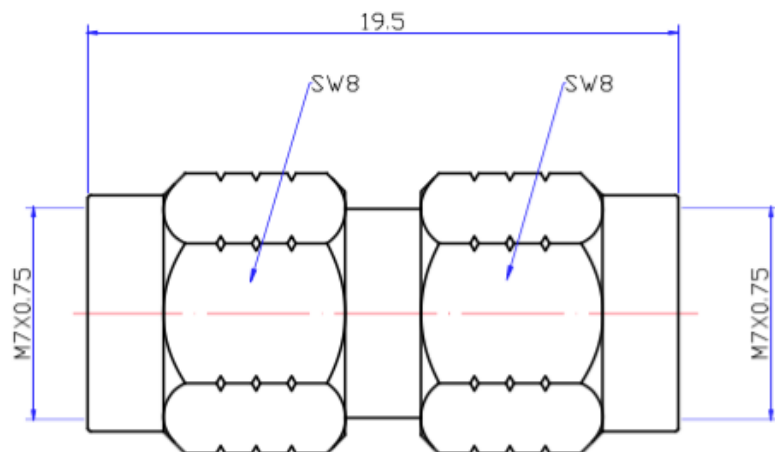

## Product Notes

Temp range : -55 to +85 deg C.