

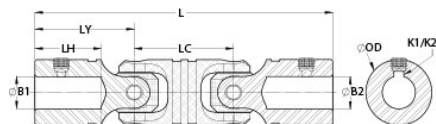

## UDSK20-1/2"-12MM-F

Ruland UDSK20-1/2"-12MM-F, 1/2" x 12mm Double Universal Joint, Friction Bearing, Steel, Set Screw With Keyway, 1.245" (31.6mm) OD, 5.625" (142.9mm) Length



### Description

Ruland UDSK20-1/2"-12MM-F is a double cardan friction bearing universal joint with 0.5000" x 12mm bores, 1/8" x 4mm keyways, 1.245" (31.6mm) OD, 5.625" (142.9mm) length, and 5/16-18 set screws. It is ideal for applications with wide distances between shafts and can accommodate all forms of misalignment. This plain bearing double universal joint is comprised of pins and blocks that are precision machined, selectively heat treated, and ground for high strength, accuracy, and wear resistance. The combination of these components with precision ground and hardened yoke ears allow for a longer lifespan, increased performance in demanding applications, and greater angular misalignment of up to 90° when compared to commodity style double universal joints. UDSK20-1/2"-12MM-F is made from high grade alloy steel for durability and high strength. It can be combined with boot UBOOT20/32-NI-KIT to protect the joints from unwanted contaminants such as dust or water and self lubricate reducing maintenance time. This double cardan universal joint is manufactured in the USA by Belden Universal for strict control of processes.

### Product Specifications

<b>Bore (B1)</b>	0.5000 in	<b>Small Bore (B2)</b>	12 mm
<b>Keyway (K1)</b>	1/8 in	<b>Keyway (K2)</b>	4 mm
<b>B1 Max Shaft Penetration</b>	1.250 in (31.8 mm)	<b>B2 Max Shaft Penetration</b>	1.250 in (31.8 mm)
<b>Joint Outer Diameter (OD)</b>	1.245 in (31.6 mm)	<b>Bore Tolerance</b>	+0.0010 in / -0.0000 in (+0.025 mm / -0.000 mm)
<b>Length (L)</b>	5.625 in (142.9 mm)	<b>Center Yoke Length (LC)</b>	1.875 in (47.6 mm)
<b>Yoke Length (LY)</b>	1.875 in (47.6 mm)	<b>Hub Depth (LH)</b>	1.250 in (31.8 mm)
<b>Broached Set Screw</b>	5/16-18	<b>Screw Finish</b>	Black Oxide
<b>Peak Torque</b>	4,700 in-lb (531.0 Nm)	<b>Rated Torque</b>	940 in-lb (106.2 Nm)
<b>Max Operating Angle</b>	90°	<b>Material Specification</b>	Alloy Steel
<b>Manufacturer</b>	Belden Universal	<b>Country of Origin</b>	USA
<b>Recommended Lubricant</b>	LUBRIPLATE No. 1200-2	<b>Matching Boot Cover</b>	<a href="#">UBOOT20/32-NI-KIT</a>
<b>UPC</b>	63452932481	<b>Tariff Code</b>	8483.60.4000
<b>UNSPC</b>	25173810		

**Note 1** Performance ratings are for guidance only. The user must determine suitability for a particular application.

**Prop 65**  **WARNING** This product can expose you to the chemical Ethylene Thiourea, known to the State of California to cause cancer and birth defects or other reproductive harm. For more information go to [www.P65Warnings.ca.gov](http://www.P65Warnings.ca.gov).