

DO NOT SCALE

DIMENSIONS IN MM.

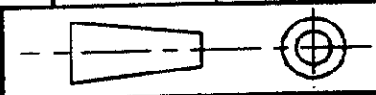

C.A.D. FILE CODE
S. C341300.4

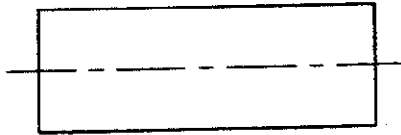
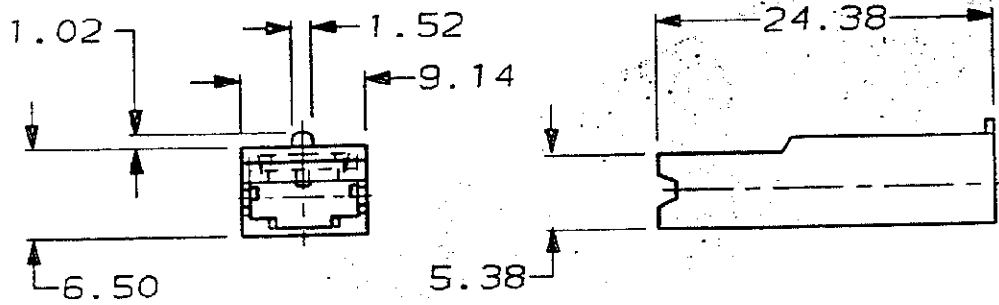

NOTE:-
FOR APPLICATION SPEC. SEE 114-3003.

- ① OBSOLETE PARTS: OBSOLETE CIS STREAMLINING PER D.RENAUD/D.SINISI
- ② OBSOLETE PARTS

BLACK	NYLON 6.6 (FIRE RETARDENT)	① 341300-9
NATURAL	NYLON 6.6 (FIRE RETARDENT)	① 341300-0
BLACK	NYLON 6.6	341300-9
GREY	NYLON 6.6	341300-8
VIOLET	NYLON 6.6	341300-7
BLUE	NYLON 6.6	341300-6
GREEN	NYLON 6.6	341300-5
YELLOW	NYLON 6.6	② 341300-4
ORANGE	NYLON 6.6	341300-3
RED	NYLON 6.6	341300-2
BROWN	NYLON 6.6	341300-1
NATURAL	NYLON 6.6	341300-0

FINISH	MATERIAL	PART NUMBER
CUSTOMER DWG FOR REFERENCE ONLY		RELEASED FOR PUBLICATION
TOLERANCES UNLESS OTHERWISE STATED: DEC ± 0.5 ANGLES ± 1°		DR. D.R. TERRY 6 FEB. 1992 CH. D. BARRATT APP. D. BARRATT
NAME: POSITIVE LOCK RECEPTACLE MKII (.250) INSULATOR		TE TE Connectivity
D2 REV	REVISED PER ECR-19-018127 APPROVED	DATE: 14AUG20
SCALE: 2/1	LOC: E	SIZE: A4
DWG. No. C341300		REV: D2
		SHEET: 1 / 1