

In case of consideration for using Automotive equipment / device which demand high reliability, kindly contact our sales window correspondents.

COUNT	DESCRIPTION OF REVISIONS	BY	CHKD	DATE	COUNT	DESCRIPTION OF REVISIONS	BY	CHKD	DATE
△					△				
△					△				
△					△				

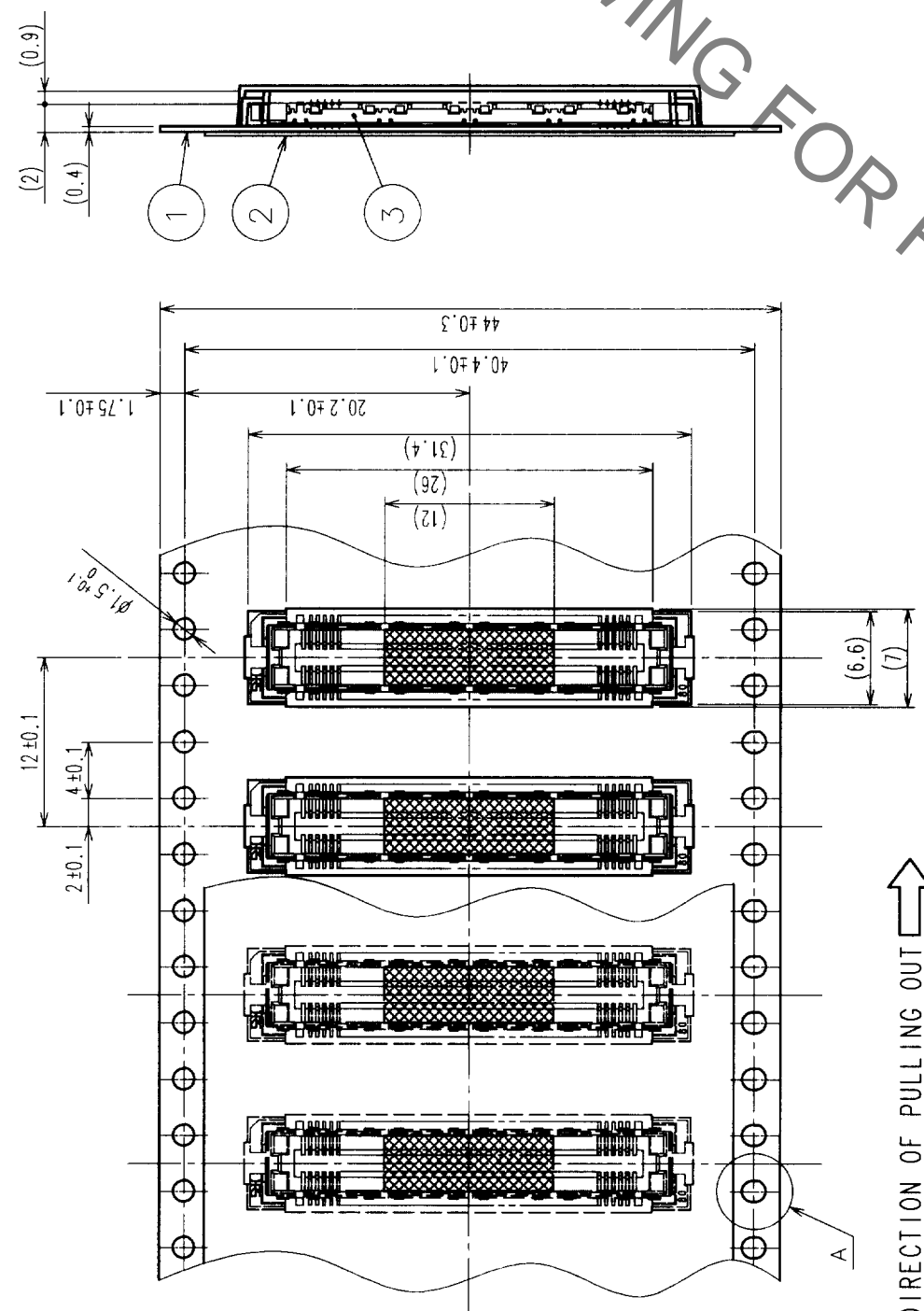

REELED DIMENSION (Free)

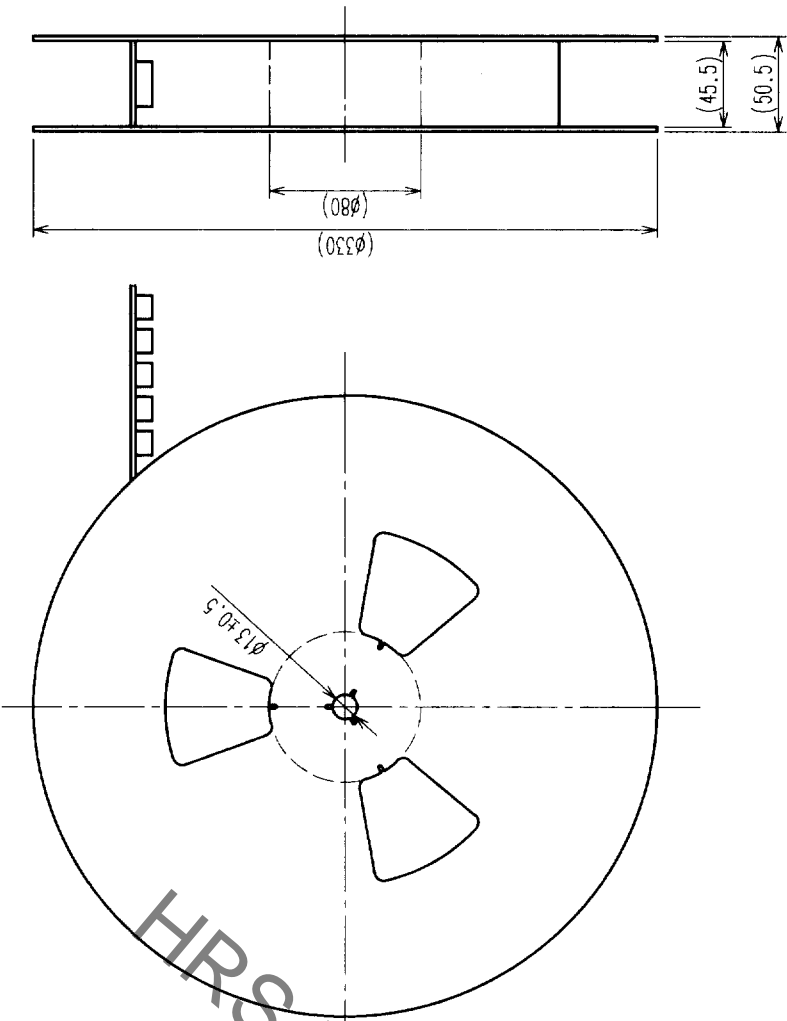

A (5:1)

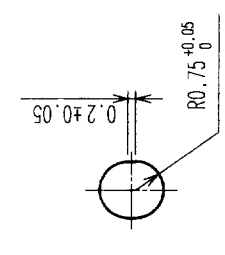

DETAIL FOR TAPE PICKUP (5:1)

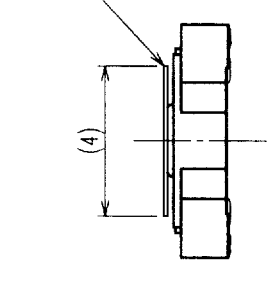

- NOTES 1 1 REEL: 1000 CONNECTORS.
- 2 MINIMUM 10 COMPARTMENTS FROM BOTH REEL ENDS REMAIN EMPTY.
- 3 THIS PRODUCT HAS NO POLARITY TO TAPE AND REEL PACKAGING.

2	PET	TOP COVER TAPE	4	POLYIMIDE	(TAP FOR VACUUM PICKUP)
1	PS	EMBOSSED CARRIER TAPE	3	(CONNECTOR)	
NO.	MATERIAL	FINISH, REMARKS	NO.	MATERIAL	FINISH, REMARKS
CODE NO. (OLD) CL					
DRAWING FOR PACKING		DRAWN Mitsuharu M. Saitoh 1999.10.28		CHECKED Mitsuharu M. Saitoh 1999.10.28	APPROVED T. Yoshimura 1999.10.28
DRAWING NO. EDC3-152121-02		PART NO. FX11LB-92S-SV(22)		RELEASED	
SCALE 2:1		CODE NO. CL573-0153-2-22		UNITS mm	

TO	
PCK	