

**PART NUMBER CODING**

**MATERIAL (INSULATOR/CONTACT)**

**R = BLACK, PPS/PHOSPHOR BRONZE**

OPERATING TEMP: -65°C TO +125°C  
PROCESSING TEMP: 260°C MAX FOR 20 SECONDS

**G = BLACK, PA9T/PHOSPHOR BRONZE**

OPERATING TEMP: -65°C TO +125°C  
PROCESSING TEMP: 260°C MAX FOR 20 SECONDS

**A = BLACK, PPS/BERYLLIUM COPPER**

OPERATING TEMP: -65°C TO +150°C  
PROCESSING TEMP: 260°C MAX FOR 20 SECONDS

**J = BLACK, PA9T/BERYLLIUM COPPER**

OPERATING TEMP: -65°C TO +150°C  
PROCESSING TEMP: 260°C MAX FOR 20 SECONDS

**\*F = BLACK, PPS/SPINODAL**

OPERATING TEMP: -65°C TO +200°C  
PROCESSING TEMP: 260°C MAX FOR 20 SECONDS  
(CONSULT FACTORY FOR SPECIAL SOLDERING GUIDELINES)

**\*X = NATURAL, PEEK/SPINODAL**

OPERATING TEMP: -65°C TO +250°C  
PROCESSING TEMP: 260°C MAX FOR 20 SECONDS  
(CONSULT FACTORY FOR SPECIAL SOLDERING GUIDELINES)

\*AVAILABLE IN 'M' PLATING ONLY

**NUMBER OF POSITIONS**  
(CONTACTS PER ROW)

**PLATING**

**ALL PLATINGS ARE LEAD FREE AND HAVE .000050" NICKEL UNDERPLATE**

CONTACT SURFACE

B = .000010" GOLD

C = .000030" GOLD

M = .000030" GOLD

TERMINATION

.000100" PURE TIN, MATTE

.000100" PURE TIN, MATTE

.000010" GOLD OVERALL

**MOUNTING STYLE**

D = FLUSH MOUNTING (PAGE 1)

N = NO MOUNTING EARS (PAGE 2)

T = FLUSH MOUNTING, WITH THREADED INSERTS (PAGE 2)

Q = STRADDLE MOUNT (PAGE 2)

**REVISIONS**

REV.	ECO. NO	DESCRIPTION	DATE	BY
E	4402	UPDATED DIMENSION TABLE TO INCLUDE ALL POSITIONS	7/22/2021	NBY
F	4614	ADD 'X' MATERIAL, INCREASE CONTACT SURFACE RADIUS BIGGER	1/5/2023	JH
H	4626	UPDATE NOTE 11 (WAS '500 CYCLES'), UPDATE NOTE 8 (REMOVE 'PER CONTACT')	2/9/2023	MM

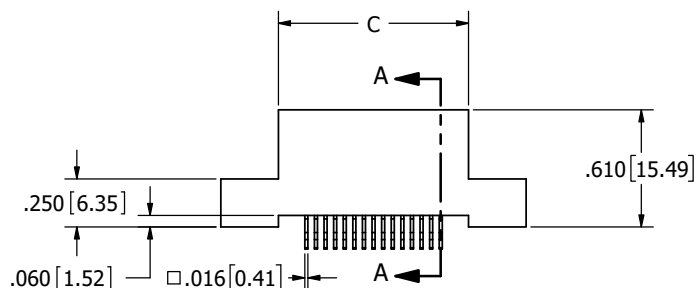
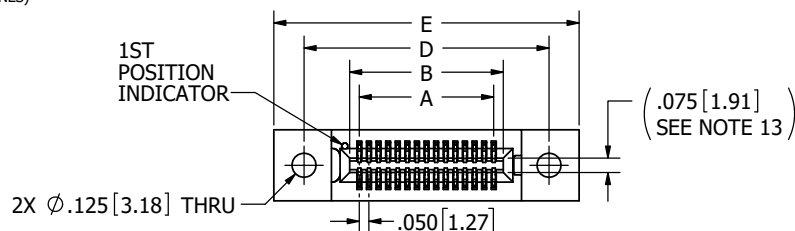
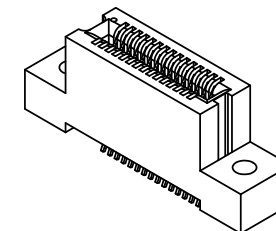

**\_\_ B \_\_ DYRD**

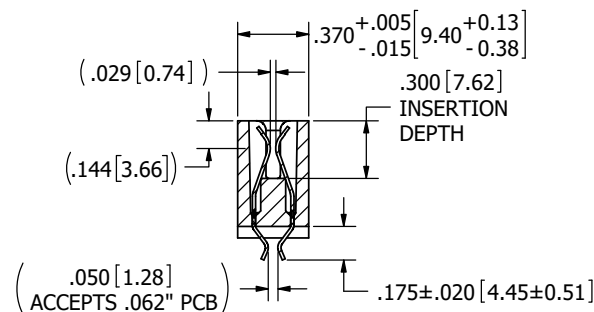

**SECTION A-A**

**NOTES:**

- INSULATOR MATERIAL: SEE PART NUMBER CODING
- CONTACT MATERIAL: SEE PART NUMBER CODING
- PLATING: SEE PART NUMBER CODING
- OPERATING TEMPERATURE: SEE PART NUMBER CODING
- PROCESSING TEMP: SEE PART NUMBER CODING
- UL FLAMMABILITY RATING: 94V-0
- OPERATING VOLTAGE: 300 VAC
- CURRENT RATING: 1 AMP
- CONTACT RESISTANCE: 30 MILLI OHMS MAX
- INSULATION RESISTANCE: 5000 MEGA OHMS
- DURABILITY: 5000 CYCLES MINIMUM
- CONNECTOR IDENTIFICATION: THE PART SHALL BE MARKED WITH A PART NUMBER AND LOT CODE
- BOARD THICKNESS ACCOMMODATED: .062 ± .008 [1.57 ± 0.20]
- INSERTION FORCE: 6 OZ MAX PER CONTACT PAIR WHEN USING A .062 [1.57] TEST BLADE  
INTERNAL INSPECTION TO BE PER SULLINS WORK INSTRUCTION WI-8.6-03
- WITHDRAWAL FORCE: 1/2 OZ MIN PER CONTACT PAIR USING .062 [1.57] TEST BLADE



RoHS COMPLIANT

UNLESS OTHERWISE SPECIFIED: DIMENSIONS ARE IN INCHES (MM)		DRAWN	DATE	NAME	
			01/06/10	TT	
TOLERANCES: ANGULAR: ± 1° DECIMALS .XX = ± .02 [5] .XXX = ± .005 [13] .XXXX = ± .0005 [013]					THE INFORMATION HEREIN CONTAINS PROPRIETARY INFORMATION OF SULLINS ELECTRONICS AND IS NOT TO BE REPRODUCED, USED OR DISCLOSED TO OTHERS FOR ANY PURPOSE EXCEPT AS SPECIFICALLY AUTHORIZED IN WRITING BY AN OFFICER OF SULLINS ELECTRONICS.
TITLE EDGE CARD, .050" CC, HP					REV
PART NUMBER __ B __ DYR __					REV
SIZE	CAGE CODE	DWG. NO.	REV		
C	54453	C11421	H		
SCALE: 2:1			SHEET 1 OF 3		

**CUSTOMER COPY**

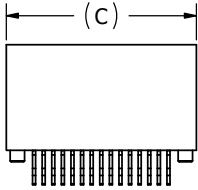
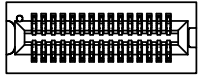

**\_\_B\_\_DYRN**

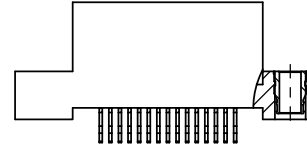
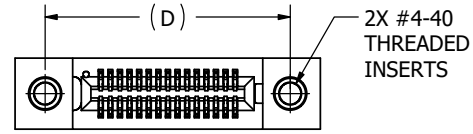

**\_\_B\_\_DYRT**

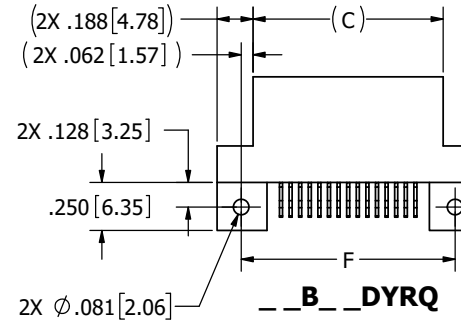

**\_\_B\_\_DYRQ**

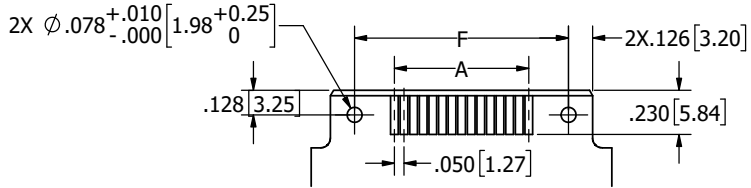
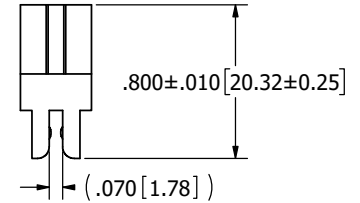

**PCB LAYOUT RECOMMENDED  
(FOR \_\_B\_\_DYRQ)**

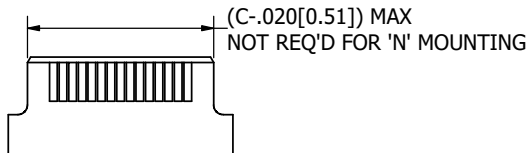

**PCB LAYOUT RECOMMENDED  
(FOR \_\_B-DYRN, \_\_B-DYRD OR \_\_B-DYRT)**

**CUSTOMER COPY**



RoHS COMPLIANT

UNLESS OTHERWISE SPECIFIED:  
DIMENSIONS ARE IN INCHES [MM]

TOLERANCES:  
ANGULAR: ± 1°  
DECIMALS  
.XX = ± .02 [5]  
.XXX = ± .005 [13]  
.XXXX = ± .0005 [013]

DRAWN	DATE	NAME
	01/06/10	TT
<small>THE INFORMATION HEREIN CONTAINS PROPRIETARY INFORMATION OF SULLINS ELECTRONICS AND IS NOT TO BE REPRODUCED, USED OR DISCLOSED TO OTHERS FOR ANY PURPOSE EXCEPT AS SPECIFICALLY AUTHORIZED IN WRITING BY AN OFFICER OF SULLINS ELECTRONICS.</small>		

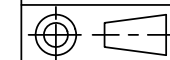

<b>SULLINS CONNECTOR SOLUTIONS</b>			
TITLE <b>EDGE CARD, .050" CC, HP</b>			
PART NUMBER <b>__B__DYR__</b>			
SIZE	CAGE CODE	DWG. NO.	REV
C	54453	C11421	H
SCALE: 2:1			SHEET 2 OF 3

