

E20990

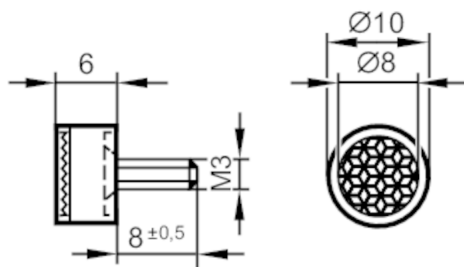

Reflector for retro-reflective laser sensors

REFLECTOR LASER TS-10



1 M3 8 mm deep

Application

Design round, for retro-reflective laser sensors, M3

Operating conditions

Ambient temperature [°C] -10...60

Mechanical data

Weight [g] 2.3

Dimensions [mm] $\varnothing 10 / L = 6$

Reflector surface [mm] $\varnothing 8$

Materials screw: stainless steel (1.4401 / 316); Spring washer: stainless steel (1.4401 / 316); nut: stainless steel (1.4401 / 316); front panel: PMMA; base: ABS

Remarks

Pack quantity 1 pcs.