

Commercial Grade Terminations

Features

- Best combination of price and performance
- For general commercial use
- Up to 18 GHz operation
- Gold and tri-alloy plated brass construction
- SMA, N, TNC Male 2W average power

Applications

- Cellular base stations
- Public safety systems
- Wi-Fi networks hardware
- Active antenna systems
- 5G network hardware
- GPS systems

Part Numbers

| Part Number | Termination Type | Frequency |
|--------------------|----------------------|-----------|
| CGT-1180-M0-SMA-09 | SMA Male Termination | DC-18 GHz |
| CGT-1180-M0-NNN-34 | N Male Termination | DC-18 GHz |
| CGT-1060-M0-TNC-34 | TNC Male Termination | DC-6 GHz |

Specifications

Electrical

| Part Number | CGT-1180-M0-SMA-09 | CGT-1180-M0-NNN-34 | CGT-1060-M0-TNC-34 |
|------------------------|--------------------|--------------------|--------------------|
| Frequency of Operation | DC-18 GHz | DC-18 GHz | DC-6 GHz |
| Impedance | 50Ω (Nominal) | 50Ω (Nominal) | 50Ω (Nominal) |
| VSWR | 1.20:1 (max.) | 1.18 (max.) | 1.25 (max.) |
| Input Power (at 25°C) | 2W (CW) | 2W (CW) | 2W (CW) |

Materials and Finish

| | CGT-1180-M0-SMA-09 | CGT-1180-M0-NNN-34 | CGT-1060-M0-TNC-34 |
|---------------------|--------------------|------------------------|------------------------|
| Housing | Gold plated brass | Tri-Alloy plated brass | Tri-Alloy plated brass |
| Male Center Contact | Gold plated brass | Gold plated brass | Gold plated brass |

Environmental

| Operating Temperature | -55°C to 85°C | -55°C to 85°C | -55°C to 85°C |
|-----------------------|---------------|---------------|---------------|
|-----------------------|---------------|---------------|---------------|

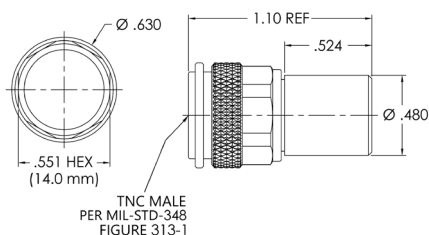
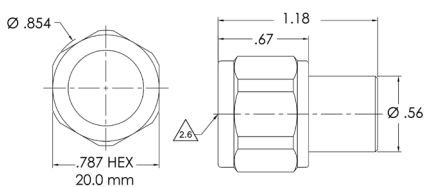
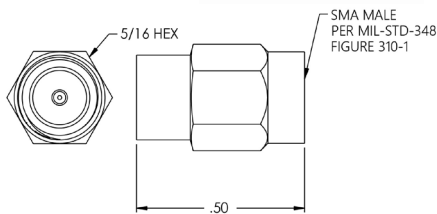
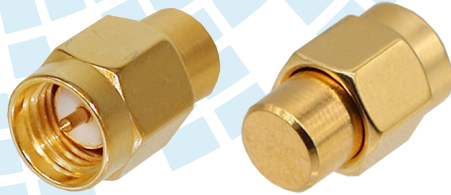

Asia Pacific
+86 21 5442 7668
ccs.asia.sales@as.cinch.com

Europe, Middle East & Africa
+44 (0) 1245 342060
cinchconnectivity@eu.cinch.com

North America
+1 507 833 8822
ccsorders@us.cinch.com

belfuse.com/cinch