

PANDUIT PART NUMBER	'A' IN (mm) [REF]	'B' IN (mm)	'T' IN (mm)	LENGTH (M) (REF)	WEIGHT lbs (g) / meter
T12F-10J T12F-10JO	0.125 (3.2)	0.218 ±0.047 (5.5 ±1.2)	0.030 ±0.006 (0.76±0.15)	10.0	0.131 (59.53)
T19F-10J T19F-10JO	0.188 (4.8)	0.250 ±0.047 (6.4 ±1.2)	0.032 ±0.008 (0.81±0.20)		0.197 (89.36)
T25F-10J T25F-10JO	0.250 (6.4)	0.375 ±0.047 (9.5±1.2)	0.040 ±0.008 (1.02±0.20)		0.361 (163.7)
T38F-10J T38F-10JO	0.375 (9.5)	0.437 ±0.047 (11.1±1.2)	0.055 ±0.010 (1.4±0.25)		0.722 (327.5)
T50F-10J T50F-10JO	0.500 (12.7)	0.500 ±0.047 (12.7±1.2)	0.060 ±0.016 (1.52±0.41)		1.083 (491.24)
T62F-10J T62F-10JO	0.625 (15.9)	0.625 ±0.047 (15.9±1.2)	0.062 ±0.020 (1.57±0.51)		1.44 (654.8)
T75F-5J T75F-5JO	0.750 (19.1)	0.875 ±0.047 (22.2±1.2)	0.065 ±0.020 (1.65±0.51)	5.0	1.84 (834.61)
T100F-5J T100F-5JO	1.000 (25.4)	1.125 ±0.047 (28.6±1.2)	0.070 ±0.020 (1.78±0.51)		2.69 (1220.2)

NOTES:

1. MATERIAL:

T**F-10J & T**F-5J POLYETHYLENE, NATURAL

T**F-10JO & T**F-5JO WEATHER RESISTANT POLYETHYLENE, BLACK

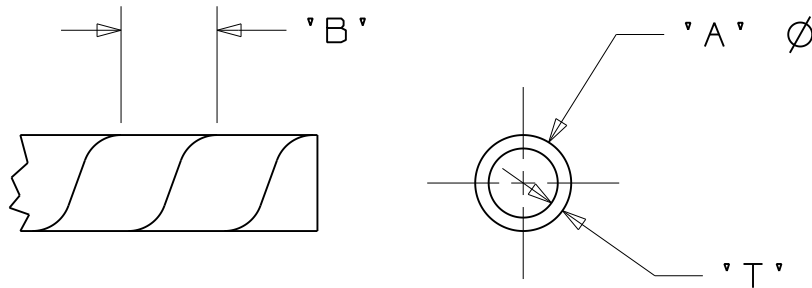

DIMENSIONS IN BRACKETS ARE METRIC [mm]	
CAD FILENAME/LAYERS G03597BW_DC_SWRAP/00B	
TINLEY PARK, ILLINOIS	
5 and 10 METER PACK SPIRAL WRAP	
UNLESS OTHERWISE SPECIFIED, DIMENSIONAL TOLERANCES ARE: (.X) ±0.05 (1.3) (.XXX) ±0.010 (0.25) (.XX) ±0.02 (0.5) ANGLES ±5°	UNLESS OTHERWISE SPECIFIED, ALL DIMENSIONS ARE GIVEN IN INCHES, THIRD ANGLE PROJECTION.
DRAWN BY JAD	MAT'L: N/A
DATE 08/01/08	POLYETHYLENE
CHK'D	SCALE GB3597BW A SIZE

REV	DATE	BY	CHK	DESCRIPTION	ECN - R	CUST	SUP
00B	08/19/08	JAD		UPDATE PART NUMBERS, ADD NOTE 1	GB3597BW	00B	
00A	08/01/08	JAD		INITIAL RELEASE	GB3597BW	00A	