

P	LTR	DESCRIPTION	DATE	DWN	APVD
E		REVISED PER ECN 22-153675	16MAY2022	OG	FA

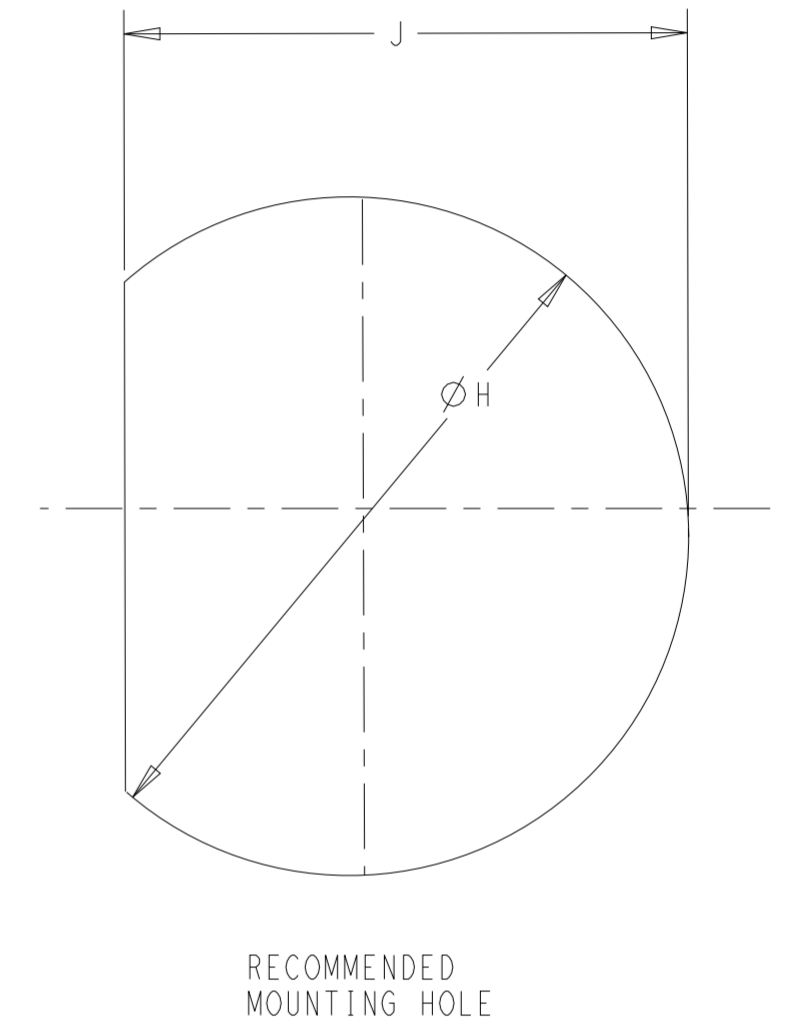
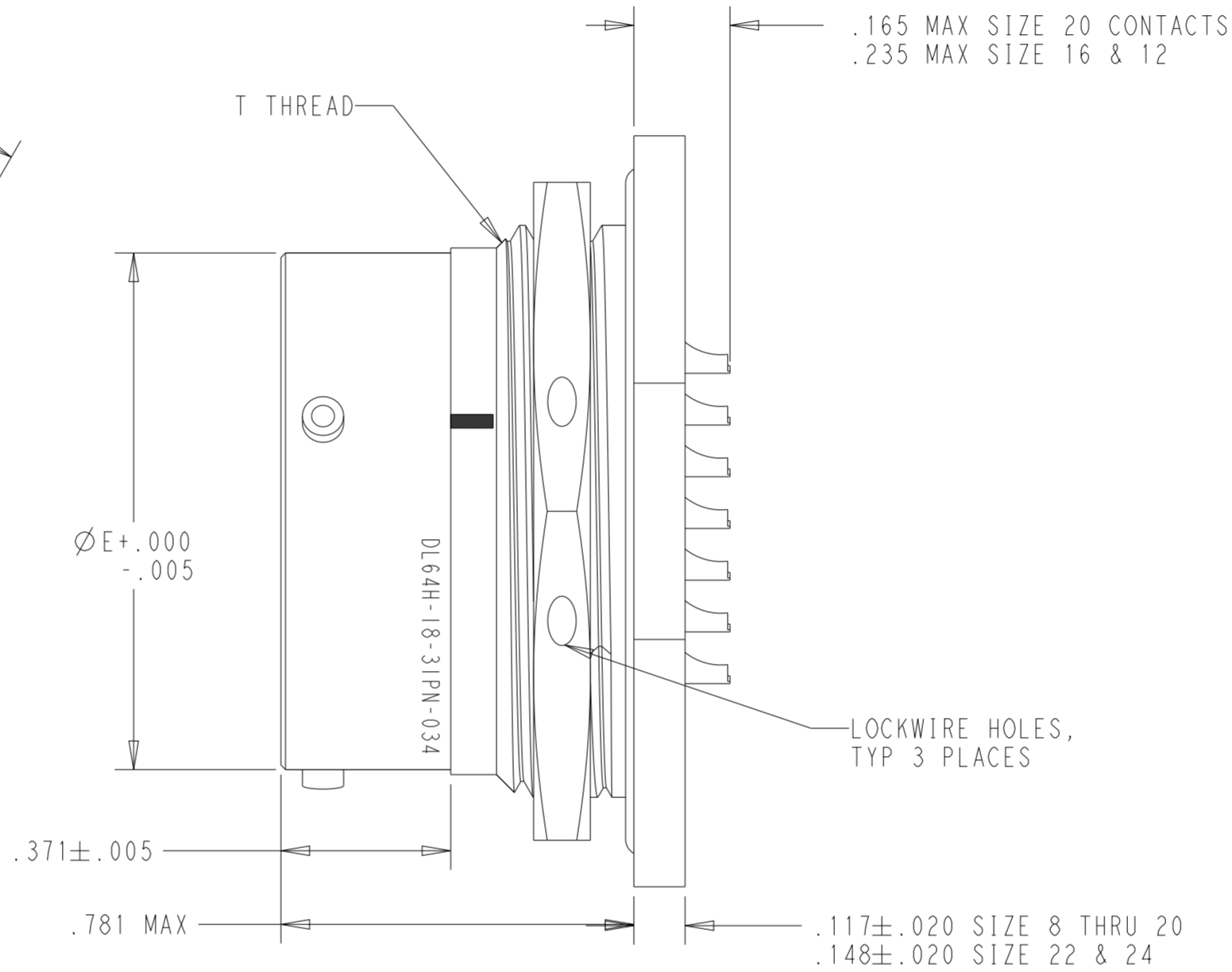
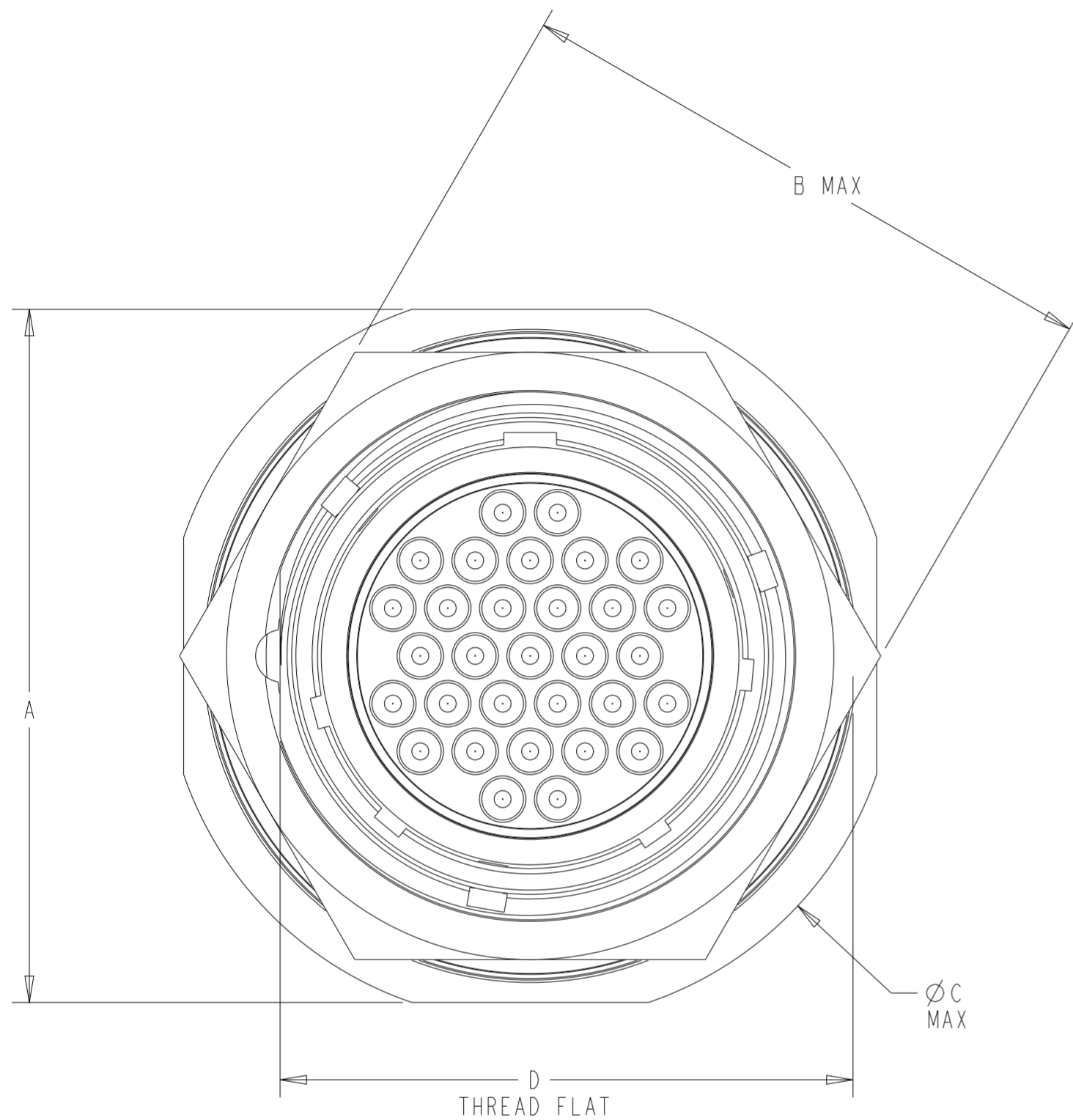

DEUTSCH P/N *	A±.005	B	C	D±.005	E	H±.005	J±.005	T THREAD
DL64H-8-*P*	.979	.828	1.068	.593	.536	.635	.605	.6250-20 UN
DL64H-10-*P*	1.104	.953	1.192	.718	.659	.760	.730	.7500-20 UNEF
DL64H-12-*P*	1.291	1.140	1.380	.905	.829	.947	.917	.9378-20 UNEF
DL64H-14-*P*	1.391	1.250	1.505	.968	.898	1.010	.980	1.0000-20 UNEF
DL64H-16-*P*	1.516	1.329	1.630	1.093	1.025	1.135	1.105	1.1250-20 UN
DL64H-18-*P*	1.641	1.455	1.740	1.217	1.131	1.260	1.225	1.2500-20 UN
DL64H-20-*P*	1.766	1.642	1.860	1.342	1.256	1.385	1.350	1.3750-18 UNEF
DL64H-22-*P*	1.954	1.705	2.040	1.467	1.381	1.510	1.475	1.5000-20 UN
DL64H-24-*P*	2.079	1.892	2.160	1.592	1.506	1.635	1.600	1.6250-18 UNEF

74	FINISH: SEE NOTE 5
DESCRIPTION: JAM NUT MOUNTING BAYONET COUPLING HERMETIC MIL-DTL-83723 TYPE ENVELOPE	
CP	CAGE CODE 11139
FOR BEST WORKMANSHIP PRACTICES, REFERENCE TE SPEC 101-32119	
PARTS SHALL COMPLY WITH TE WORKMANSHIP 101-32106	

- DIMENSIONS ARE IN INCHES UNLESS OTHERWISE SPECIFIED.
- INSERT ARRANGEMENT PER MIL-STD-1554 (18-31 ARR SHOWN AS REFERENCE ONLY).
- LEAK RATE: <1E-8 cc/sec He @ 1 atm.
- MATERIAL:
SHELL /JAM NUT- MILD STEEL
INSULATOR - GLASS INSERT
CONTACT - 52 HIGH NICKEL-IRON ALLOY
INTERFACIAL SEAL - ELASTOMER
O-RING - SILICONE BASE ELASTOMER
- FINISH:
SHELL - TIN OVER NICKEL PLATING
CONTACT - GOLD OVER NICKEL

THIS DRAWING IS A CONTROLLED DOCUMENT.

DIMENSIONS: in	TOLERANCES UNLESS OTHERWISE SPECIFIED: 0 PLC ±.1 1 PLC ±.02 2 PLC ±.005 3 PLC ±.005 4 PLC ±.0005 ANGLES ± FINISH	DWN 05MAY2022 OSCAR GONZALEZ CHK 05MAY2022 FRANCISCO APODACA APVD 05MAY2022 FRANCISCO APODACA	NAME JAM NUT MOUNTING BAYONET COUPLING HERMETIC
MATERIAL NOTE 4	NOTE 5	PRODUCT SPEC APPLICATION SPEC WEIGHT	SIZE A2
CUSTOMER DRAWING		SCALE 3:1	SHEET 1 OF 1

TE Connectivity