

**Recommended P.C. Board Layout**  
SCALE 8:1

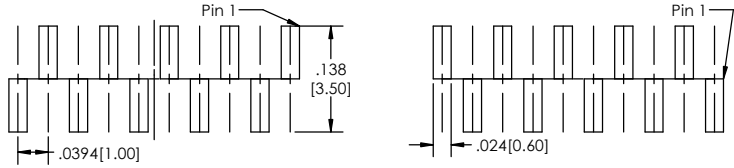

Single (M)

Single (S)

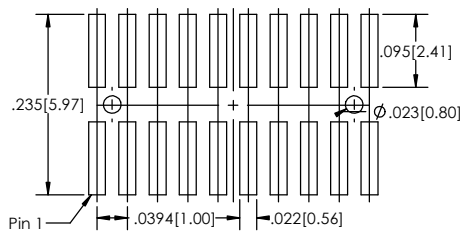

Double

**APPLICATION**

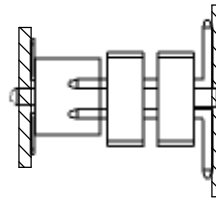

(S) Option

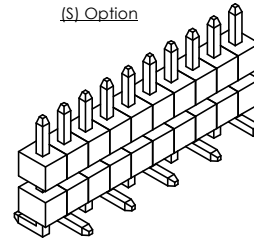

(M) Option

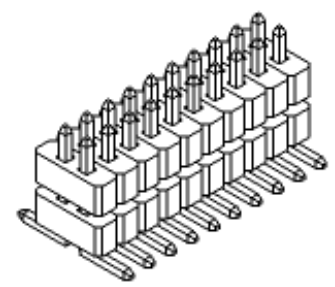
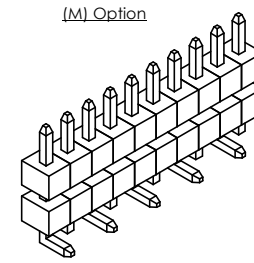

BSTCM-7 **XX** - **X** - **XXX** - **XX** - **XX** - **XXX** - **XXX** - **X** - **XX** - **X** - **XX** - **LF**  
(A) (B) (C) (D) (E) (F) (G) (H) (I) (J) (K) (L)

- A. Pins Per Row  
- 1 through 40
- B. Row Specification  
- S= Single Row  
- D= Double Row
- C. Desired Post Height  
- Please Specify  
- e.g. .100[2.54] =100  
- If post is not specified: Overall Length(L) - Board Space(B) = Post(P)
- D. Pin Options  
- See Pin Options below
- E. Plating Options  
- See Plating Options below
- F. Desired Board Space  
- Please Specify required space  
- E.g. .100(2.54)=100  
- .200(5.08) min.
- G. Polarized Position  
- Leave blank if not needed  
- If required, specify empty pin position  
- e.g. 012 for Pin 12
- H. Footprint (Only for the Single Row)  
- S= Pin 1 Left  
- M= Pin 1 Right
- I. Packing Information  
- TR= Tape and Reel  
- TB= Tube
- J. Pad  
- P= Plastic  
- O= No Pad
- K. Alignment Pin  
- Leave blank if not needed  
- AP= With
- L. Lead Free

Plating Options	
F	Gold Flash Over Entire Pin
T	200u Matte Tin All Over

Specifications:  
Current Rating: 1.0 Ampere  
Insulation Resistance: 500M Ohms Min.  
Dielectric Withstanding: 600V AC  
Contact Resistance: 20M Ohms Max.  
Operation Temperature: -40°C to +105°C  
Max. Process Temperature  
Peak: 260°C up to 10 secs.  
Process: 230°C up to 60 secs.  
Wave: 260°C up to 6 secs.  
Reflow: 260°C up to 10 secs.  
Manual Solder: 350°C up to 5 secs.

Materials:  
Contact Material: Phosphor Bronze  
Insulator Material: Nylon 6T

Pin Options		
Length		
.136	3.45mm	04
.186	4.72mm	06
.236	5.99mm	08
.286	7.26mm	10
.310	7.87mm	11
.336	8.53mm	12
.386	9.80mm	14

Post + Board Space  
must not exceed  
Overall Length

Tails may be clipped to achieve specific dimensions.  
Products cut to specific sizes are uncancelable/ nonreturnable.  
Parts are subject to change without notice.

UNLESS OTHERWISE SPECIFIED:		NAME		DATE	
DIMENSIONS ARE IN INCHES		DRAWN	EOW	02/26/14	
TOLERANCES:		CHECKED	GWE	02/26/14	
ONE DECIMALS ±.100		ENG APPR.			
TWO DECIMALS ±.010		MFG APPR.			
THREE DECIMAL ±.005		ADDRESS:			
FOUR DECIMAL ±.002		2533 Centennial Blvd. Jeffersonville, IN 47130 Phone: 812-670-4174 Fax: 812-670-4175 E-Mail: mle@mlelectronics.com			
NEXT ASSY USED ON		MATERIAL		TITLE: BSTCM-7 SERIES	
APPLICATION		FINISH		SIZE DWG. NO. <b>C</b>	
DO NOT SCALE DRAWING				REV <b>B</b>	
				SCALE 12:1	
				SHEET 1 OF 1	



PROPRIETARY AND CONFIDENTIAL  
THE INFORMATION CONTAINED IN THIS DRAWING IS THE SOLE PROPERTY OF Major League Electronics. ANY REPRODUCTION IN PART OR AS A WHOLE WITHOUT THE WRITTEN PERMISSION OF Major League Electronics IS PROHIBITED.

