

**Rectangular Cased Magnet for Proximity Switching**  
**Part Number : PSM BLK**  
**Product Data Sheet**

PICTURE	DIMENSIONS
---------	------------

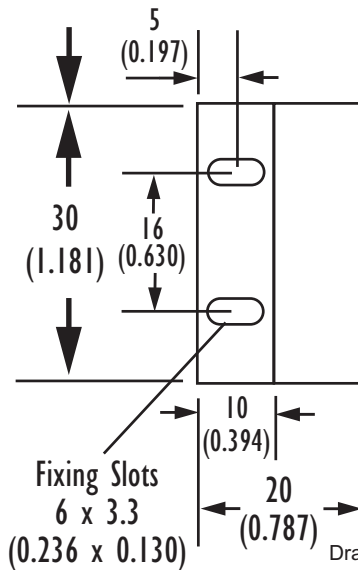
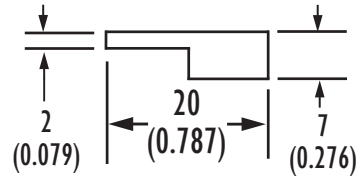

Drawings not to scale  
 All dimensions in mm nominal

**✓ RoHS Compliant**

SPECIFICATION		
Length	mm	30
Width	mm	20
Height	mm	7
Case Material		Nylon 66
Gauss Strength at Surface (CentreTypical)		200

Applications Include	Options
----------------------	---------

- Position and limit sensing.
- Linear actuators.
- Security system switch.
- Door Switch.

- Also available Blue housing, Custom colours on request
- Glass filled Nylon case. Higher Gauss strength available on request.
- Customised hole sizes or positions.

**Did you know we also sell?**



- If you do not see what you need, just ask, as there is a strong possibility we can do it !

Rev. No.	Revision Note	Date	Signature
2	Datasheet redesign	02-03-12	ML



As part of the company policy of continued product improvement, specifications may change without notice. Our sales office will be pleased to help you with the latest information on this product range and the details of our full design and manufacturing service. All products are supplied to our standard conditions of sale unless otherwise agreed in writing.

**Phone : +44 (0)1255 862236      www.assemtech.co.uk      Fax: +44 (0)1255 862014**

©2012 Copyright Assemtech Europe Ltd, Unit 7, Rice Bridge Industrial Estate, Thorpe - Le - Soken, Essex, CO16 0HL, ENGLAND.  
 USA: Comus International:+1 973 777 6900, Belgium: Comus Belgium BVBA: +32 (0)12 390400