

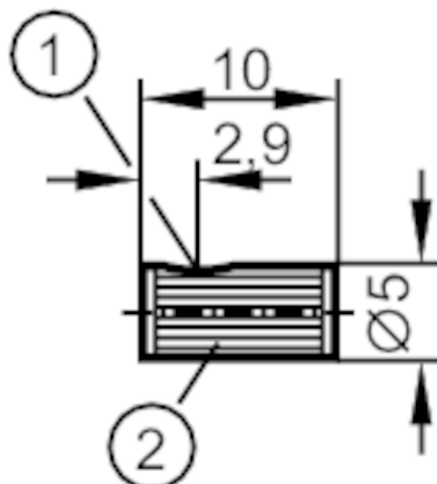

Lens attachment for fibre optics

LENS ATTACHMENT D5X10-M4



- 1 light emission
- 2 internal thread M4

Application	
Design	for through-beam fibre optics M4
Operating conditions	
Ambient temperature [°C]	-40...70
Mechanical data	
Weight [g]	3
Materials	aluminium black anodised
Remarks	
Pack quantity	2 pcs.