

THIS DOCUMENT IS THE PROPERTY OF KEYSTONE ELECTRONICS CORP. AND SHALL NOT BE REPRODUCED, DISTRIBUTED OR USED AS A BASIS FOR MANUFACTURE WITHOUT PRIOR WRITTEN PERMISSION FROM KEYSTONE ELECTRONICS CORP.

**ACTUAL SIZE**

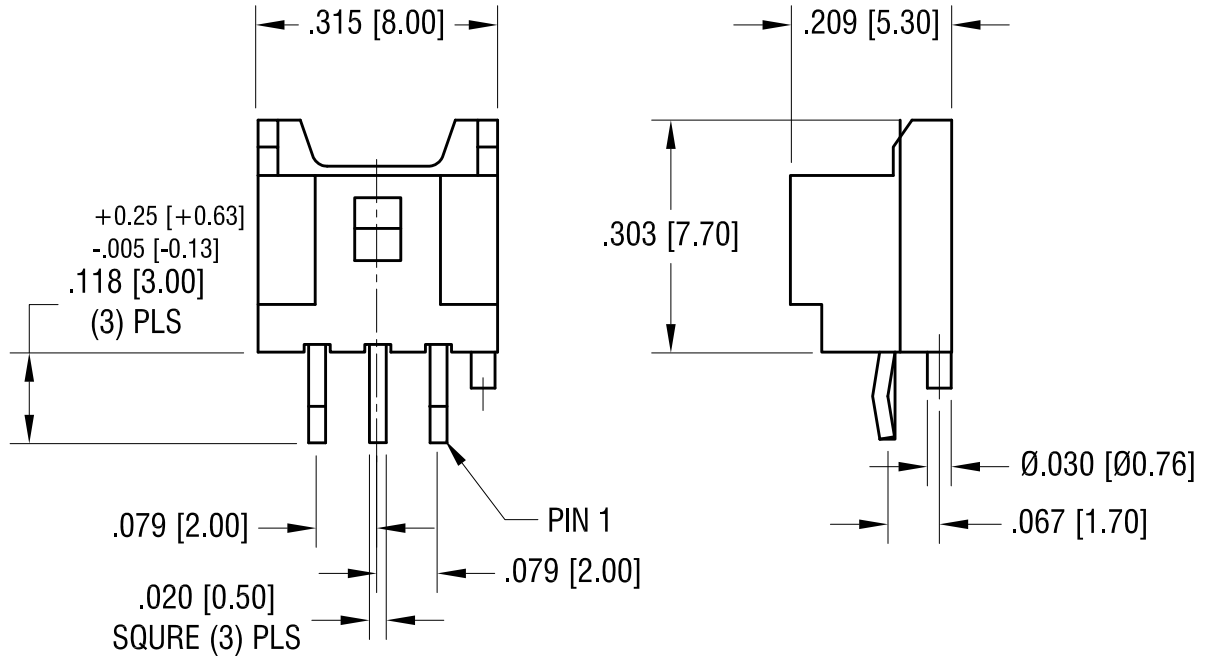
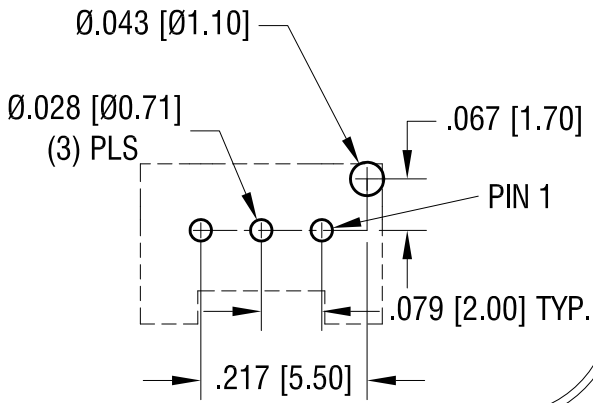

**NOTE:**

1. HOUSING: MAT'L- PA66, UL94V-0
2. POST: MAT'L- BRASS  
TIN PLATED

6.10.21	REVISED LEG TOLERANCE CHANGE AS PER ECN 21-051	A
DATE	DESCRIPTION	REV.

<b>KEYSTONE ELECTRONICS CORP.</b>			
www.keyelco.com • NEW HYDE PARK, NY 11040 • Tel (516) 328-7500			
PART NAME THM TOP ENTRY CONNECTOR (3 CIRCUITS)			
MATERIAL AS NOTED			
FINISH AS NOTED		DRN BY NT	DATE 3.07.16
		APP'D RH	SCALE 4X
TOLERANCES DECIMAL ANGULAR	INCH ± .005 ± 1°	[MM] [± 0.13 ]	CODE DWG NO.
UNLESS OTHERWISE SPECIFIED			<b>975</b>