

SECTION A-A

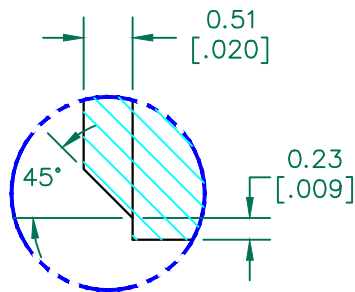

DETAIL A
SCALE 13:1

NOTES: UNLESS OTHERWISE SPECIFIED

1. COSMETIC SPECIFICATION REFER TO WI-QA-038.

| IMPEDANCE (Z) | | | |
|-----------------|--------|---------|---------|
| Frequency | 25 MHz | 100 MHz | 300 MHz |
| Nominal (REF) | 110 Ω | 280 Ω | 550 Ω |
| Minimum | - Ω | 224 Ω | - Ω |

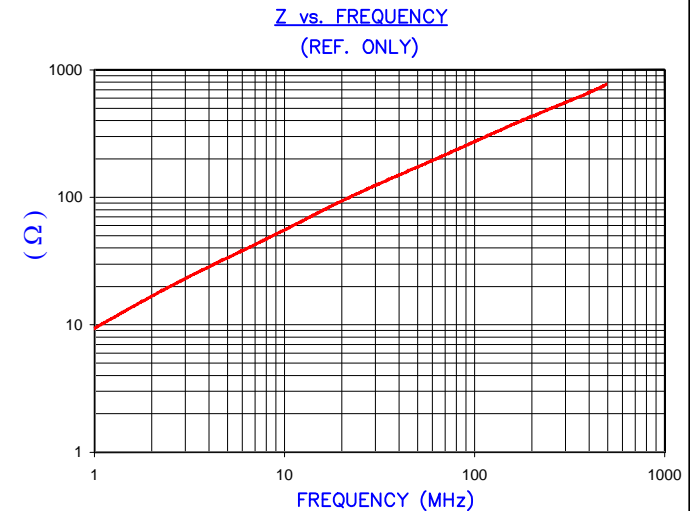

AGILENT E4991A Impedance/Material Analyzer
HP 16092A Test Fixture REF#3025

FERRITE CORE DIMENSIONS (SPEC):mm[Inches]

| | | | |
|---|---------------|---|-------------|
| A | 55.12 [2.170] | + | 0.80 [.031] |
| B | 43.69 [1.720] | + | 0.80 [.031] |
| C | 25.40 [1.000] | + | 0.76 [.030] |
| D | 12.70 [.500] | + | 0.51 [.020] |
| | | + | 0.51 [.020] |
| E | 1.27 [.050] | - | 0.20 [.008] |

WEIGHT/1000 80.28 kgs 176.99 Lbs



SCALE DRAWING 1:1

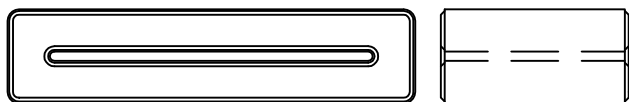

28R2170-000

| DIMENSIONS ARE IN mm [INCHES]. | | | | This print is the property of Laird Tech. and is loaned in confidence subject to return upon request and with the understanding that no copies shall be made without the written consent of Laird Tech. All rights to design or invention are reserved. | |
|--------------------------------|--|----------|------|---|--|
| J | UPDATE THE LOGO | 06/19/15 | QIU | | PROJECT/PART NUMBER: 28R2170-000 |
| H | RIVISE A B TOLERANCE | 03/30/11 | Jcai | | |
| G | UPDATE MIN Z SPECS & COMPANY LOGO | 07/27/07 | TMB | | |
| F | UPDATE MIN Z SPEC@100 MHz ADD REF# | 02/19/04 | JRK | | |
| E | UPDATE TO NEW CNZ FORMAT ADD Z CURVE CHANGE TOLERANCE ON E DIMENSION | 02/28/03 | JRK | | |
| D | UPDATE PRINT FOR ELECTRONIC DATABASE | 01/10/01 | JAJ | | |
| C | UPDATED P/N FOR NEW CATALOG | 11/10/95 | JBE | | |
| B | REVISED DRAWING | 07/06/94 | JAZ | | |
| A | ORIGINAL DRAFT | 02/03/93 | LNK | | |
| REV | DESCRIPTION | DATE | INT | | |
| | | | | DATE: 06/19/05 | SCALE: 1.5 : 1 |
| | | | | CAD # 28R2170-000-J | TOOL # R2170 |
| | | | | MATERIAL: Ferrite | |