

Power Inductor APSR Series

**Automotive
AEC-Q200**

RoHS Compliant
Halogen Free
REACH Compliant

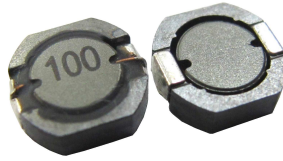

Power
Circuit

Shield

Wire
Wound

Ferrite

Part Numbering

| A | PSR | 00 | 080725 | 1R0 | M | 00 |
|-------|-------------|--------------|-------------------------|--------------------|-----------|---------------|
| Grade | Series Name | Control Code | Dimensions Code (mm) | Inductance (uH) | Tolerance | Internal Code |
| | | | 050522 5.2x5.0x2.2 | R47 0.47 | M ±20% | |
| | | | 080725 7.5x7.4x2.5 | 1R0 1.0 | T ±30% | |
| | | | 080740 7.5x7.4x4.0 | 101 100 | | |

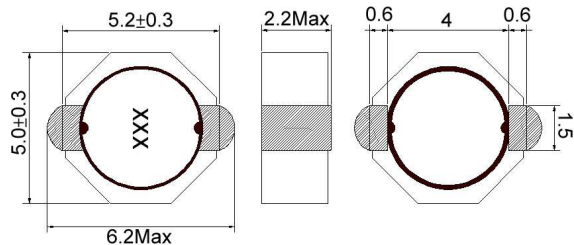
APSR00050522 Type
■ Dimensions

unit:mm

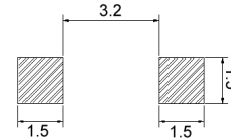
■ Recommended Land Pattern

unit:mm

■ Electrical Characteristics

| Part No. | Inductance (μH) | Test Freq. | RDC ($\text{m}\Omega$)Max. | Isat (A) | Irms (A) | Tolerance ($\pm\%$) | Marking |
|--------------------|---------------------------------|------------|---------------------------------|-------------|-------------|--------------------------|---------|
| APSR000505221R2□00 | 1.2 | 100kHz,1V | 25 | 4.3 | 3.43 | 30 | 1R2 |
| APSR000505221R8□00 | 1.8 | 100kHz,1V | 32 | 3.6 | 3.12 | 30 | 1R8 |
| APSR000505223R3□00 | 3.3 | 100kHz,1V | 54 | 2.5 | 2.68 | 30 | 3R3 |
| APSR000505224R7□00 | 4.7 | 100kHz,1V | 81 | 2.0 | 2.18 | 30 | 4R7 |
| APSR00050522100□00 | 10 | 100kHz,1V | 160 | 1.4 | 1.51 | 20,30 | 100 |
| APSR00050522220□00 | 22 | 100kHz,1V | 320 | 0.9 | 1.02 | 20,30 | 220 |
| APSR00050522330□00 | 33 | 100kHz,1V | 490 | 0.77 | 0.80 | 20,30 | 330 |

Note: When ordering, please specify tolerance code. Tolerance: M= $\pm 20\%$ / T= $\pm 30\%$

1. Operating temperature range - 40°C ~ 125°C (Including self - temperature rise)
2. Isat for Inductance drop 35% from its value without current
3. I rms for a 40°C temperature rise from 25°C ambient with current
4. Measure Equipment:

L: Agilent E4980 or HP4284A

RDC: Chroma 16502

Isat: HP4284A+HP42841A or WK3260B+WK3265B

I rms: Agilent 6641 SYSTEM DC POWER SUPPLY

APSR00050522 Type

Characteristics Graph

Inductance vs. Frequency Characteristics

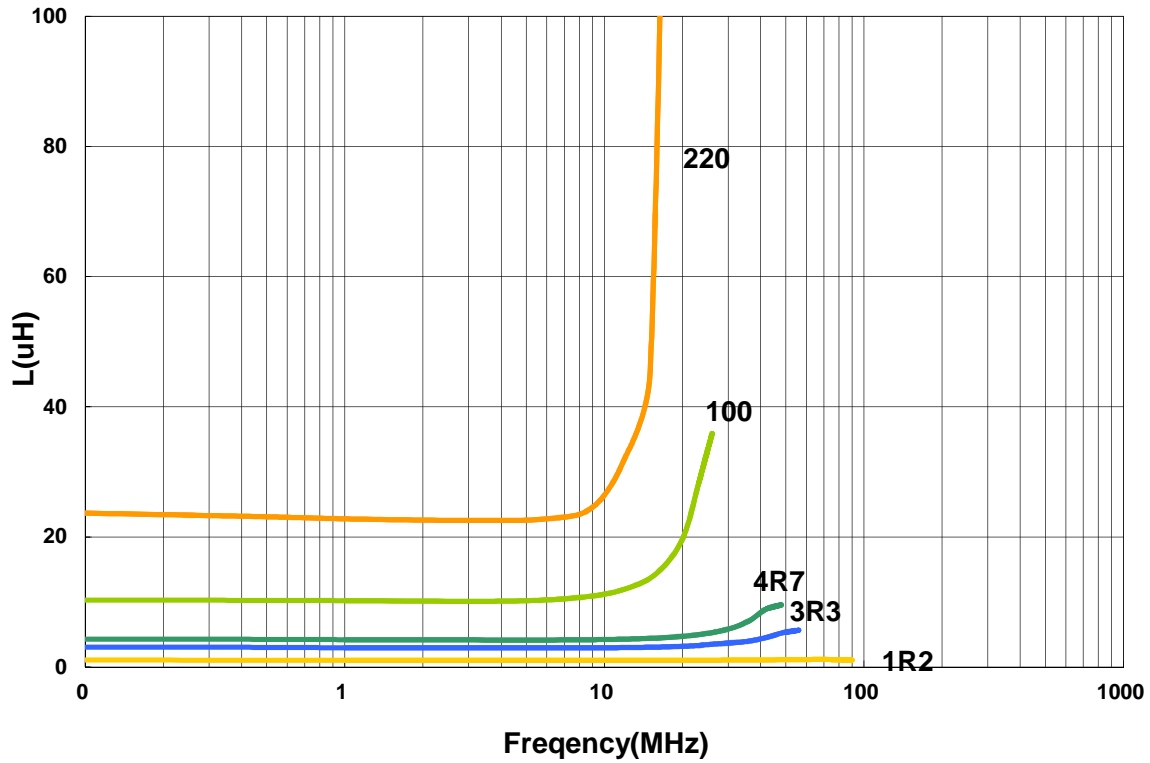

Inductance vs. DC Current

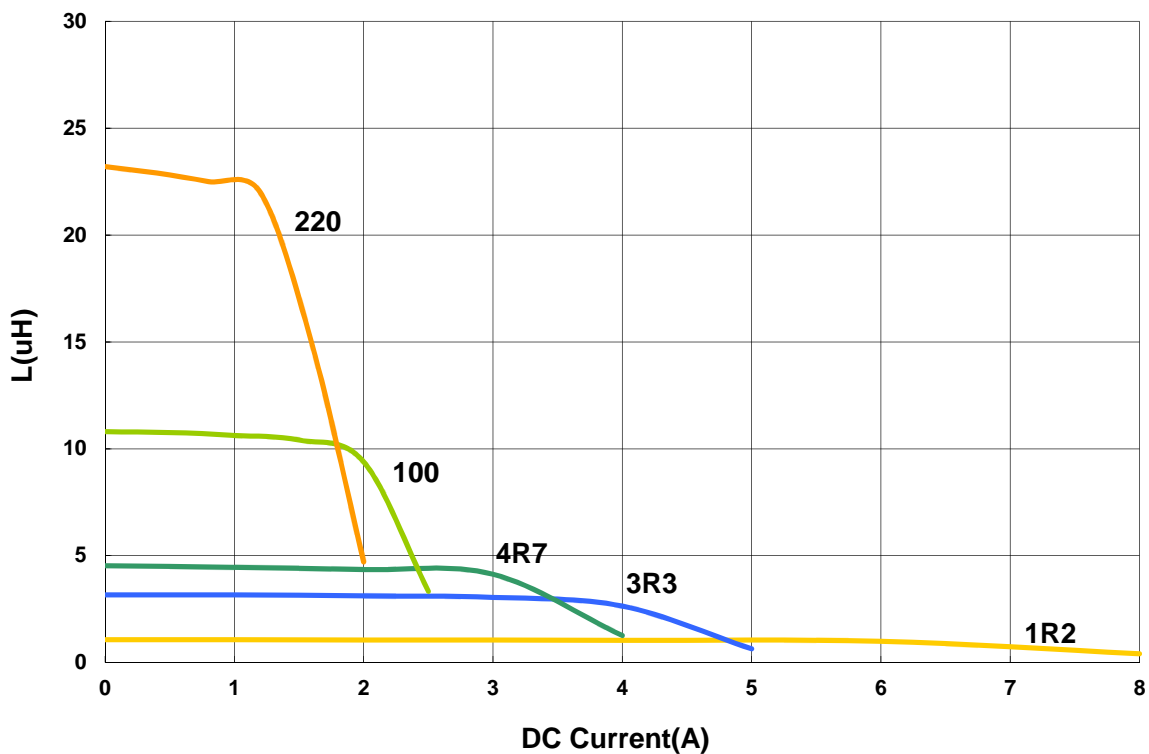

Please be sure to request approval specifications that provide further details of the products. Kindly note that the content of these specifications are subject to change or may be discontinued without prior notice. This product may not be designed/used in medical or high risk applications without Chilisin approval. Please contact our sales department before ordering.

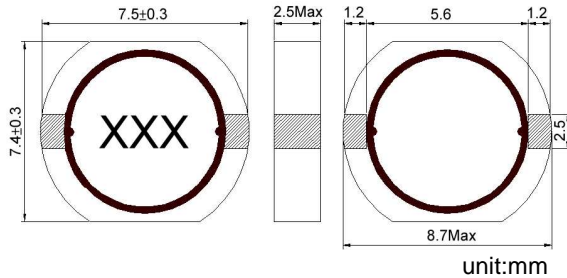
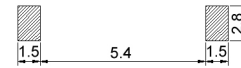
APSR00080725 Type
■ Dimensions

■ Recommended Land Pattern

■ Electrical Characteristics

| Part No. | Inductance (uH) | Test Freq. | RDC (mΩ)Max. | Isat (A) | Irms (A) | Tolerance (±%) | Marking |
|--------------------|-----------------|------------|--------------|----------|----------|----------------|---------|
| APSR000807251R0□00 | 1.0 | 100kHz,1V | 14.28 | 2.20 | 6.22 | 30 | 1R0 |
| APSR000807251R5□00 | 1.5 | 100kHz,1V | 19.70 | 2.08 | 5.00 | 30 | 1R5 |
| APSR000807252R2□00 | 2.2 | 100kHz,1V | 24.09 | 1.86 | 4.40 | 30 | 2R2 |
| APSR000807253R3□00 | 3.3 | 100kHz,1V | 41.2 | 1.80 | 3.70 | 30 | 3R3 |
| APSR000807254R7□00 | 4.7 | 100kHz,1V | 49.7 | 1.80 | 3.20 | 30 | 4R7 |
| APSR000807255R6□00 | 5.6 | 100kHz,1V | 58.9 | 1.39 | 2.90 | 20,30 | 5R6 |
| APSR000807256R8□00 | 6.8 | 100kHz,1V | 66.3 | 1.32 | 2.70 | 20,30 | 6R8 |
| APSR00080725100□00 | 10 | 100kHz,1V | 92.4 | 1.25 | 1.90 | 20,30 | 100 |
| APSR00080725150□00 | 15 | 100kHz,1V | 170 | 1.20 | 1.70 | 20,30 | 150 |
| APSR00080725220□00 | 22 | 100kHz,1V | 210 | 1.13 | 1.52 | 20,30 | 220 |
| APSR00080725330□00 | 33 | 100kHz,1V | 320 | 0.91 | 1.10 | 20,30 | 330 |
| APSR00080725470□00 | 47 | 100kHz,1V | 490 | 0.85 | 0.95 | 20,30 | 470 |

Note: When ordering, please specify tolerance code. Tolerance: M=±20% / T=±30%

- Operating temperature range - 40°C ~ 125°C(Including self - temperature rise)
- Isat for Inductance drop 35% from its value without current
- Irms for a 40°C temperature rise from 25°C ambient with current
- Measure Equipment:
 - L: Agilent E4980 or HP4284A
 - RDC: Chroma 16502
 - Isat: HP4284A+HP42841A or WK3260B+WK3265B
 - Irms: Agilent 6641 SYSTEM DC POWER SUPPLY

APSR00080725 Type

Characteristics Graph

Inductance vs. Frequency Characteristics

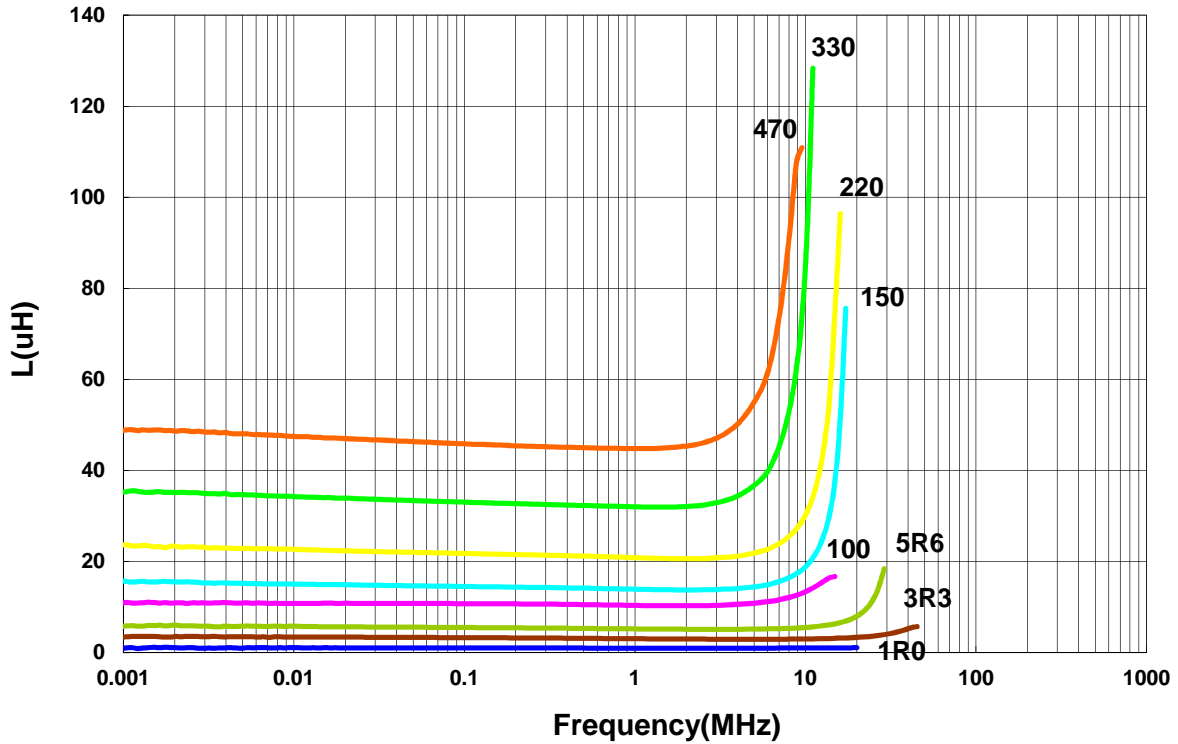

Inductance vs. DC Current

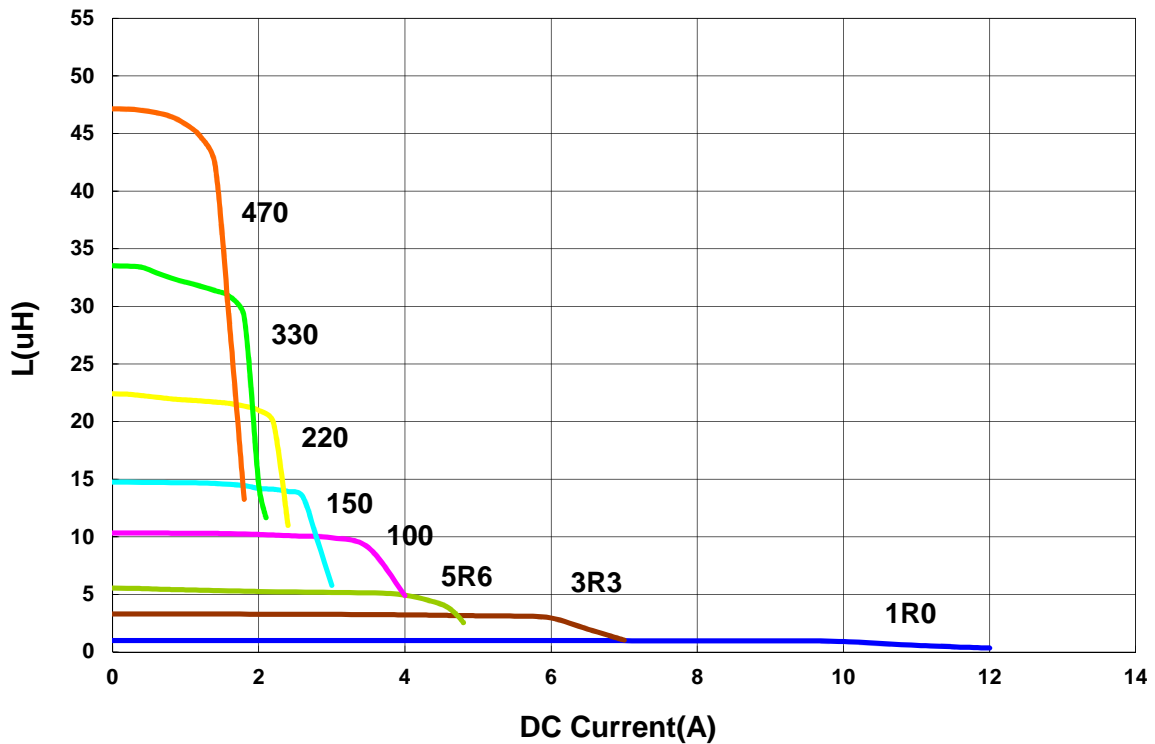

Please be sure to request approval specifications that provide further details of the products. Kindly note that the content of these specifications are subject to change or may be discontinued without prior notice. This product may not be designed/used in medical or high risk applications without Chilisin approval. Please contact our sales department before ordering.

APSR00080740 Type

■ Dimensions

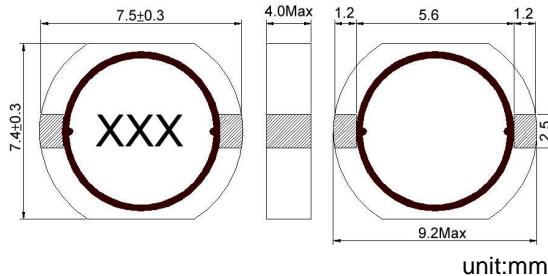

unit:mm

■ Recommended Land Pattern

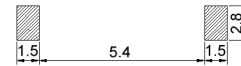

unit:mm

■ Electrical Characteristics

| Part No. | Inductance (uH) | Test Freq. | RDC (mΩ)Max. | Isat(A) Max(Typ) | Irms (A) | Tolerance (±%) | Marking |
|--------------------|-----------------|------------|--------------|------------------|----------|----------------|---------|
| APSR000807401R0□00 | 1.0 | 100kHz,1V | 6.38 | 8.0(12) | 9.00 | 30 | 1R0 |
| APSR000807401R5□00 | 1.5 | 100kHz,1V | 8.64 | 7.0(10) | 8.00 | 30 | 1R5 |
| APSR000807401R8□00 | 1.8 | 100kHz,1V | 9.60 | 6.5(8.6) | 7.92 | 30 | 1R8 |
| APSR000807402R5□00 | 2.5 | 100kHz,1V | 13.6 | 4.8(7.2) | 7.40 | 30 | 2R5 |
| APSR000807403R3□00 | 3.3 | 100kHz,1V | 17.8 | 3.9(6.8) | 6.70 | 30 | 3R3 |
| APSR000807404R7□00 | 4.7 | 100kHz,1V | 26.6 | 3.5(4.6) | 4.90 | 20,30 | 4R7 |
| APSR000807405R6□00 | 5.6 | 100kHz,1V | 29.0 | 3.3(4.1) | 4.60 | 20,30 | 5R6 |
| APSR000807406R8□00 | 6.8 | 100kHz,1V | 34.0 | 3.2(3.9) | 3.90 | 20,30 | 6R8 |
| APSR00080740100□00 | 10 | 100kHz,1V | 55.6 | 2.5(3.4) | 3.25 | 20,30 | 100 |
| APSR00080740150□00 | 15 | 100kHz,1V | 71.4 | 2.1(3.0) | 2.70 | 20,30 | 150 |
| APSR00080740220□00 | 22 | 100kHz,1V | 98.1 | 1.7(2.4) | 2.40 | 20,30 | 220 |
| APSR00080740330□00 | 33 | 100kHz,1V | 140 | 1.4(2.0) | 1.90 | 20,30 | 330 |
| APSR00080740470□00 | 47 | 100kHz,1V | 217 | 1.2(1.7) | 1.48 | 20,30 | 470 |
| APSR00080740560□00 | 56 | 100kHz,1V | 260 | 1.0(1.5) | 1.33 | 20,30 | 560 |
| APSR00080740680□00 | 68 | 100kHz,1V | 310 | 0.95(1.36) | 1.20 | 20,30 | 680 |
| APSR00080740820□00 | 82 | 100kHz,1V | 360 | 0.9(1.20) | 1.12 | 20,30 | 820 |
| APSR00080740101□00 | 100 | 100kHz,1V | 480 | 0.85(1.12) | 0.95 | 20,30 | 101 |
| APSR00080740121□00 | 120 | 100kHz,1V | 560 | 0.75(1.00) | 0.89 | 20,30 | 121 |
| APSR00080740151□00 | 150 | 100kHz,1V | 710 | 0.65(0.92) | 0.82 | 20,30 | 151 |

Note: When ordering, please specify tolerance code. Tolerance: M=±20% / T=±30%

1. Operating temperature range - 40°C ~ 125°C(Including self - temperature rise)
2. Isat for Inductance drop 35% from its value without current
3. I rms for a 40°C temprature rise from 25°C ambient with current
4. Measure Equipment:
L: Agilent E4980 or HP4284A
RDC: Chroma 16502
Isat: HP4284A+HP42841A or WK3260B+WK3265B
I rms: Agilent 6641 SYSTEM DC POWER SUPPLY

APSR00080740 Type

Characteristics Graph

Inductance vs. Frequency Characteristics

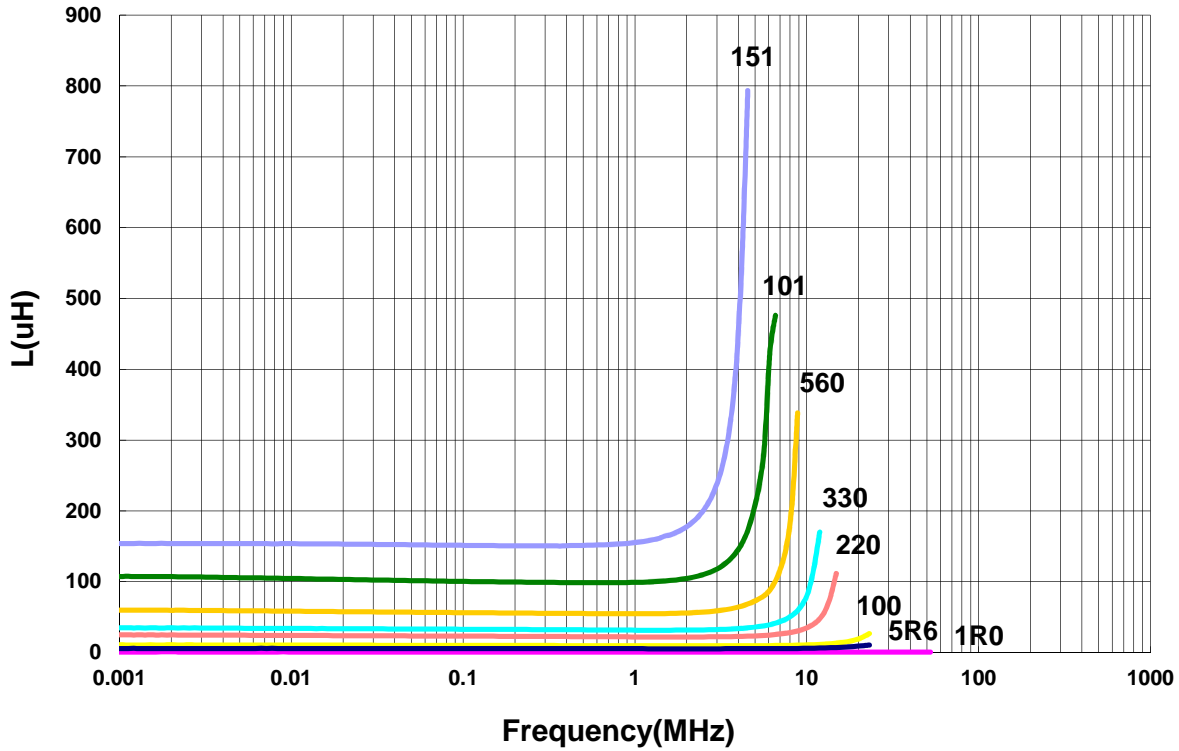

Inductance vs. DC Current

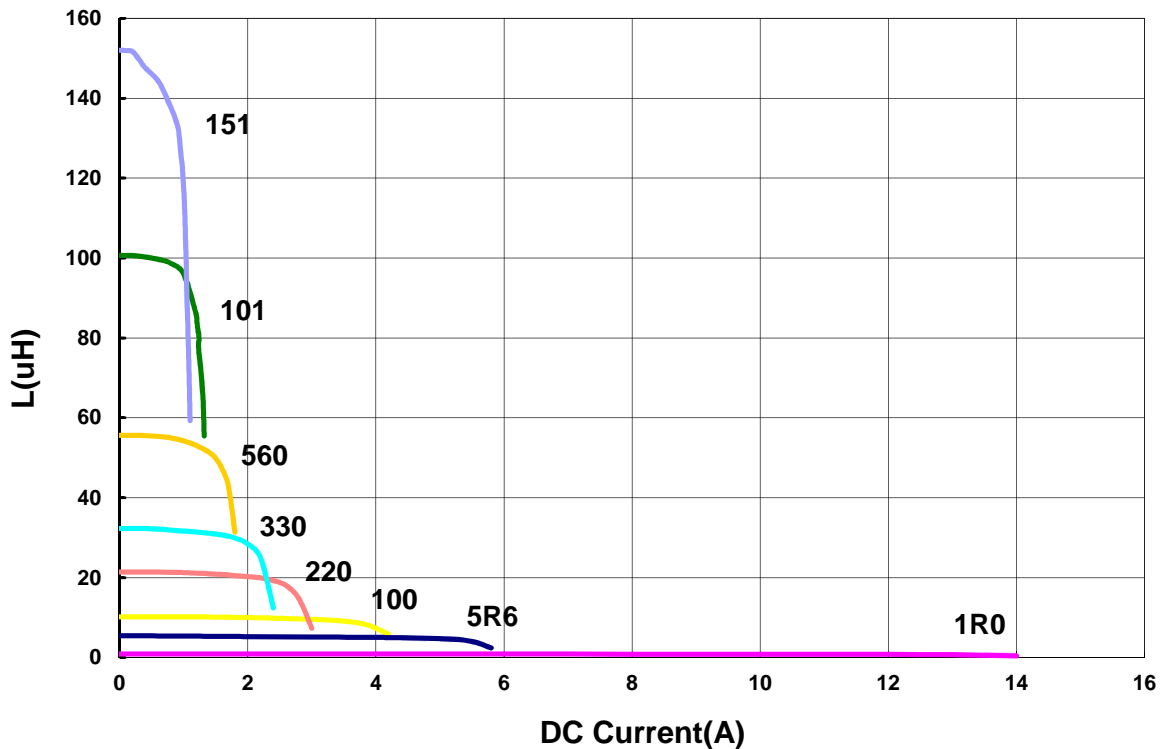

Please be sure to request approval specifications that provide further details of the products. Kindly note that the content of these specifications are subject to change or may be discontinued without prior notice. This product may not be designed/used in medical or high risk applications without Chilisin approval. Please contact our sales department before ordering.

■ Packaging

Tape Dimensions

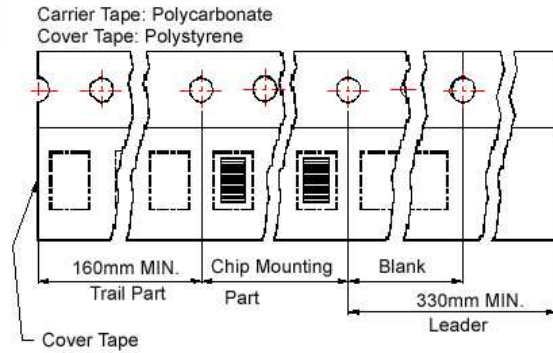
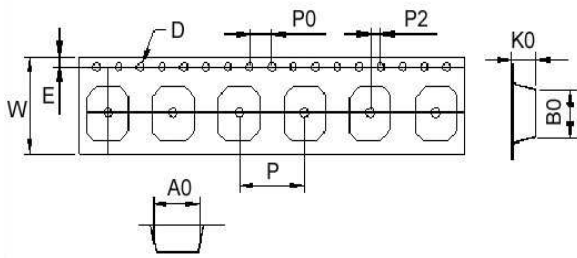

Reel Dimensions

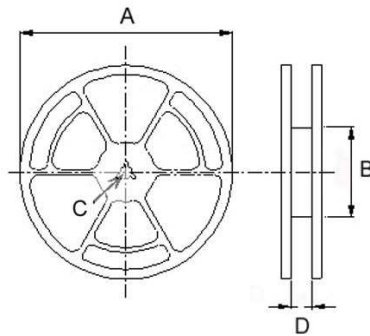

Dimensions in mm

| TYPE | | | | | | | | | | Reel Dimensions | | | | Quantity |
|--------------|------|------|-----|------|------|----|----|----|----|-----------------|-----|----|------|------------|
| | A0 | B0 | K0 | D | E | W | P | P0 | P2 | A | B | C | D | PCS / REEL |
| APSR00050522 | 5.25 | 6.25 | 2.4 | 1.55 | 1.75 | 12 | 8 | 4 | 2 | 330 | 100 | 13 | 13.4 | 2000 |
| APSR00080725 | 7.60 | 8.65 | 2.8 | 1.55 | 1.75 | 16 | 12 | 4 | 2 | 330 | 100 | 13 | 16 | 1500 |
| APSR00080740 | 7.60 | 9.00 | 4.3 | 1.55 | 1.75 | 16 | 12 | 4 | 2 | 330 | 100 | 13 | 16 | 1000 |