



**Electrical specifications**

**Center Frequency:** 1804 MHz  
**Bandwidth:**  $F_0 \pm 47.5$  MHz  
**VSWR:** 1.7 : 1 max  
**Input / Output Impedance:** 50 Ohms  
**Passband:** 1780.25-1827.75 MHz  
**Passband Insertion Loss:** 1.5 dB max  
**Passband Ripple:** 0.5 dB max  
**Rejection:** 45 dBc min 1450 MHz  
**Rejection 2:** 40 dBc min 2150 MHz  
**Power Handling:** 0.5 watt

**Mechanical**

**Mounting Method:** SMT  
**Dimensions:** 13.97mm x 12.7mm x 5mm  
 ( .550" x .500" x .197" )

**Environmental**

**Operating Temperature:** -20°C to 55°C  
**Storage Temperature:** -50°C to +90°C

**This product is RoHs compliant.**

**Outline Drawing:**

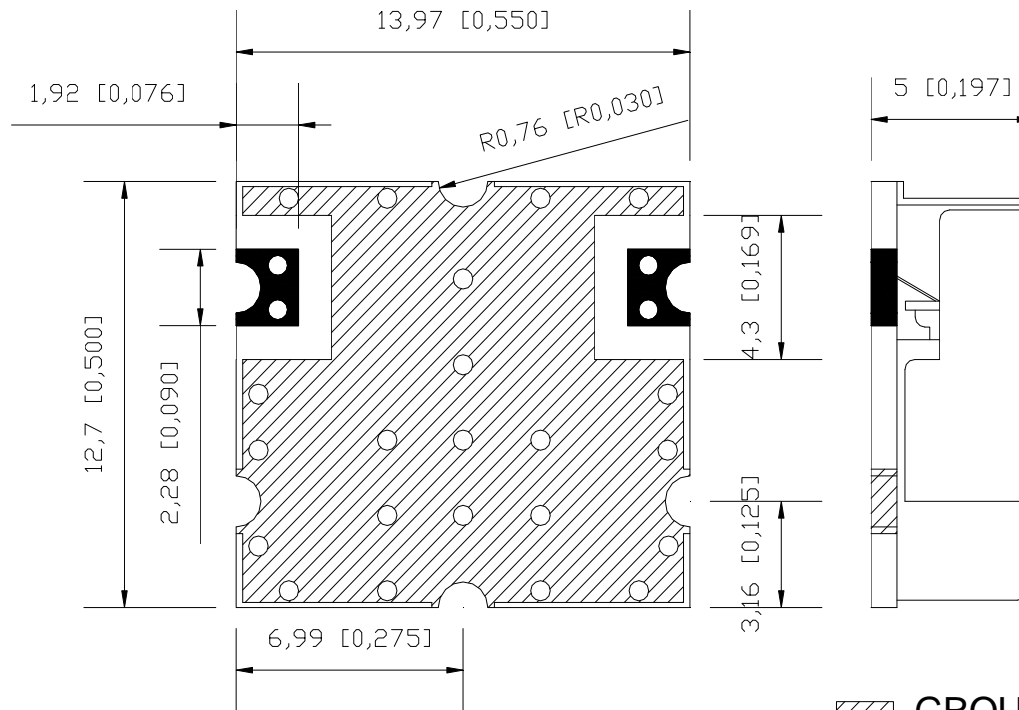

 GROUND  
 IN-OUT PORT  
 UNIT : mm  
 Tolerance : +/-0.2mm