

NOTE:

- 1.MATERIAL:
HOUSING:HIGH TEMPERATURE NYLON,GLASS FIBRE FILLED,UL94-V0,COLOR:BLACK
TERMINAL:PHOSPHOR BRONZE
METAL SHELL:DEEP DRAWN STEEL
- 2.PLATING:
TERMINAL:
(a)GLOD FIASH ON THE CONTACT AREA,AND 75MICROINCH MINIMUM PURE TIN ON SOLDER TAIL, UNDER 50MICROINCH MINIMUM Ni PLATE.
(b)30MICROINCH MINIMUM GOLD(Au) ON THE CONTACT AREA, AND 75MICROINCH MINIMUM PURE TIN ON SOLDER TAIL,UNDER 50MICROINCH MINIMUM Ni UNDER PLATE.
(c)GOLD FIASH ON THE CONTACT AREA,AND 75MICROINCH MINIMUM MATTE TIN ON SOLDER TAIL,UNDER 50MICROINCH MINIMUM Ni PLATE.
- METAL SHELL:
(d)100MICROINCH MINIMUM BRIGHT TIN ON THE METAL SHELL,AND 50MICROINCH MINIMUM Ni AND 100MICROINCH MINIMUM Cu PLATE.
(e)100MICROINCH MINIMUM MATTE TIN ON THE METAL SHELL,AND 50MICROINCH MINIMUM Ni AND 100MICROINCH MINIMUM Cu PLATE.
- 3.RECOMMENDED PCB THICKNESS:1.60 ±0.05mm
4.PRODUCT SPECIFICATION:REFER TO PS-89485
5. TRAY PACKAGING SPECIFICATION REFER TO:PK-89485-002
TUBE PACKAGING SPECIFICATION REFER TO:PK-89485-001

DIMENSION"A"	P/N	PLATING	TERMINAL CONTACT PLATING	TERMINAL SOLDER PLATING	METAL SHELL PLATING
2.00	+0.35	89485-8000	SEE NOTES(a)+(d)	GOLD FLASH	75 MICRO INCH BRIGHT TIN 100 MICRO INCH BRIGHT TIN
	-0.15	89485-8001	SEE NOTES(b)+(d)	30 MICRO INCH GOLD	
2.50	+0.35	89485-8002	SEE NOTES(a)+(d)	GOLD FLASH	
	-0.10	89485-8003	SEE NOTES(b)+(d)	30 MICRO INCH GOLD	

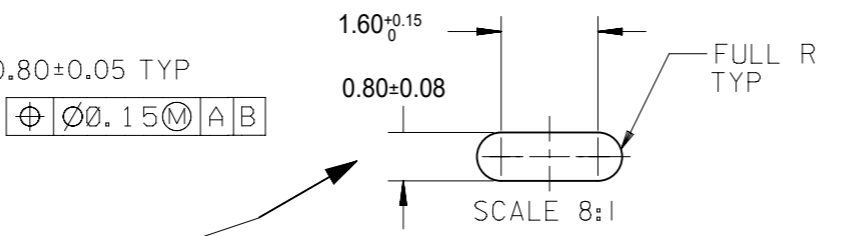
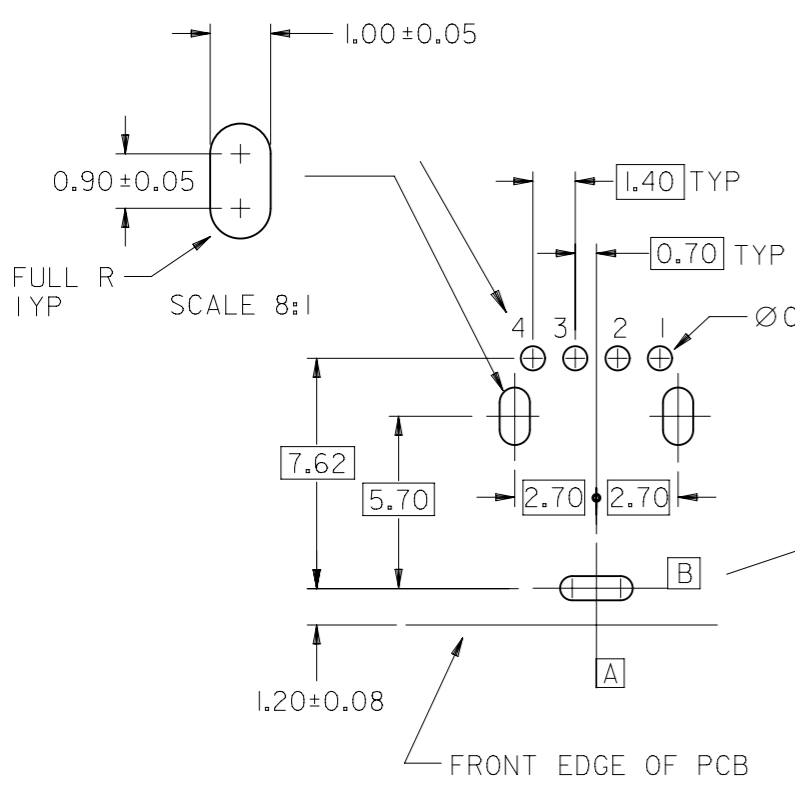
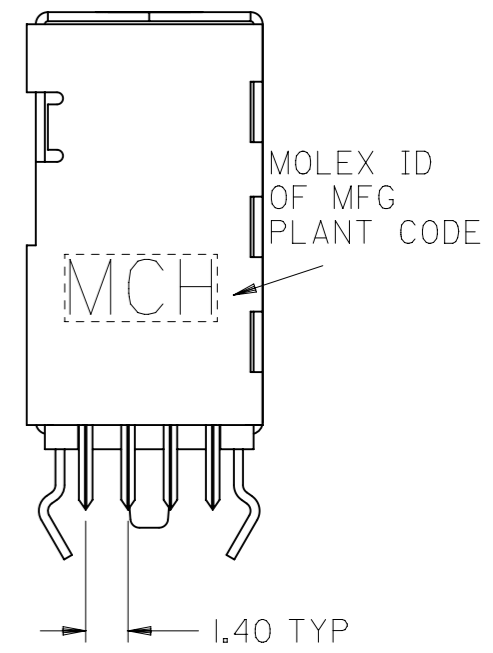
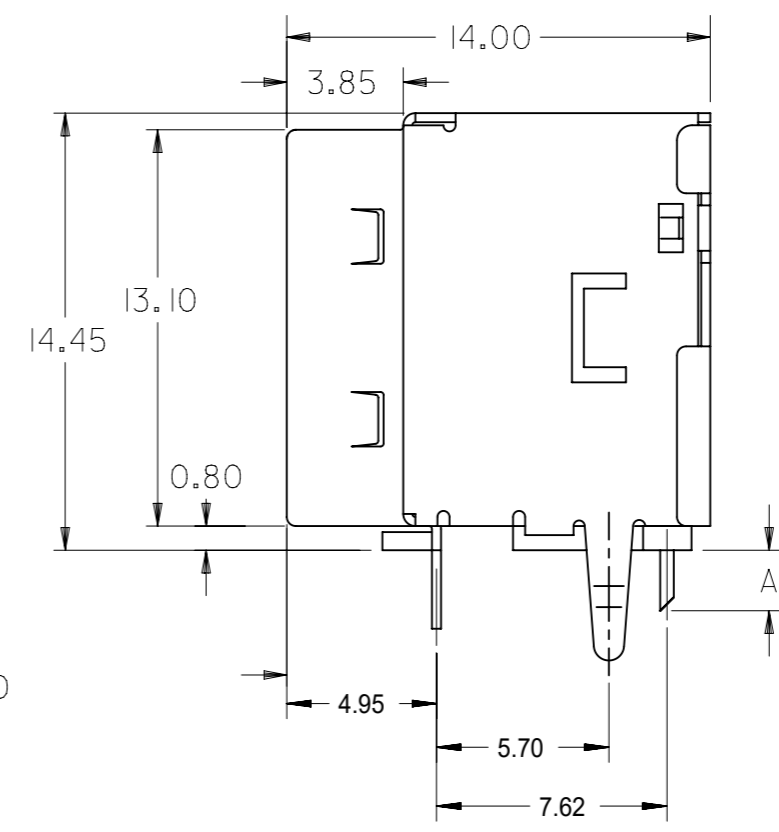
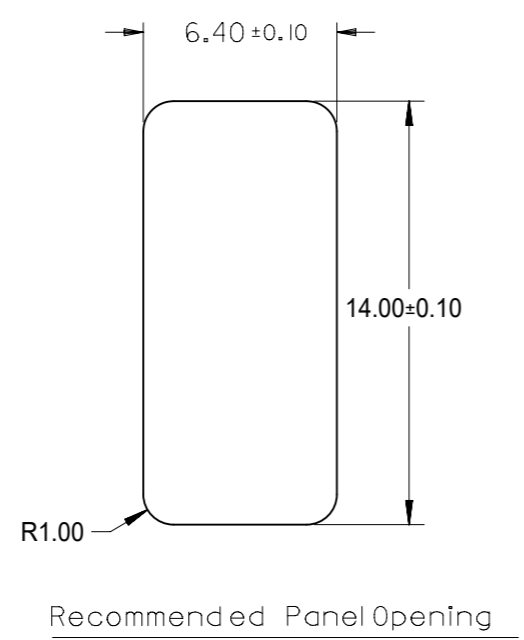
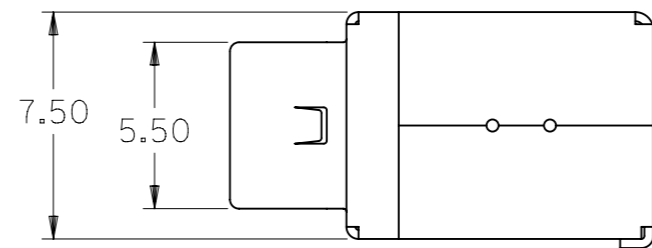

PRE-RELEASE REFERENCE USE ONLY

THIS DRAWING CONTAINS INFORMATION THAT IS PROPRIETARY TO MOLEX ELECTRONIC TECHNOLOGIES, LLC AND SHOULD NOT BE USED WITHOUT WRITTEN PERMISSION

DIMENSION UNITS	SCALE	CURRENT REV DESC: REMOVED OBSOLETE PART NUMBER AS PER PCN#508521/511698.		molex		
mm	1:1					
GENERAL TOLERANCES (UNLESS SPECIFIED)				SINGLE PORT UP-RIGHT USB CONNECTOR		
				PRODUCT CUSTOMER DRAWING		
4 PLACES	±			EC NO: 742551	2021/04/14	
3 PLACES	±			DRWN: ABHISP1	2023/05/12	
2 PLACES	±	0.25	± 0.01	CHK'D: GGA	2023/05/12	
1 PLACE	±	0.25	± 0.01	APPR: GGA	2023/05/12	
0 PLACES	±			INITIAL REVISION:		
ANGULAR TOL ± 3.0°				DRWN: DAVID HU		
DRAFT WHERE APPLICABLE MUST REMAIN WITHIN DIMENSIONS				THIRD ANGLE PROJECTION	DRAWING	SHEET NUMBER
					A3-SIZE	89485
				MATERIAL NUMBER	CUSTOMER	SHEET NUMBER
				SEE TABLE	GENERAL MARKET	1 OF 1