

May.1.2023 Copyright 2023 HIROSE ELECTRIC CO., LTD. All Rights Reserved.  
In case of consideration for using Automotive equipment / device which demand high reliability, kindly contact our sales window correspondents.

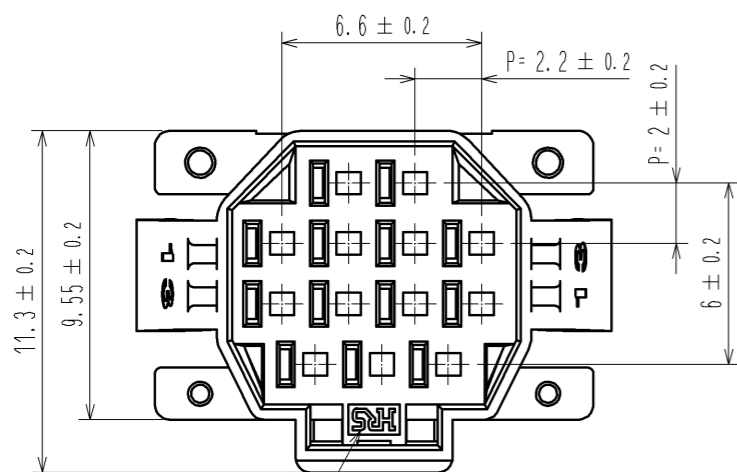

7 MATING FIGURE ( PANEL MOUNTED )

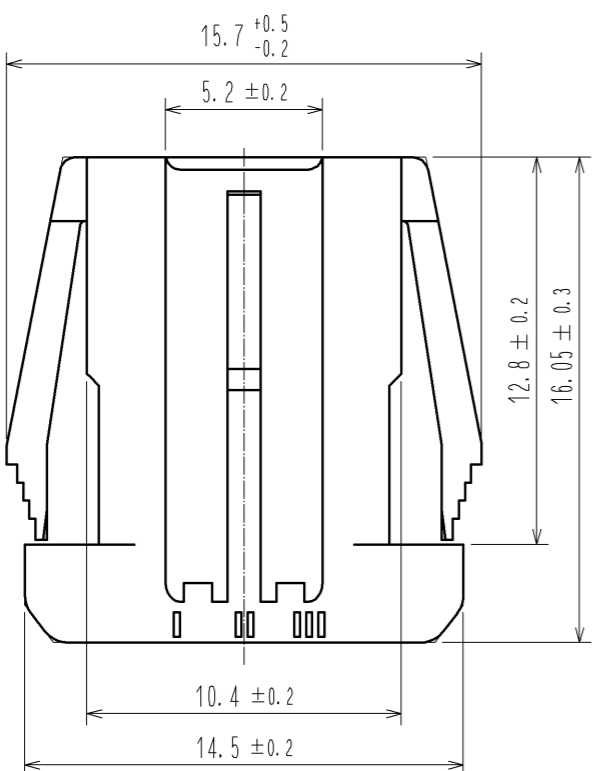
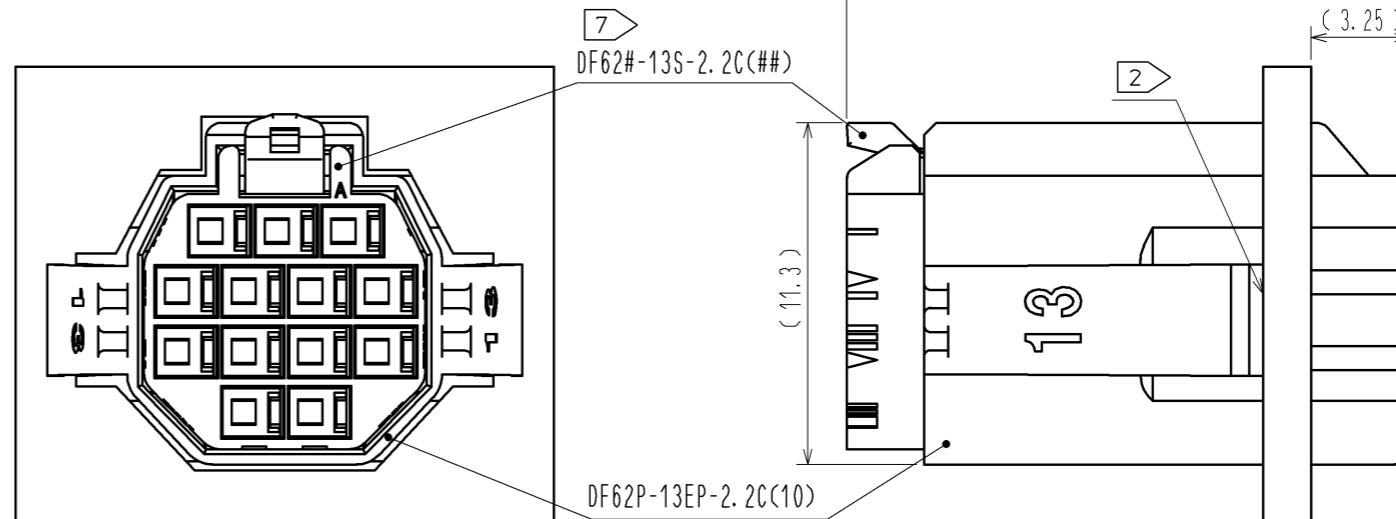

NUMBER OF POS

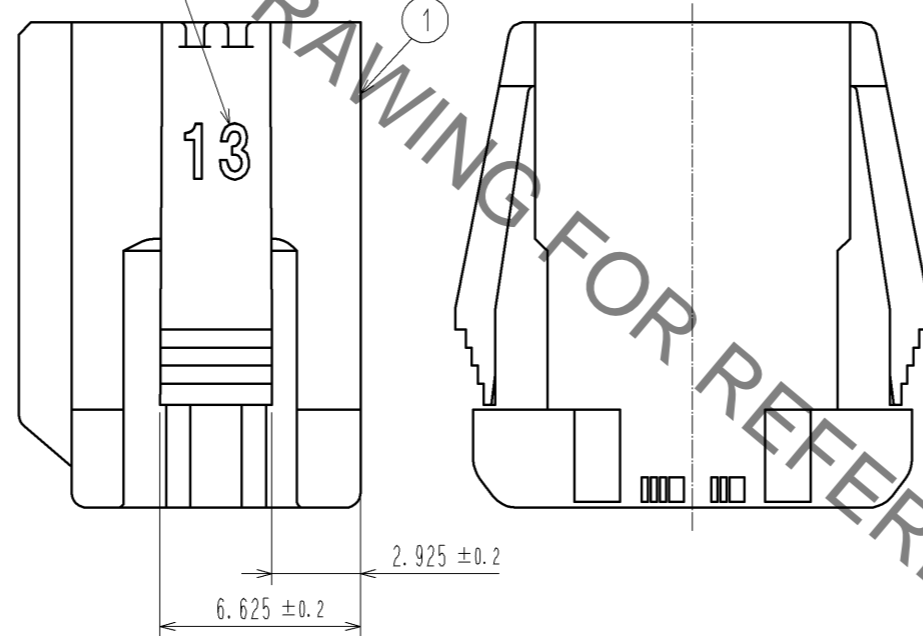

3 4 RECOMMENDED PANEL CUTOUT DIMENSION

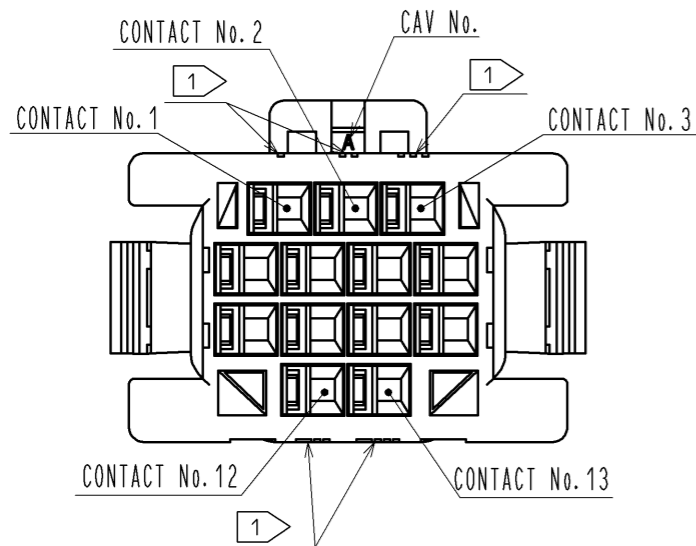
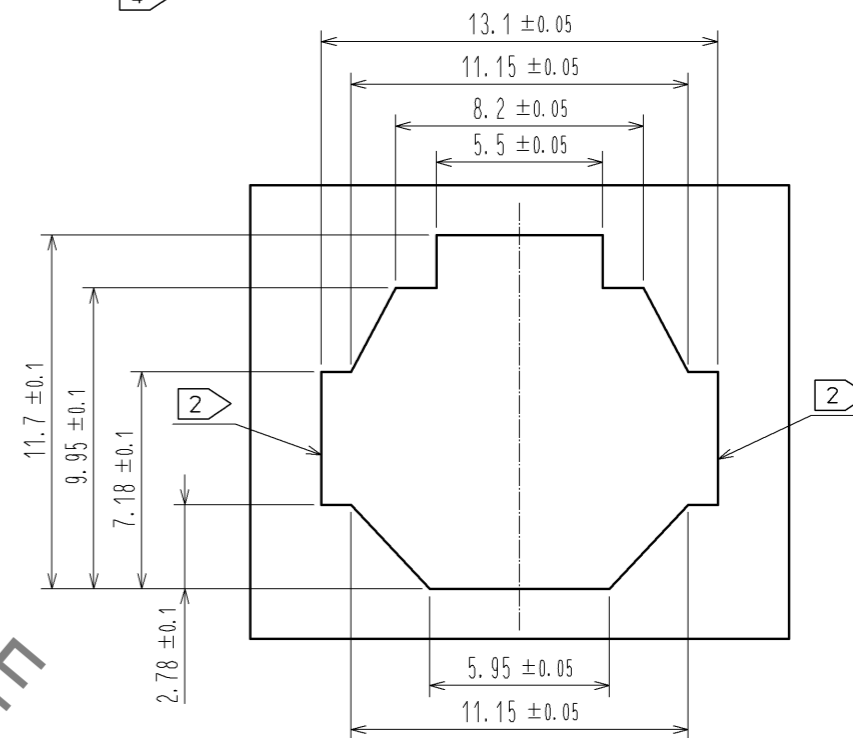

1 FIGURE-1 CONTACT No. MARKING (10:1)

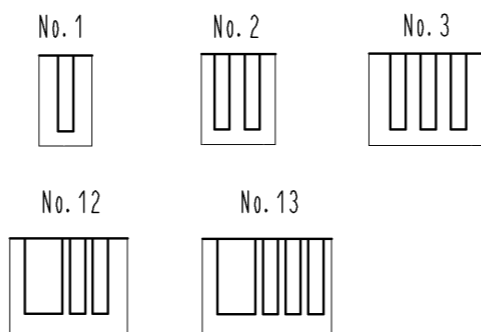

- NOTE. 1 MARKINGS AT THE INDICATED POSITIONS ARE CONTACT NO. MARKING. AND SHAPES ARE SHOWN IN FIGURE-1.  
 2 PLEASE USE THE NON-RADIUS SIDE FOR THE PANEL HOOKING AREA.  
 3 APPLICABLE PANEL THICKENING IS 2.3 TO 0.5mm.  
 4 CONSULT HIROSE FOR THE OTHER PANEL CUTOUT DESIGNS THAN THE RECOMMENDED ONE.  
 5. PER PACK : 100 PIECES.  
 6. THE DIMENSIONS IN PARENTHESIS ARE FOR REFERENCE.  
 7 THIS FIGURE SHOWS THE MATED CONDITION WITH DF62B-13S-2.2C.

NO.	MATERIAL	FINISH	REMARKS	NO.	MATERIAL	FINISH	REMARKS	
				1	PBT		UL94V-0(WHITE)	
UNITS	mm	SCALE	4 : 1	COUNT	DESCRIPTION OF REVISIONS	DESIGNED	CHECKED	DATE
<b>HRS</b> HIROSE ELECTRIC CO., LTD.				APPROVED : KI. AKIYAMA	14. 03. 10	DRAWING NO. EDC3-349141-01		
				CHECED : HK. UMEHARA	14. 03. 10	PART NO. DF62P-13EP-2.2C(10)		
				DESIGNED : TS. KUMAZAWA	14. 03. 07	CODE NO. CL544-0549-8-10		
				DRAWN : TS. KUMAZAWA	14. 03. 07	DATE 1/1		