

DWG NO C-5-1579008-8

THIS DRAWING IS A CONTROLLED DOCUMENT FOR AMP INCORPORATED. IT IS SUBJECT TO CHANGE AND THE CONTROLLING ENGINEERING ORGANIZATION SHOULD BE CONTACTED FOR THE LATEST REVISION.

DIESES ZEICHNUNGSDOKUMENT WIRD DURCH AMP INCORPORATED KONTROLLIERT. ÄNDERUNGEN, DIE DEM TECHNISCHEN FORTSCHRITT DIENEN, SIND VORBEHALTEN. DEN JEWEILS LETZTUELTIGEN ANBEREICHERSSTAND ERFAHREN SIE AUF ANFRAGE.

THIS INFORMATION IS CONFIDENTIAL AND IS DISCLOSED TO YOU ON THE CONDITION THAT NO FURTHER DISCLOSURE IS MADE BY YOU TO OTHER THAN THE PERSONS SPECIFIED IN THE AUTHORIZATION FROM AMP INCORPORATED. - 63225 LANGEN

PASSMASS	ABMASS

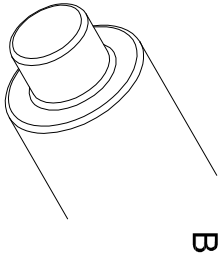
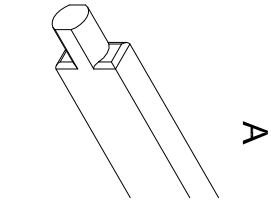
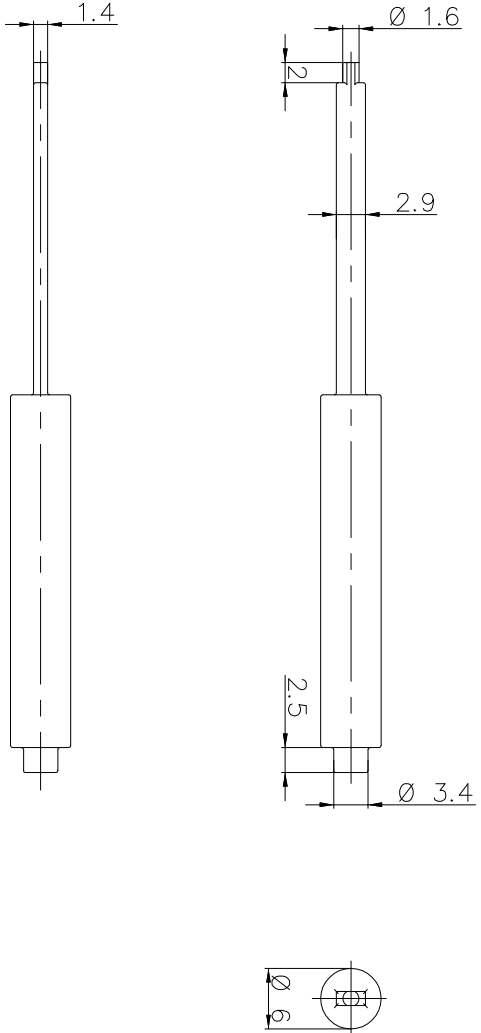

APPLICATION RANGE / Anwendungsbereich :

HOUSING MCP: 1801286, 180326  
SEAL: 928904, 928905, 928906

gewicht / Weight 0,000kg

**FREIWAHLSTÜLLE ERGÄNZEN NACH DIN 7168 C WERTE (IN mm)**  
1) ABWEICHEND VON DIN 7168 B) LÄNGE DES KORZIEREN SONENWELLS

NENNMASS	ÜBER	0	5	3	6	30	120	400	1000
BEREICH 1) B15	3	6	30	120	400	1000			
BEREICH 1) B15	3	6	30	120	400	1000			
BEREICH 1) B15	3	6	30	120	400	1000			

**ABMASS**

MASS	MITTEL	±0.1	±0.1	±0.2	±0.3	±0.5	±0.8
FAKTOREN 1) FAKTOR 1	±1	±1	±1	±2	±4	±4	±4
FAKTOREN 2) FAKTOR 2	±1	±1	±1	±2	±4	±4	±4
FAKTOREN 3) FAKTOR 3	±1	±1	±1	±2	±4	±4	±4

**WINKELABMÄSS** 1) 2) 3) 4) 5) 6) 7) 8) 9) 10) 11) 12) 13) 14) 15)

**GENERAL TOLERANCES ACC. TO DIN 7168**

MASS	MITTEL	±0.1	±0.1	±0.2	±0.3	±0.5	±0.8
FAKTOREN 1) FAKTOR 1	±1	±1	±1	±2	±4	±4	±4
FAKTOREN 2) FAKTOR 2	±1	±1	±1	±2	±4	±4	±4
FAKTOREN 3) FAKTOR 3	±1	±1	±1	±2	±4	±4	±4

**TOLERANCES UNLESS INDICATED BY DIMENSIONS**

DEGREE	FA	FB	FC	FD	FE	FF	FG	FH	FI	FJ	FK	FL	FM	FN	FO	FP	FQ	FR	FS	FT	FU	FV	FW	FX	FY	FZ
FAKTOREN 1) FAKTOR 1	±1	±1	±1	±1	±1	±1	±1	±1	±1	±1	±1	±1	±1	±1	±1	±1	±1	±1	±1	±1	±1	±1	±1	±1	±1	±1
FAKTOREN 2) FAKTOR 2	±1	±1	±1	±1	±1	±1	±1	±1	±1	±1	±1	±1	±1	±1	±1	±1	±1	±1	±1	±1	±1	±1	±1	±1	±1	±1
FAKTOREN 3) FAKTOR 3	±1	±1	±1	±1	±1	±1	±1	±1	±1	±1	±1	±1	±1	±1	±1	±1	±1	±1	±1	±1	±1	±1	±1	±1	±1	±1

REVISION RECORD	DATE	BY	APPROVED	REVISION RECORD

**FINISH**

REVISION RECORD	DATE	BY	APPROVED	REVISION RECORD

DATE	BY	APPROVED	REVISION RECORD	DATE	BY	APPROVED	REVISION RECORD	DATE	BY	APPROVED	REVISION RECORD
05.08.2008	S. Samst ag			05.08.2008	S. Samst ag			05.08.2008	S. Samst ag		
05.08.2008	G. Stegmay er			05.08.2008	G. Stegmay er			05.08.2008	G. Stegmay er		
05.08.2008	G. Stegmay er			05.08.2008	G. Stegmay er			05.08.2008	G. Stegmay er		

AMP 3306-7 REV 23ETB95 8 7 6 5 4 3 2 1

PROJECT NO.:      USED DN

A

B

C

D