

REVISION			
REV	DESCRIPTION	DATE	APPROVED
B	REVISED RELEASE PER DCR# C050426	May/12/05	M.HIGGY
E	REVISED PER ECO-19-012533	Aug/13/19	A.SOLIS

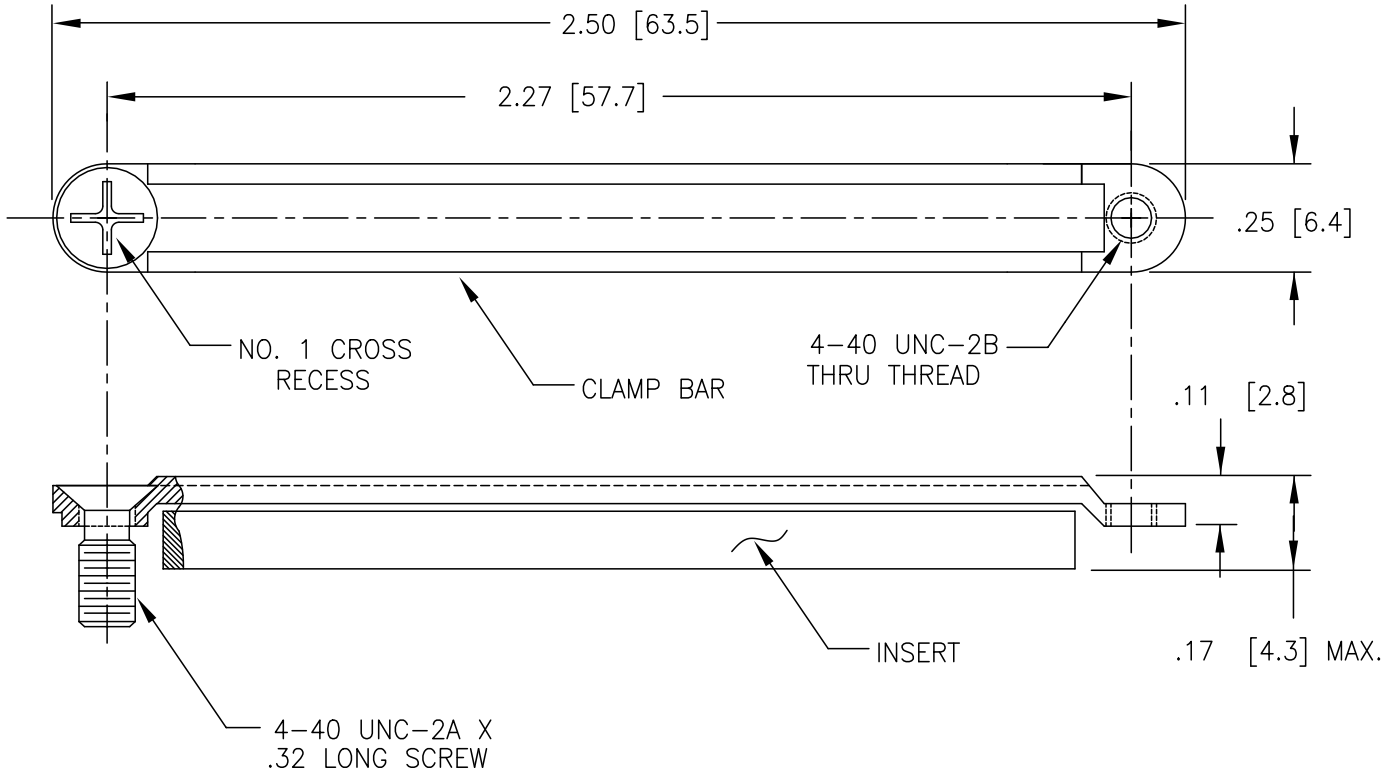

NOTES:

1. THIS PART IS USED WITH MTC PLUG AND RECEPTACLE SHELLS.  
(TWO REQUIRED PER CONNECTOR ASSEMBLY)
2. MATERIALS: CLAMP BAR: STAINLESS STEEL, CADMIUM PLATED  
INSERT: FLUROSILICONE ELASTOMER  
SCREW: STAINLESS STEEL, CADMIUM PLATED

**3** WEIGHT: 0.029 Lbs. [ 13.00 gm.] MAXIMUM/PAIRS.

SPECIFICATION CONTROL DRAWING

© 2005 Tyco Electronics Corporation.  
All rights reserved

ITEM	QTY.	PART NO	DWG OR SPEC NO	DESCRIPTION	
PARTS LIST					
UNLESS OTHERWISE SPECIFIED DIMENSIONS ARE INCHES. METRIC DIMENSIONS ARE IN BRACKETS.  DECIMAL TOLERANCES .XXX ± .005 [ .13 mm] .XX ± .01 [ .25 mm] .X ± [ mm]  ANGLE TOLERANCE .X ±  WEIGHT <b>3</b>		DRAWN <b>ZS.ORBAN</b> DATE May/6/05		TYCO ELECTRONICS 300 Constitution Drive Menlo Park, CA. 94025 USA	
		APPROVED <b>M.HIGGY</b> DATE May/6/05	TITLE ASSEMBLY, 2 INCH CLAMP, CABLE CADMIUM PLATED MTC SERIES		
		MATERIAL	SIZE A	CAGE CODE: 06090	DWG. NO. CHA-0092
		FINISH	THIRD ANGLE PROJECTION 	DO NOT SCALE THIS DRAWING	SHEET 1 OF 1
CAD FILE		C050426.DWG			