

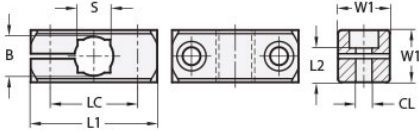

MT20-CC1W-M6-AN

Ruland One-Way Connector Clamp, Thru Hole 20mm, L 50mm, Black Anodized Aluminum



Description

Ruland MT20-CC1W-M6-AN is a one-way base connector with a 50mm base diameter, 20mm round thru holes, 16mm square thru hole, and M6 clamp screw. It is designed to fit with Ruland tubes that begin with M6. MT20-CC1W-M6-AN is aluminum with a black anodized finish and screws are 304 stainless steel for added corrosion resistance when compared to unplated types. This one-way base connector is typically used as a base in support structures for mounting sensors, screens, reflectors, plexiglass machine guards, and other industrial components. It can be permanently installed on extruded aluminum frames, sheet metal, and other surfaces using M6 hardware or the user can opt for portability by using MAGNET-57-36 magnetic base. MT20-CC1W-M6-AN is a cost effective option when compared to two-way bases for users that only require a tube in one orientation. MT20-ALK-M6-30 adjustable clamping handles can be used in place of standard hardware if rapid fine repositioning of the tube is required. MT20-CC1W-M6-AN is manufactured by Otto Ganter, inventoried by Ruland, and RoHS3 compliant.

Product Specifications

Thru Hole Diameter B	20 mm	Thru Hole Tolerance	+0.13/-0 mm
Square Thru Hole S	16 mm	Center To Center LC	36 mm
Width & Height W1	25 mm	Overall Length L1	50 mm
Mounting Screw SC	M6	Clamp Screw CL	M6
Screw Length L2	14 mm	Weight (lbs)	0.114600
Material Specification	Anodized Aluminum	Manufacturer	JW Winco/ Otto Ganter
UPC	634529231340	Country of Origin	Germany
Tariff Code	7609.00.0000	UNSPC	31162908