

4

3

2

1

THIS DRAWING IS UNPUBLISHED.

RELEASED FOR PUBLICATION



---

REVISIONS

© COPYRIGHT - By -

ALL RIGHTS RESERVED.

P	LTR	DESCRIPTION	DATE	DWN	APVD
	M3	REVISED PER ECO-11-004820	11MAR11	RK	HMR
	M4	REVISED PER ECO-17-014338	20APR2018	RS	DR

<b>AMP</b> WIRE RANGE	 Listed FILE E13288	 LR7189 Certified
16-14 AWG SOLID OR STRANDED	16-14 AWG SOLID OR STRANDED	16-14 AWG SOLID OR STRANDED

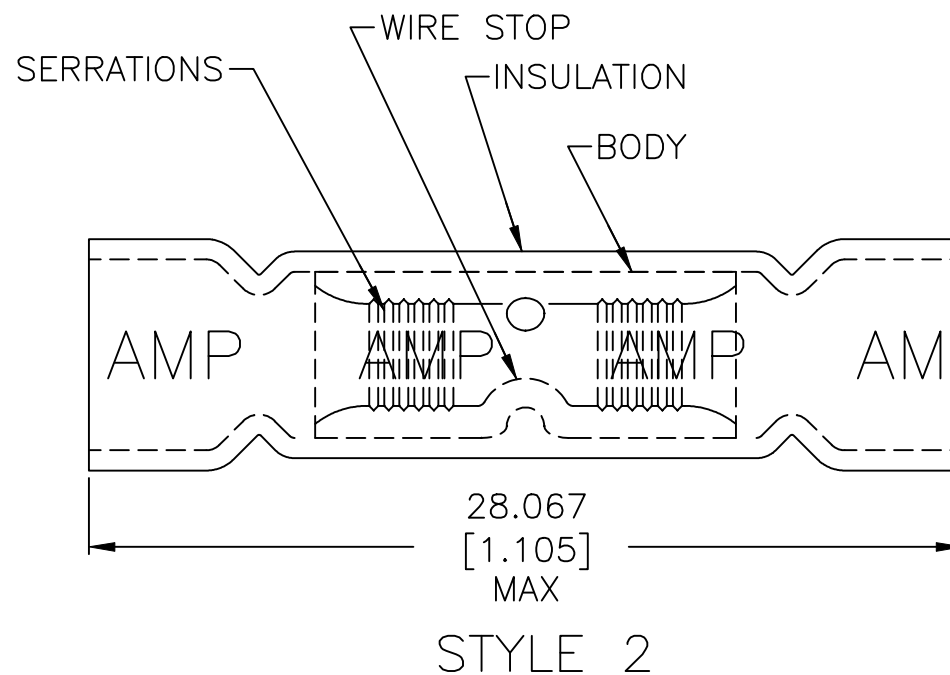
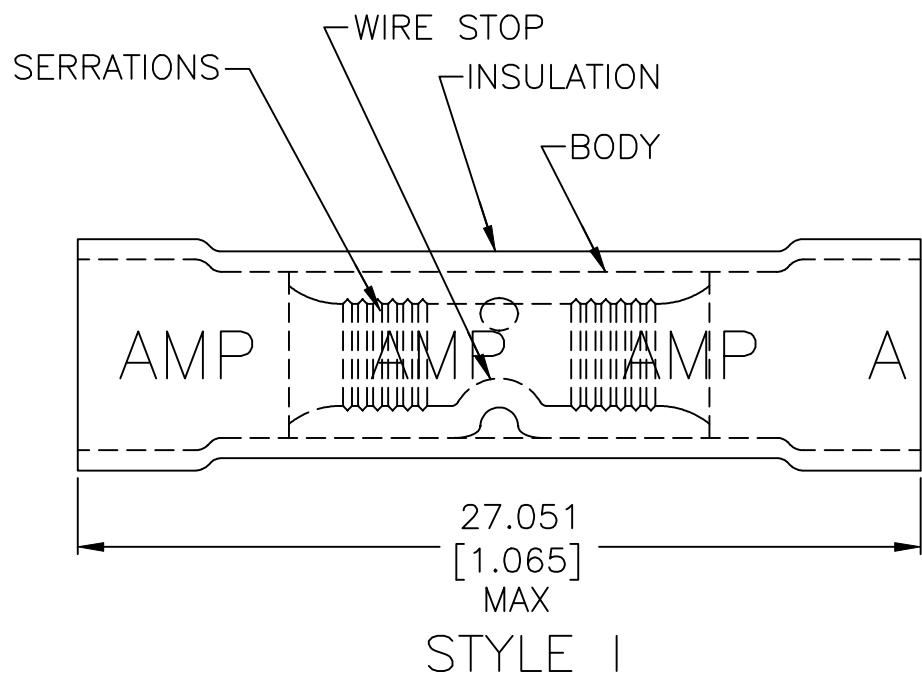

- 1 WIRE INSUL DIA,  
2.921-4.318[.115-.170]
- 2 NOTE DELETED

I	50	LOOSE PIECE, BAG	8-34071-5
I	5	LOOSE PIECE, BLS	8-34071-4
I	100	LOOSE PIECE, BOX	8-34071-1
2	2500	ON TAPE, REEL	2-34071-3
2	1000	LOOSE PIECE	2-34071-2
I	2500	ON TAPE, REEL	2-34071-1
I	1000	LOOSE PIECE	34071
STYLE	QTY	PACKAGE TYPE	PART NO

AMP INCORPORATED  
CUSTOMER SERVICE SYSTEMS

MAX RECOMMENDED OPERATING  
TEMPERATURE:

105°C [221° F]

VOLTAGE RATING:  
600V MAX  
(1000V FIXTURE OR SIGN)

CIRCULAR MIL AREA:  
1.04-2.62mm<sup>2</sup>[2,050-5,180]  
SOLID OR STRANDED

THIS DRAWING IS A CONTROLLED DOCUMENT.

DIMENSIONS:  
mm [INCHES]

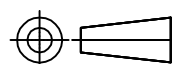

TOLERANCES UNLESS  
OTHERWISE SPECIFIED:

0 PLC	± -
1 PLC	± -
2 PLC	± -
3 PLC	± 0.127[.005]
4 PLC	± -
ANGLES	± -

MATERIAL  
BODY, CU ASTM B 152  
INSULATION: PVC

FINISH  
BODY:TIN PLATE ASTM B545  
INSULATION: COLOR-BLUE

DWN M ELLIS 19JUL95  
CHK C PRESNELL 19JUL95  
APVD S BORTNER 19JUL95  
PRODUCT SPEC  
UL486A-B  
APPLICATION SPEC  
114-2161  
WEIGHT  
CUSTOMER DRAWING

**STE** TE Connectivity Ltd.

SPLICE, BUTT, PLASTI-GRIP  
WIRE SIZE 16-14 AWG

SIZE	CAGE CODE	DRAWING NO	RESTRICTED TO
A3	00779	C=34071	-
SCALE	SHEET	REV	
4:1	1 OF 1	M4	

FOR ADDITIONAL  
PRODUCT INFORMATION OR  
COPIES OF DRAWINGS  
AND TECHNICAL DOCUMENTS

PRODUCT INFORMATION CENTER  
1-800-522-6752

FOR APPLICATION  
TOOLING INFORMATION

TOOLING ASSISTANCE CENTER  
1-800-722-1111

FOR ORDER ENTRY

1-800-526-5142

THIS DRAWING IS A CONTROLLED DOCUMENT FOR  
AMP INCORPORATED. IT IS SUBJECT TO CHANGE  
AND THE CONTROLLING ENGINEERING ORGANIZATION  
SHOULD BE CONTACTED FOR THE LATEST REVISION.