

May.1.2023 Copyright 2023 HIROSE ELECTRIC CO., LTD. All Rights Reserved.  
In case of consideration for using Automotive equipment / device which demand high reliability, kindly contact our sales window correspondents.

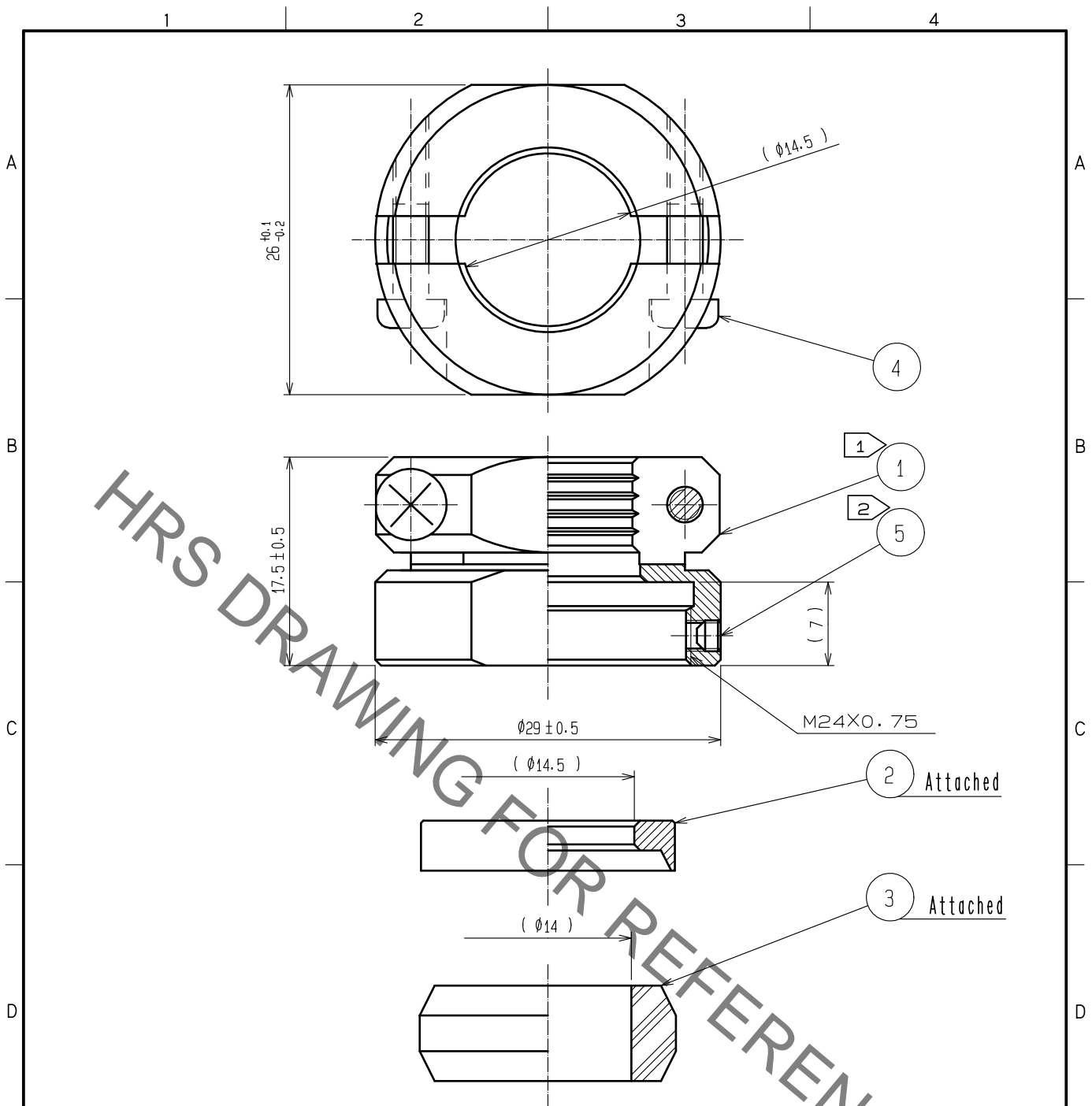

- Notes
- ① The recommended tightening torque of ref.No. ① shall be 2 to 3N · m. LOCTITE 263, HENKEL JAPAN or equevalent is recommended to prevent ref. No. ① from loosening.
  - ② Across flats of hexagon hole of ref. No. ⑤ to be 1.27. The recommended tightening torque of ref.No. ⑤ shall be 0.3 to 0.4N · m.
  - ③ The cable pull and twisting strength (, waterproof tightness) and other characteristics may differ, depending on the cable structure, please confirm before the use.

3	Chloroprene rubber	(Black)					
2	Brass	Nickel plating	5	Stainless steel	JIS B 1177 Hexagon socket set screw M2.6x0.45x2		
1	Brass	Nickel plating	4	Brass	Nickel plating JIS B 1111 Pan head machine screw M3x0.5x8		
NO.	MATERIAL	FINISH	REMARKS	NO.	MATERIAL	FINISH	REMARKS

UNITS mm		SCALE 2 : 1	COUNT 1	DESCRIPTION OF REVISIONS DIS-C-00007459	DESIGNED TY. SUZUKI	CHECKED HY. KOBAYASHI	DATE 20211208
HIROSE ELECTRIC CO., LTD.				APPROVED :HY. KOBAYASHI 20180222	DRAWING NO. EDC-112372-31-00		
				CHECKED :HY. KOBAYASHI 20180222	PART NO. RM24WTP-CP14(31)		
				DESIGNED :HY. KISHI 20180222	CODE NO. CL0109-1851-9-31		
				DRAWN :MK. INOUE 20180208	1/1		