

THIS COPY IS PROVIDED ON A RESTRICTED BASIS AND IS NOT TO BE USED IN ANY WAY DETRIMENTAL TO THE INTERESTS OF PANDUIT CORP.

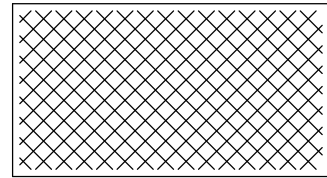

CLEANING PAD (QTY. 1)

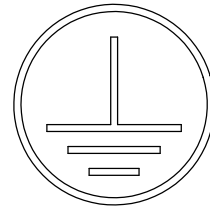

UNIVERSAL GROUNDING STICKER (QTY. 2)



5cc TUBE ANTI-OXIDANT PASTE (QTY. 1)

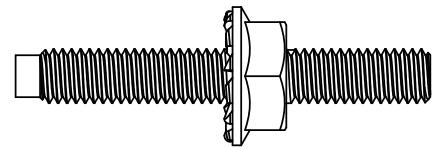

#12-24 & M6 BONDING STUD (QTY. 8 OF EACH)

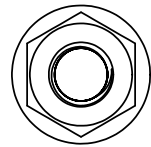

#12-24 & M6 BONDING NUT (QTY. 16 OF EACH)



LISTED
GROUNDING AND BONDING EQUIPMENT



CERTIFIED

NOTES:

1. RETRO-FIT CABINET GROUNDING KIT
PART NUMBERS: CGR630U
2. PACKAGING: 1 KIT PER BOX
3. DIMENSIONS IN PARENTHESIS ARE MILLIMETERS.
4. ALL COMPONENTS THAT MAKE UP THIS KIT
ARE ROHS COMPLIANT.

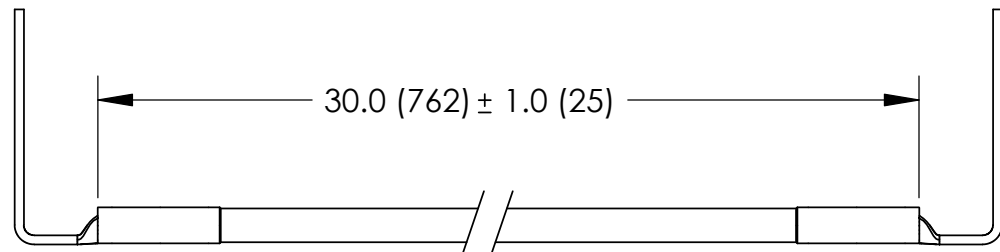

FACTORY CRIMPED #6 AWG FRONT TO BACK RAIL JUMPER GREEN/YELLOW INSULATION (QTY. 2)

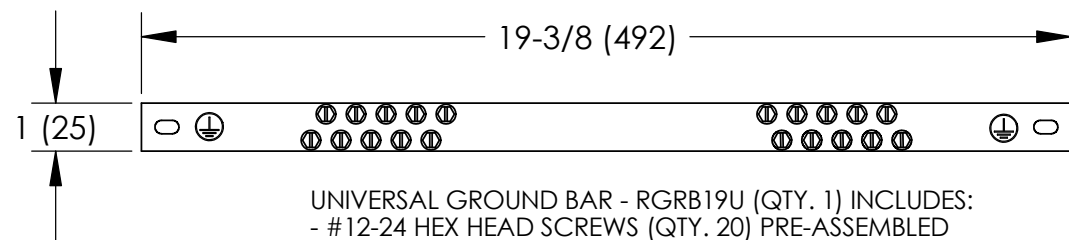

C41630_00

PANDUIT CORP. TINLEY PARK, ILLINOIS

RETRO-FIT CABINET GROUNDING KITS
(CGR630U)
CUSTOMER DRAWING

UNLESS OTHERWISE SPECIFIED
DIMENSIONAL TOLERANCES ARE:
(.X) ± (.XXX) ±
(.XX) ± ANGLES ±

UNLESS OTHERWISE SPECIFIED,
ALL DIMENSIONS ARE GIVEN IN
INCHES, THIRD ANGLE PROJECTION

DRAWN BY
JHNU

MAT'L:

SCALE NONE

00 1/06 JHNU JMAR DRAWING RELEASED PC00276

DATE 1/06

DRAWING NO / CAD FILE DWG

REV DATE BY CHK DESCRIPTION ECN PM CUST

CHK'D

C41630 B SIZE