

SIGN	DATE	DESCRIPTION	APPROVER

THIS IS CAD DRAWING, DO NOT REVISE MANUALLY!!!

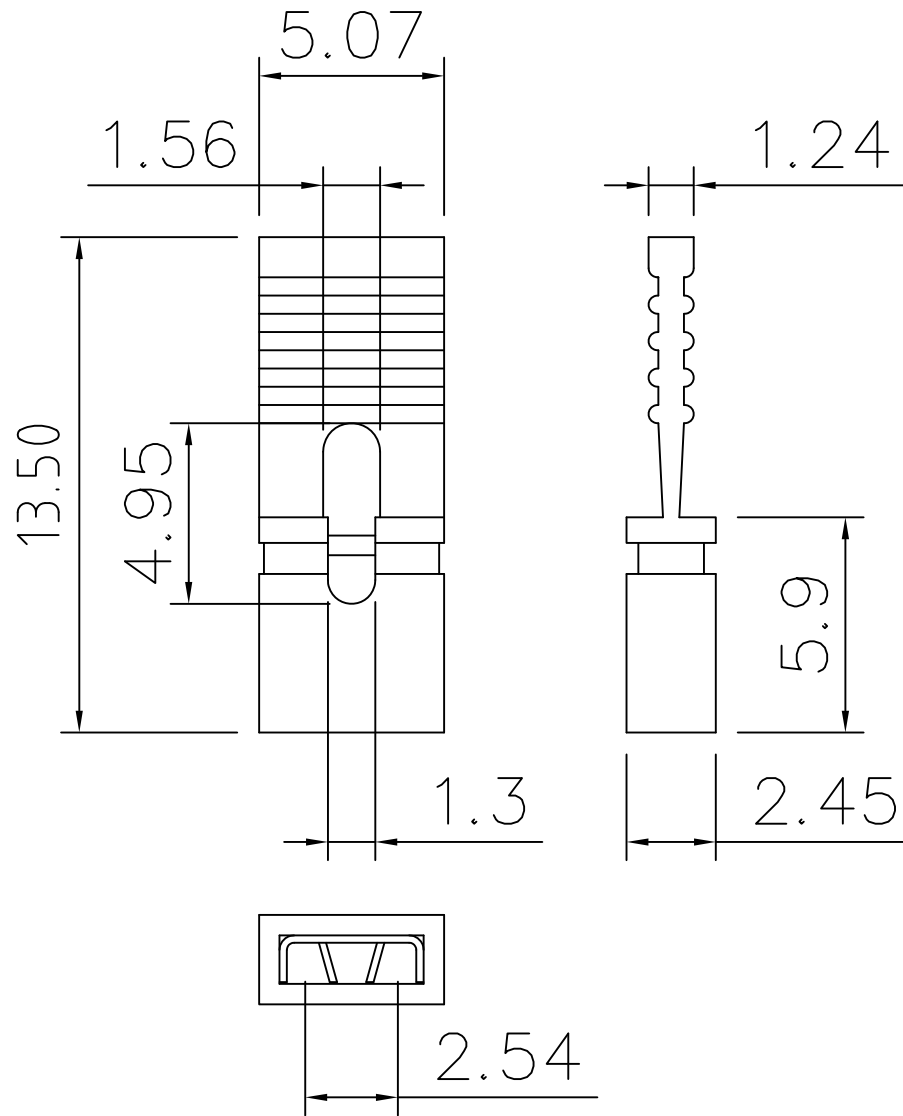

SPECIFICATIONS

Current: 3A
Voltage: 250V AC(r.m.s.)
Temperature Range: -40°C ~ +105°C
Contact Resistance: <20mΩ
Insulation Resistance: >1000MΩ
Withstanding Voltage: 1000V AC/minute
Material: Glass Filled Polyester
Contact: Phosphor Bronze
Flammability: UL 94V-0

RoHS Compliant

PART NUMBER:

COLOR

- 0 - Black
- 1 - Red
- 3 - Blue
- other colors available, may require MOQ

EDJ4GX

THESE DRAWINGS AND SPECIFICATIONS ARE THE PROPERTY OF ON-SHORE TECHNOLOGY, INC. AND SHALL NOT BE REPRODUCED, COPIED OR USED IN ANY MANNER WITHOUT THE PRIOR WRITTEN CONSENT OF ON-SHORE TECHNOLOGY, INC.



TITLE		EDJ4 Series - 2.54mm shunt/jumper Open Top, gold flash			
PART NO.	EDJ4GX	DWG NO.	EDJ4GX.DWG		
APPROVED	CHECKED	DESIGNED	DRAWN	Tolerance	
	Sandy 2006.03.07	Marvin 2006.03.07	Marvin 2006.03.07	UNIT: mm	.XX ±0.38
				SCALE: NONE	.XXX ±0.25
				REV: A	.XXX ±0.13
				SHEET: 01/01	X* ±1°