

APPROVED: _____
 DATE: _____ TITLE: _____

Rev	AWO #	Description	Date	Appr
-		RELEASED	3/23/21	
A		UPDATE TITLE.	6/10/21	
B		UPDATE LABEL	7/19/21	WX/AC
C		UPDATE DESCRIPTION	4/11/23	SS

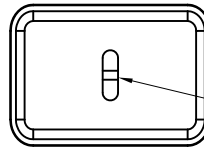

USB, TYPE C FEMALE

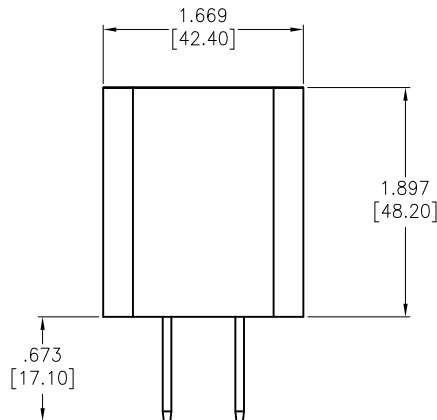
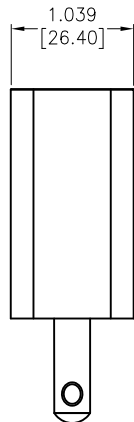

.673 [17.10]

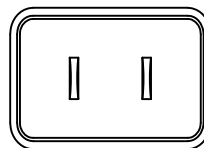

SPECIFICATIONS:

Material:

Case, cover & Chassis: PPHOX, rated UL94V-1, Color: white

AC Blades: Brass, Nickel plated

Electrical:

Input:

Voltage: 100Vac to 240Vac

Current: 0.5A Max. @ 100Vac input & max load

Frequency: 50Hz / 60Hz

Output Power:

Total Output: 18 Watts max.

PD Output: 5Vdc @ 3A

9Vdc @ 2A

12Vdc @ 1.5A

Load Regulation: ± 7%

Line Regulation: ± 7%

(Switching power supply adjust the PD output to match device connected)

Insulation Resistance: 50 Mohms min @ 500VDC

Dielectric withstanding voltage (Hi-pot): 3,000V AC For 1 Minute

Leakage Current: 0.25mA max. @ 240V AC/50Hz

Temperature Rating:

Operating Temperature: -10°C to +40°C

Storage Temperature: -20°C to +85°C

Environmental:

Lead free, RoHS compliant.

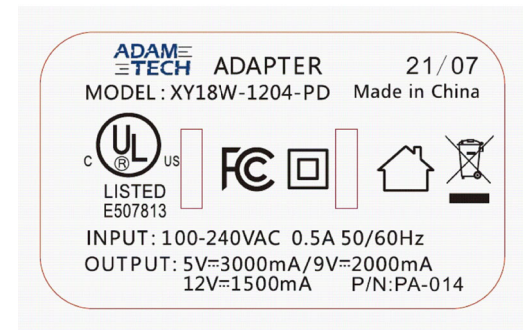

UNLESS OTHERWISE SPECIFIED ALL DIMENSIONS ARE INCHES [MM]. TOLERANCES: EXCEPT AS NOTED

INCHES		HOLES	
.x	± .10	∅x	± .10
.xx	± .020	∅xx	± .015
.xxx	± .015	∅xxx	± .010

DRAWN	WX	3/23/21
CHECKED	AC	3/23/21
APPROVED		

THIS DRAWING CONTAINS INFORMATION THAT IS PROPRIETARY AND SHOULD NOT BE USED WITHOUT PRIOR WRITTEN PERMISSION FROM ADAM TECH

ADAM TECH

909 Rahway Avenue,
 Union, NJ 07083
 Phone: 908-687-5000
 Fax: 908-687-5710

TITLE
 AC POWER ADAPTER, NEMA 1-15 TO USB TYPE C
 18W PD OUTPUT, COLOR WHITE

SIZE	PART NO.	REV.
X	PA-014	C

REF: _____ SCALE: NTS SHEET 1 OF 1